





PROPOSED CONDITIONS LEGEND

-  PROPOSED FULL DEPTH PAVEMENT
SEE TYPICAL SECTION
-  PROPOSED RESURFACING
-  PROPOSED SIDEWALK
SEE TYPICAL CROSS SECTION
-  PROPOSED CONCRETE DRIVEWAY
SEE TYPICAL CROSS SECTION
-  B-6.12 COMB. CONC. CURB & GUTTER
-  B-6.24 COMB. CONC. CURB & GUTTER

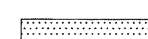
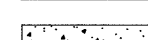
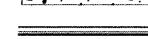

PERRY STREET

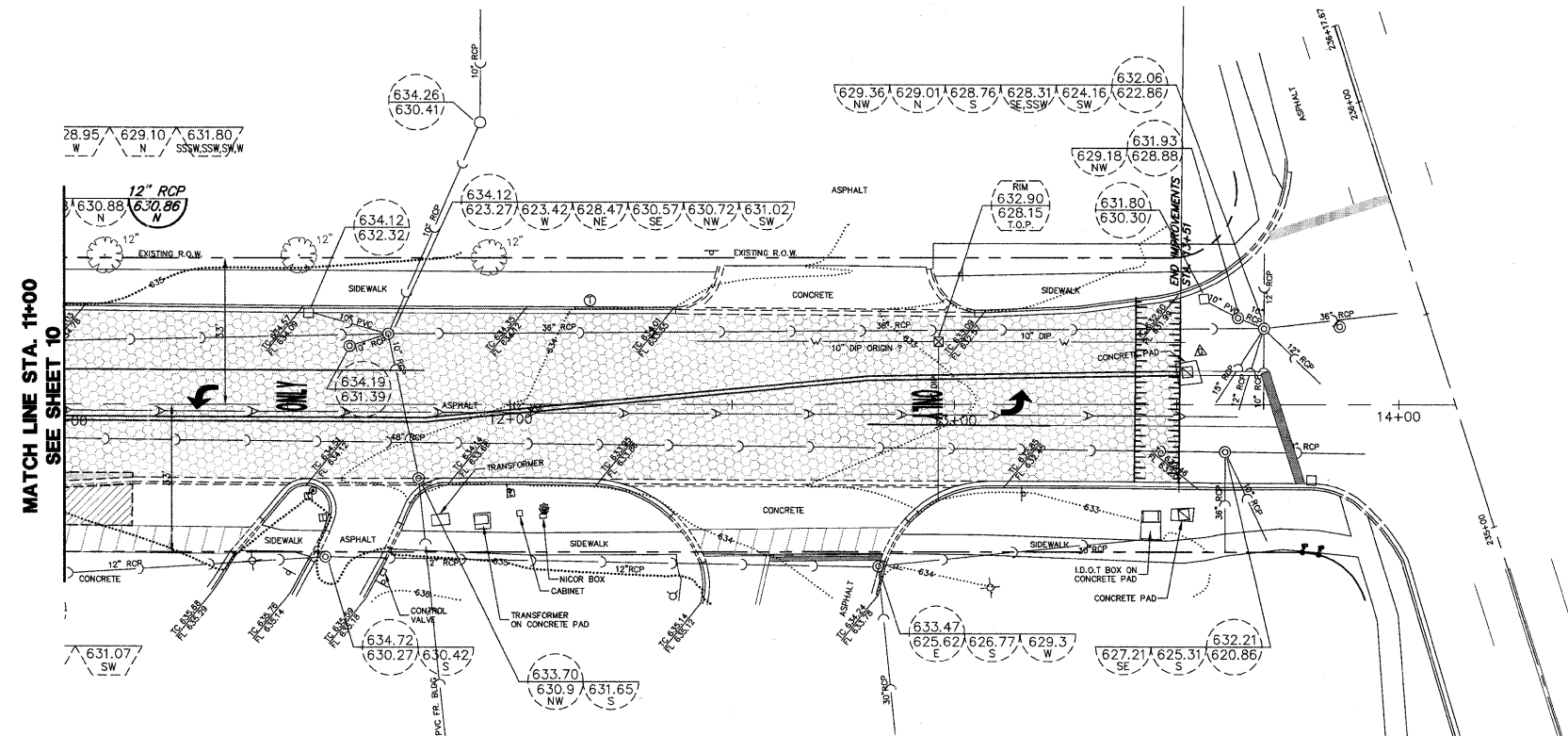
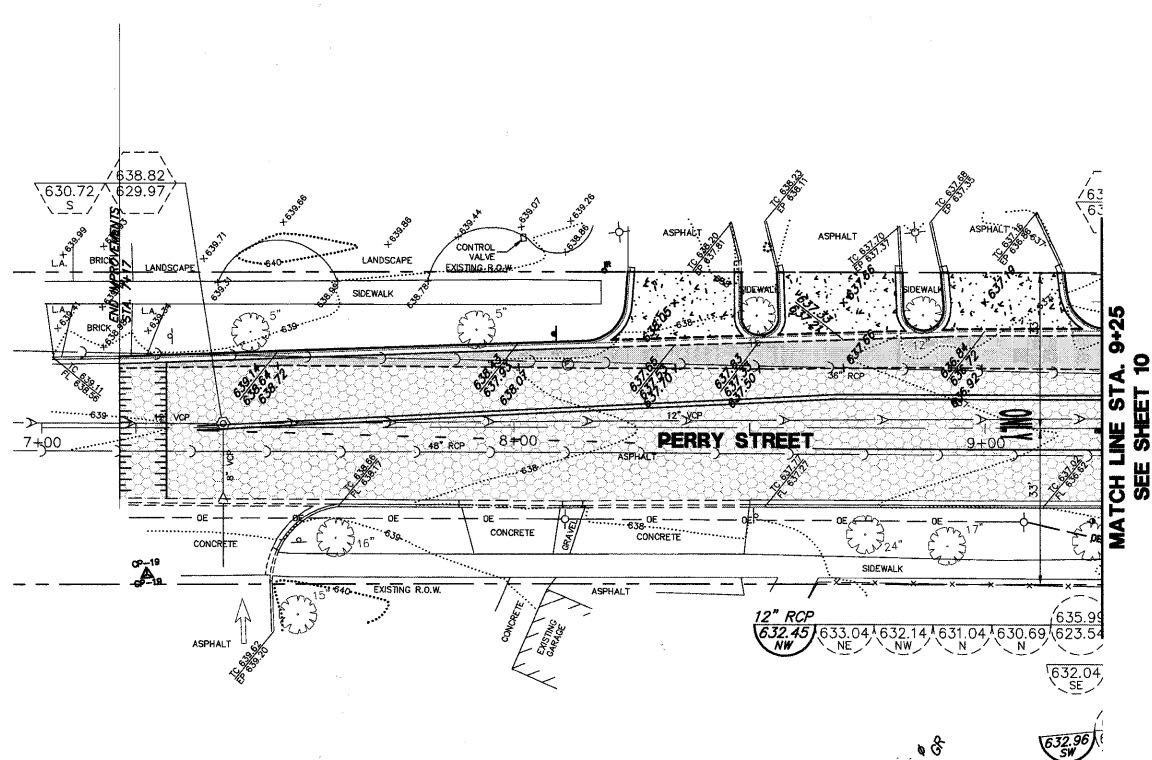
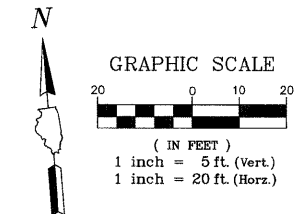
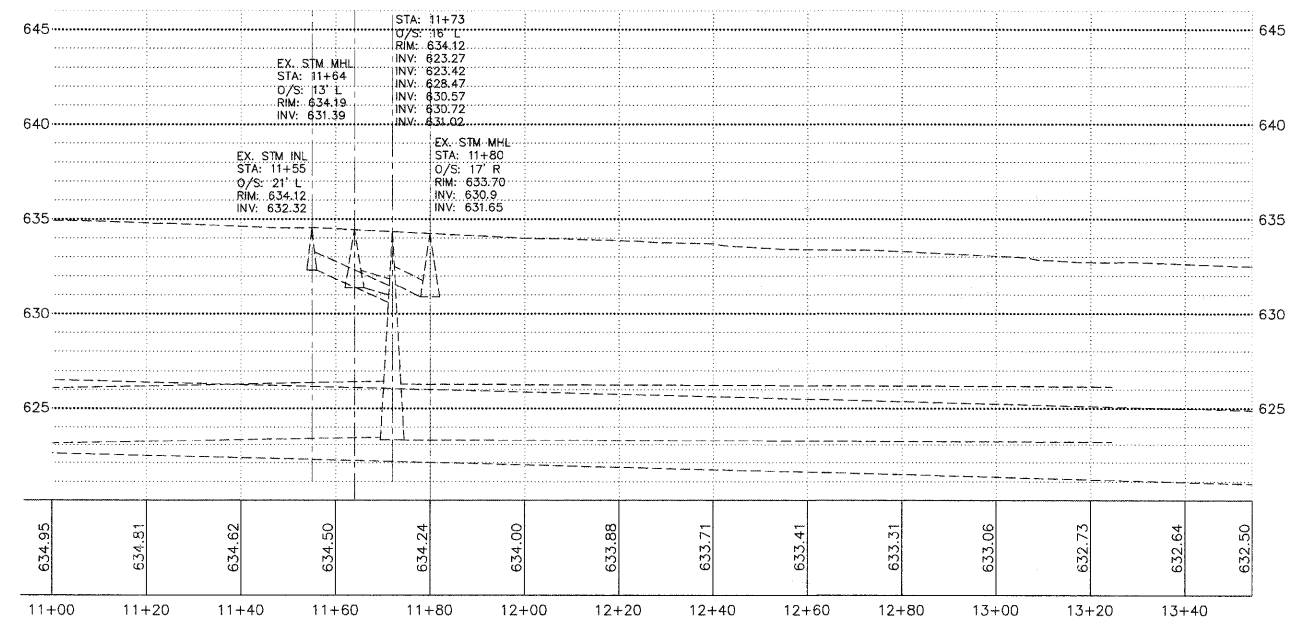
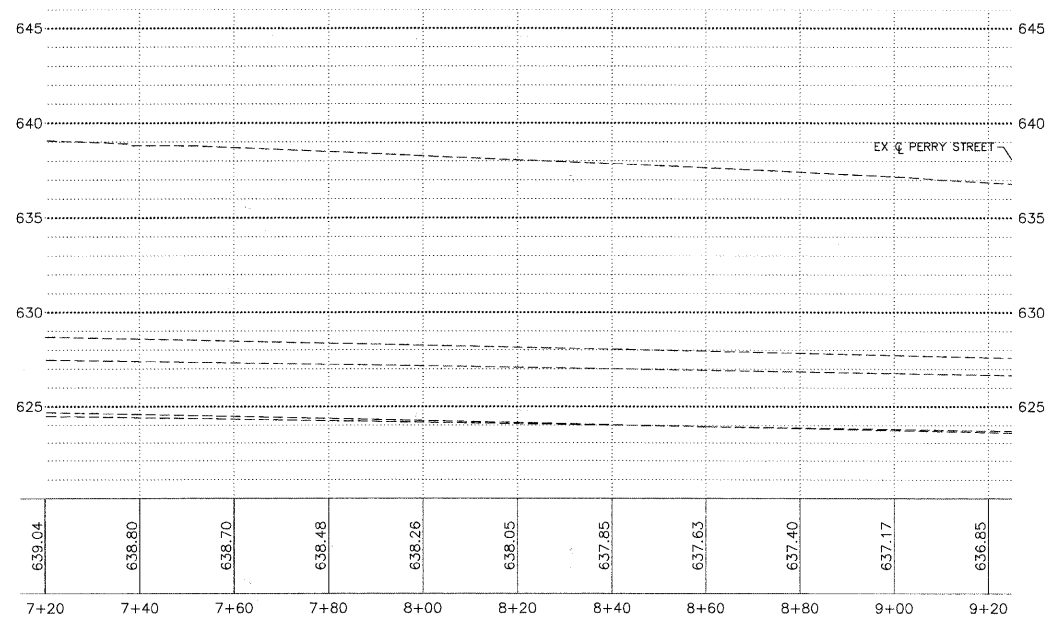

FILE NAME = 3850-805-PR1.dwg	USER NAME = ZACH WALLSTEN	DESIGNED - CAD	REVISED -	CITY OF DES PLAINES PROPOSED ROADWAY WIDENING AND TRAFFIC SIGNAL INSTALLATION	PLAN & PROFILE (PERRY STREET)	F&P RTE 330	SECTION 10-00213-00-CH	COUNTY COOK	TOTAL SHEETS 47	SHEET NO. 11	GHA #3850.805 CONTRACT # 63616 ILLINOIS FED. AID PROJECT	
	PLOT SCALE = 1/01	DRAWN - CAD	REVISED -			SCALE: 1"=20'	SHEET NO. OF SHEETS	STA. 7+00	TO STA. 11+50			
	PLOT DATE = 8/23/2011	CHECKED - BLS	REVISED -									
		DATE - 8/23/2011	REVISED -									