

SEE SHEET 34 FOR 75TH STREET

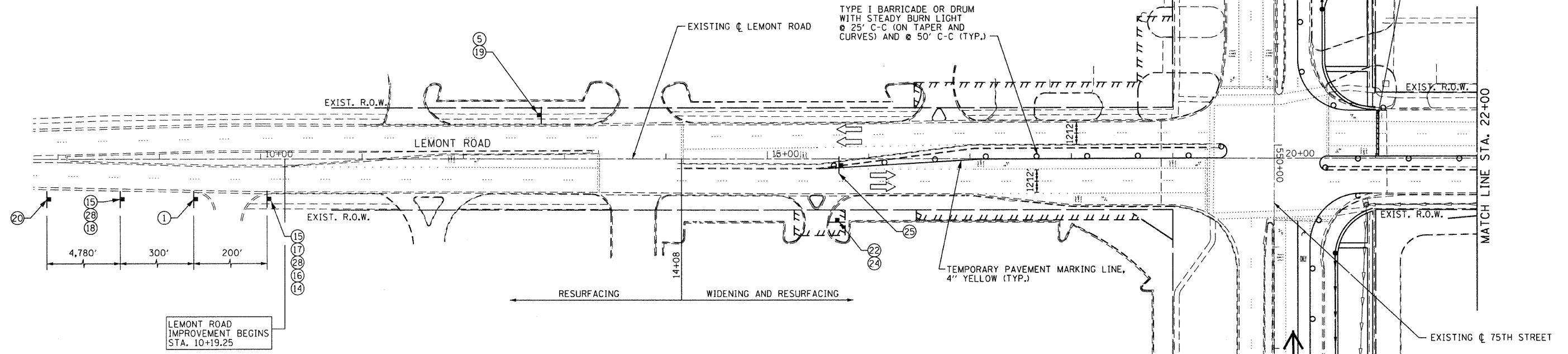

LEMONT ROAD IMPROVEMENT BEGINS STA. 10+19.25

SEE SHEET 34 FOR 75TH STREET

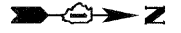
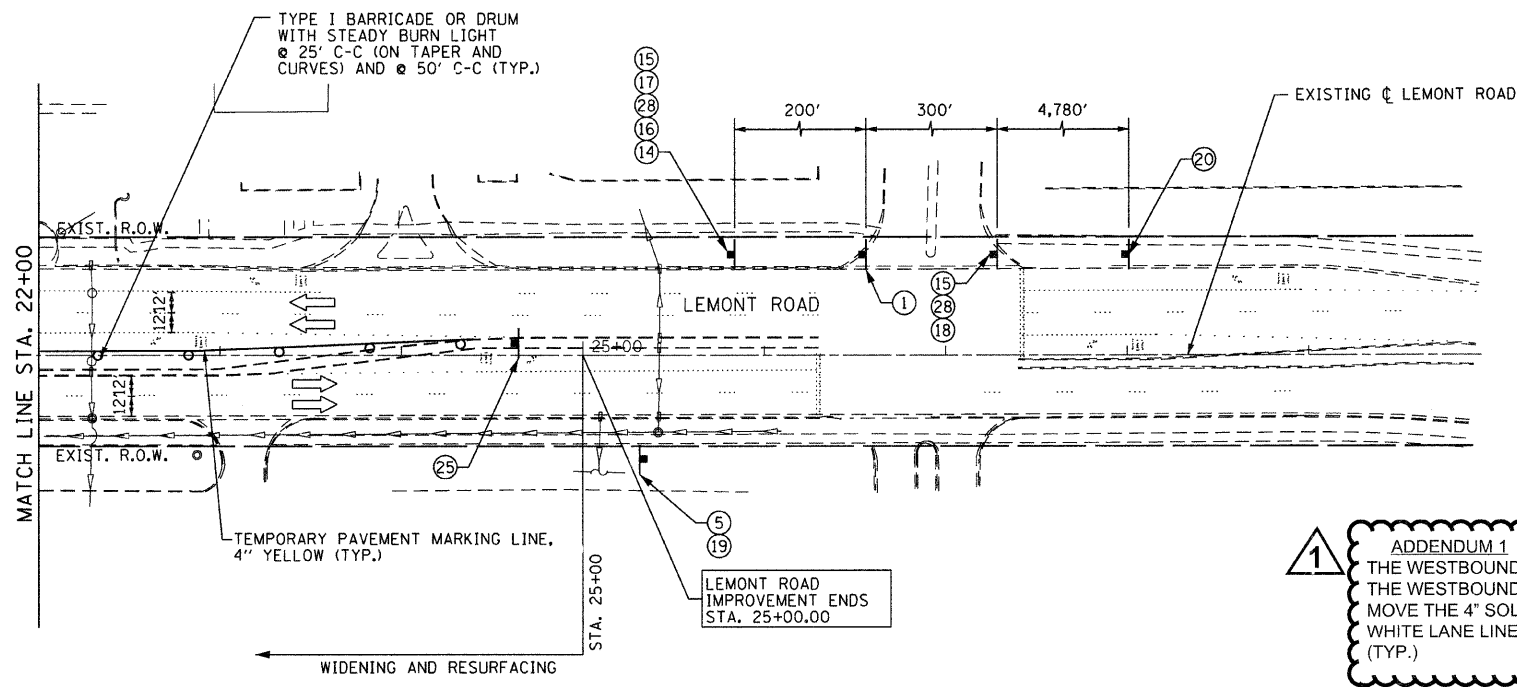

LEMONT ROAD IMPROVEMENT ENDS STA. 25+00.00

**1** ADDENDUM 1  
THE WESTBOUND DIRECTION IS TO INCLUDE TWO THRU LANES. THE WESTBOUND LANES ARE TO BE 11' WIDE (MIN.) MOVE THE 4" SOLID WHITE EDGE LINE AND ADD A 4" SKIP-DASH WHITE LANE LINE. MOVE BARRICADES AS REQUIRED. (TYP.)

**1** ADDENDUM 1: SEE SHEET 28 FOR MAINTENANCE OF TRAFFIC TYPICAL SECTIONS.

NOTE: PAVEMENT MARKING TAPE, TYPE III MUST BE USED ON THE PAVEMENT OUTSIDE OF THE PROJECT LIMITS IN ALL STAGES. FOR STAGE III, USE PAVEMENT MARKING TAPE, TYPE III ON THE NEW HMA SURFACE PRIOR TO THERMOPLASTIC PAVEMENT MARKINGS.

FILE NAME = f:\451-038-75th-st-04page-d01\eng\renewing\dr-orig\pa\451-038-011-1-1.dgn



USER NAME = gellwanger  
PLOT SCALE = 50.0000' / IN.  
PLOT DATE = 9/7/2011

DESIGNED - GJE	REVISED - 1 10-25-11
DRAWN - DC	REVISED -
CHECKED - JP	REVISED -
DATE - 9/08/11	REVISED -

STATE OF ILLINOIS  
DEPARTMENT OF TRANSPORTATION

MAINTENANCE OF TRAFFIC  
STAGE 1

SCALE: 1"=50' SHEET NO. 34 OF 198 SHEETS STA. TO STA.

F.A.P. RTE.	SECTION	COUNTY	TOTAL SHEETS	SHEET NO.
0369	07-00232-04-WR	DuPAGE	198	34
				CONTRACT NO. 63632
ILLINOIS FED. AID PROJECT				