

150 140 130 120 110 100 90 80 70 60 50 40 30 20 10 0 10 20 30 40 50 60 70 80 90 100 110 120 130 140 150

LEMONT ROAD

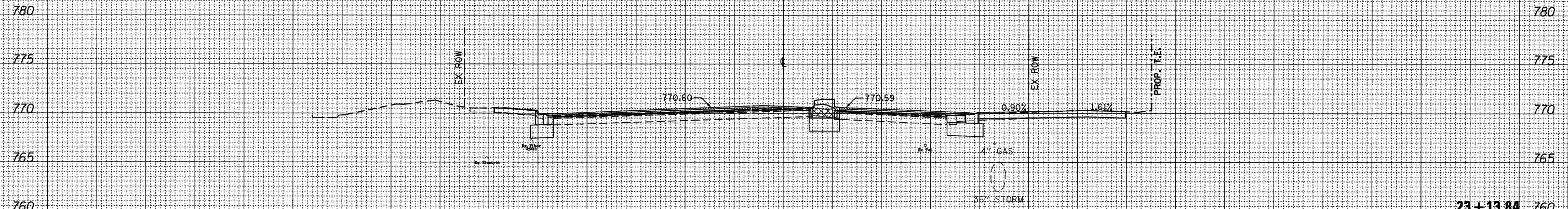

	CUT	FILL	UNSUITABLE
STAGE 1	0 CY	0 CY	0 CY
STAGE 2	18 CY	2 CY	5 CY
STAGE 3	14 CY	58 CY	0 CY

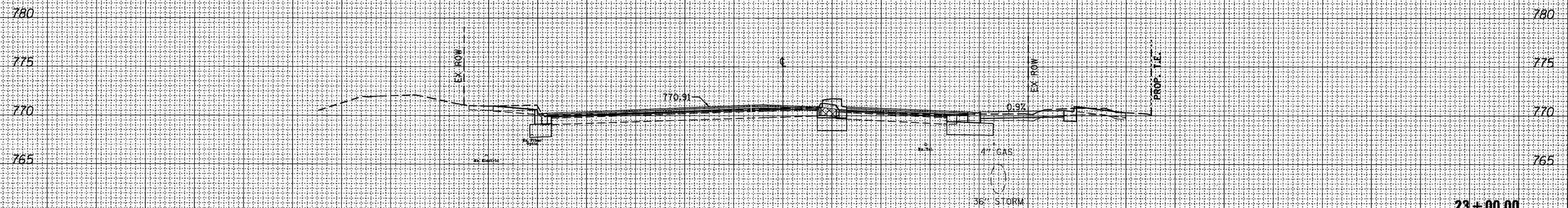

	CUT	FILL	UNSUITABLE
STAGE 1	0 CY	0 CY	0 CY
STAGE 2	24 CY	5 CY	5 CY
STAGE 3	12 CY	58 CY	0 CY

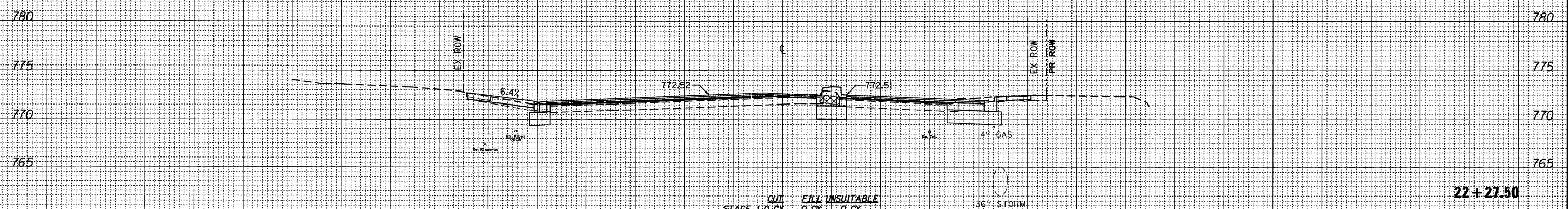

	CUT	FILL	UNSUITABLE
STAGE 1	0 CY	0 CY	0 CY
STAGE 2	27 CY	3 CY	6 CY
STAGE 3	12 CY	58 CY	0 CY

DATE	
BY	
FINAL SURVEY	
NOTE BOOK	
AREAS CHECKED	

DATE	
BY	
ORIGINAL SURVEY	
NOTE BOOK	
AREAS CHECKED	

FILE NAME = F:\451-038 75th st dupage dot\eng\engineering\drawings\451-038-ats-xasht-lemont.dgn

150 140 130 120 110 100 90 80 70 60 50 40 30 20 10 0 10 20 30 40 50 60 70 80 90 100 110 120 130 140 150

**Bollinger, Lach & Associates, Inc.**  
ITASCA, ILLINOIS

USER NAME = gellwanger	DESIGNED - GJE	REVISED -
PLOT SCALE = 10.0000' / IN.	DRAWN - DC	REVISED -
PLOT DATE = 9/7/2011	CHECKED - JP	REVISED -
	DATE - 09/08/11	REVISED -

**STATE OF ILLINOIS**  
**DEPARTMENT OF TRANSPORTATION**

**CROSS SECTIONS**  
**75TH STREET**  
V: 1"=5'  
SCALE: H: 1"=10'  
SHEET NO. 196 OF 198 SHEETS  
STA. 22+27.50 TO STA. 23+13.84

F.A.P. RTE. 0369	SECTION 07-00232-04-WR	COUNTY DUPAGE	TOTAL SHEETS 198	SHEET NO. 196
CONTRACT NO. 63632				ILLINOIS FED. AID PROJECT