

MATCH LINE SEE SHEET GRADING AND DRAINAGE PLAN SHEET 3

MATCH LINE SEE SHEET GRADING AND DRAINAGE PLAN SHEET 2

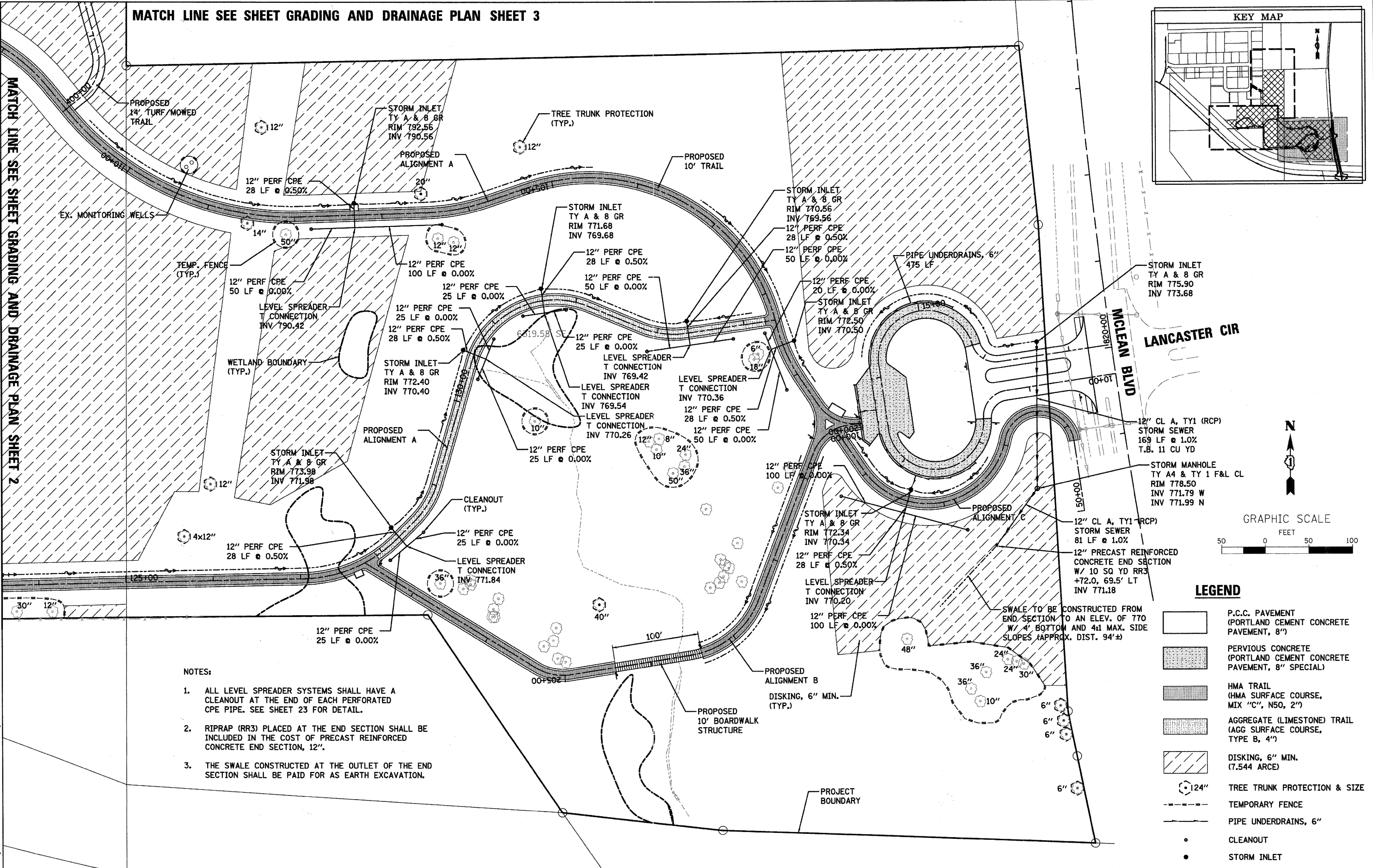

- NOTES:
1. ALL LEVEL SPREADER SYSTEMS SHALL HAVE A CLEANOUT AT THE END OF EACH PERFORATED CPE PIPE. SEE SHEET 23 FOR DETAIL.
 2. RIPRAP (RR3) PLACED AT THE END SECTION SHALL BE INCLUDED IN THE COST OF PRECAST REINFORCED CONCRETE END SECTION, 12".
 3. THE SWALE CONSTRUCTED AT THE OUTLET OF THE END SECTION SHALL BE PAID FOR AS EARTH EXCAVATION.

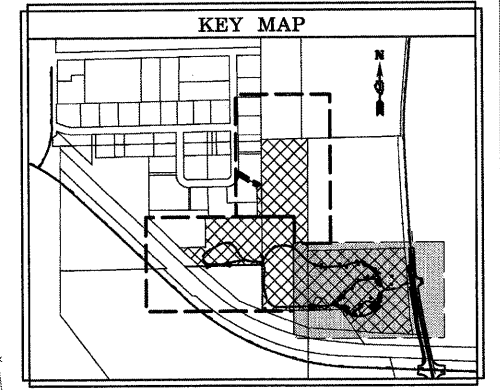
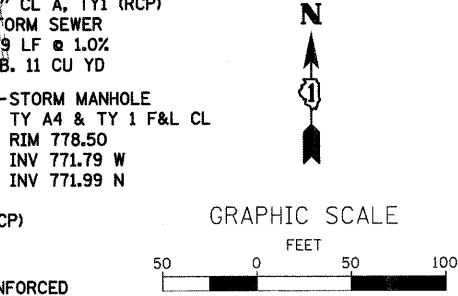

LEGEND

	P.C.C. PAVEMENT (PORTLAND CEMENT CONCRETE PAVEMENT, 8")
	PERVIOUS CONCRETE (PORTLAND CEMENT CONCRETE PAVEMENT, 8" SPECIAL)
	HMA TRAIL (HMA SURFACE COURSE, MIX "C", N50, 2")
	AGGREGATE (LIMESTONE) TRAIL (AGG SURFACE COURSE, TYPE B, 4")
	DISKING, 6" MIN. (7.544 ARCE)
	TREE TRUNK PROTECTION & SIZE
	TEMPORARY FENCE
	PIPE UNDERDRAINS, 6"
	CLEANOUT
	STORM INLET

WILLS BURKE KELSEY ASSOCIATES LTD.
 110 West Main Street, Suite 201
 St. Charles, Illinois 60174

USER NAME = rnparr1s	DESIGNED - P/JF	REVISED -
PLOT SCALE = 1"=50'	DRAWN - NDP	REVISED -
PLOT DATE = 8/30/2011	CHECKED - PDK	REVISED -
	DATE - 8/29/11	REVISED -

**STATE OF ILLINOIS
 DEPARTMENT OF TRANSPORTATION**

**MCLEAN BLVD ENVIRONMENTAL ADAPTIVE MANAGEMENT PLANS
 GRADING & DRAINAGE PLAN**

SCALE: 1"=50' SHEET NO. 1 OF 3 SHEETS STA. TO STA.

F.A.P. RTE. 361	SECTION 08-00214-11-LS	COUNTY KANE	TOTAL SHEETS 54	SHEET NO. 19
FED. ROAD DIST. NO. ILLINOIS FED. AID PROJECT			CONTRACT NO. 63638	