

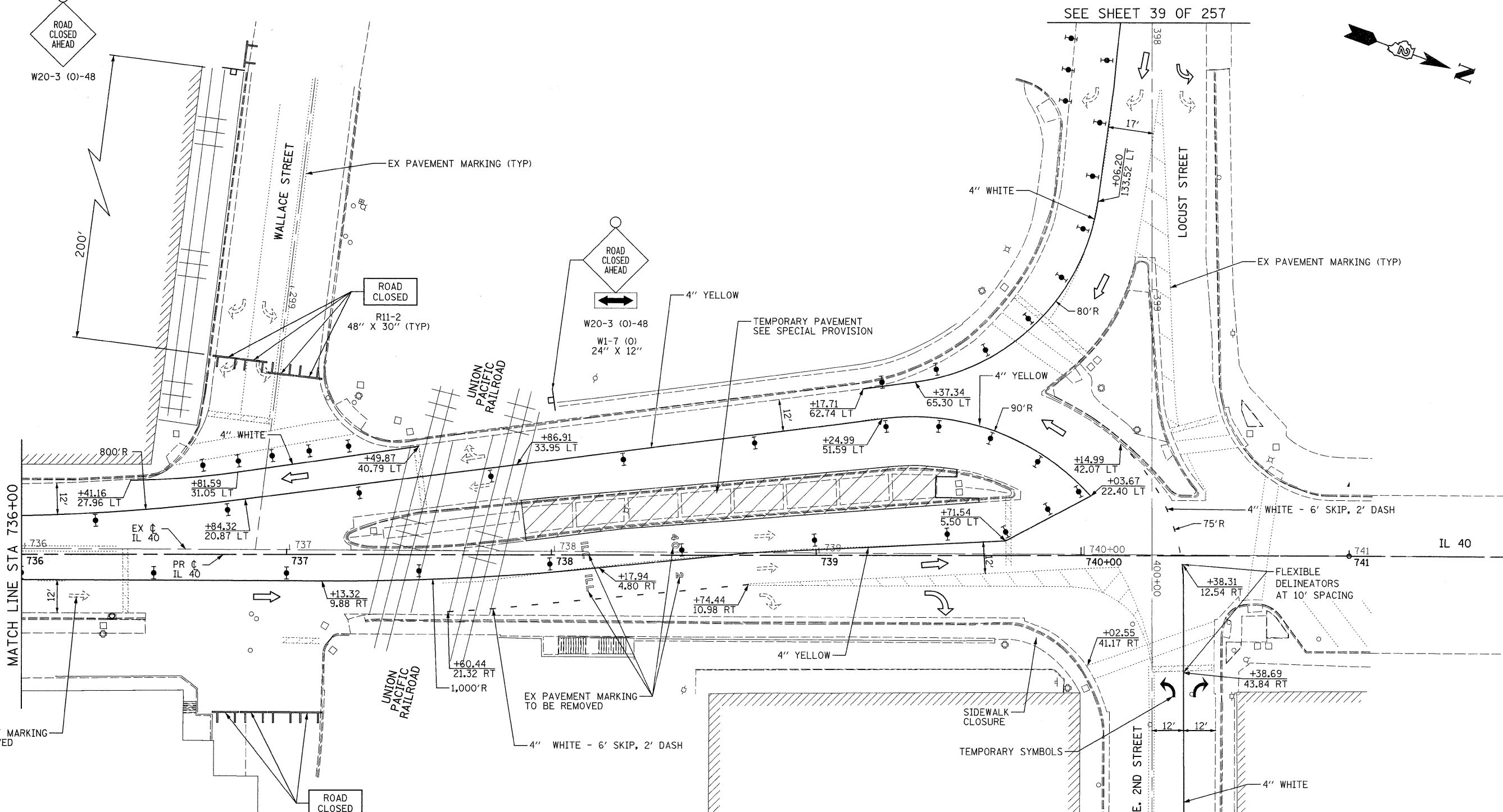

W20-3 (0)-48



SEE SHEET 39 OF 257



MATCH LINE STA 736+00

IL 40

SEE SHEET 41 OF 257

LEGEND

- WORK ZONE
- DRUM WITH STEADY BURNING MONODIRECTIONAL LIGHT AT 50' C-C SPACING (20' ON LANE TAPER)
- TYPE III BARRICADE WITH FLASHING LIGHTS. QUANTITY AS REQUIRED FOR PROPER CLOSURE TO SATISFACTION OF THE ENGINEER
- SIGN ON PORTABLE OR PERMANENT SUPPORT
- SIGN WITH FLASHING LIGHT
- IMPACT ATTENUATORS, TEMPORARY (NON-REDIRECTIVE), TEST LEVEL 2. NOTE: NARROW REQUIRED.
- ARROW BOARD
- CHANGEABLE MESSAGE SIGN

NOTES:

1. REFER TO STANDARD 701606 FOR ADDITIONAL SIGNS AND DEVICES NOT SHOWN.
2. REFER TO STANDARD 701801 FOR SIDEWALK CLOSURES.
3. TEMPORARY PAVEMENT MARKING. SEE SPECIAL PROVISION.

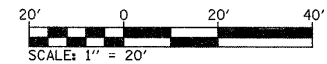

FILE NAME =	USER NAME = grantpm	DESIGNED -	REVISED -	<b>STATE OF ILLINOIS DEPARTMENT OF TRANSPORTATION</b>				<b>IL 40 MAINTENANCE OF TRAFFIC - PRE-STAGE</b>				F.A.P. RTE.	SECTION	COUNTY	TOTAL SHEETS	SHEET NO.
c:\pw\work\pwwork\grantpm\dms80258\0264880-sht-staging1.dgn	DRAWN -	REVISED -	REVISED -									646	18-2	WHITESIDE	257	38
PLOT SCALE = 20.00' / 1" =	CHECKED -	REVISED -	REVISED -	SCALE: 1" = 20'				SHEET NO. 11 OF 35 SHEETS		STA. 736+00 TO STA. 742+00		CONTRACT NO. 64880				
PLOT DATE = Fri Aug 12 13:59:12 2011	DATE = 2-22-2010	REVISED -	REVISED -					FED. ROAD DIST. NO.		ILLINOIS FED. AID PROJECT						