

DATE	
BY	
SURVEYED	
ALIGNED	
NOTED	
NO. OF WAY CHECKED	
NO.	

DATE	
BY	
SURVEYED	
ALIGNED	
NOTED	
NO. OF WAY CHECKED	
NO.	

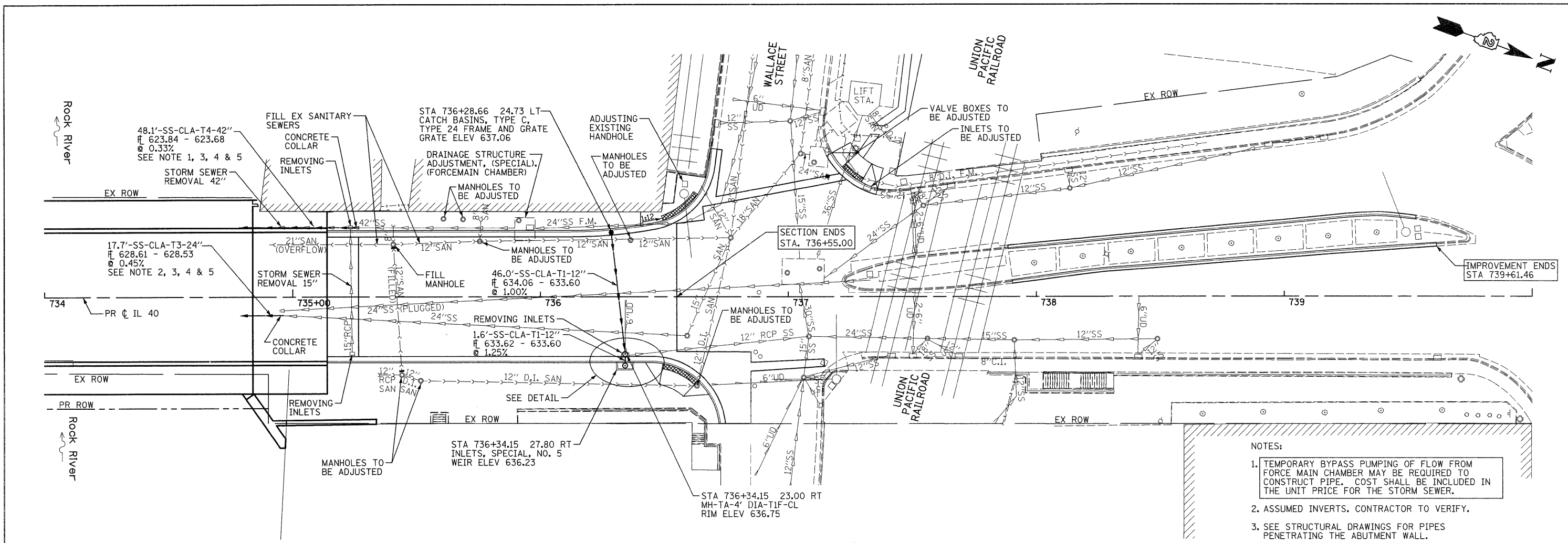

- NOTES:
- TEMPORARY BYPASS PUMPING OF FLOW FROM FORCE MAIN CHAMBER MAY BE REQUIRED TO CONSTRUCT PIPE. COST SHALL BE INCLUDED IN THE UNIT PRICE FOR THE STORM SEWER.
 - ASSUMED INVERTS. CONTRACTOR TO VERIFY.
 - SEE STRUCTURAL DRAWINGS FOR PIPES PENETRATING THE ABUTMENT WALL.
 - PIPES SHALL REQUIRE TRENCH PROTECTION PER ARTICLE 550.04. CONTRACTOR SHALL LIMIT EXCAVATION TO PROTECT BUILDING FOUNDATION. LAYING BACK THE SLOPE WILL NOT BE ALLOWED.
 - MECHANICAL TIES REQUIRED ACCORDING TO DISTRICT 2 STANDARD 90.2. TIES SHALL BE INCLUDED IN THE COST OF THE STORM SEWER OF THE CLASS, TYPE AND SIZE SPECIFIED.

