

FOR INFORMATION ONLY

STATE OF ILLINOIS  
DEPARTMENT OF TRANSPORTATION

PROJECT NO.	SECTION	SUBJECT	SHEET NO.	TOTAL SHEETS
64B80	1BR-1	Whiteside	44	35
SHEET NO. 14 28 SHEETS				

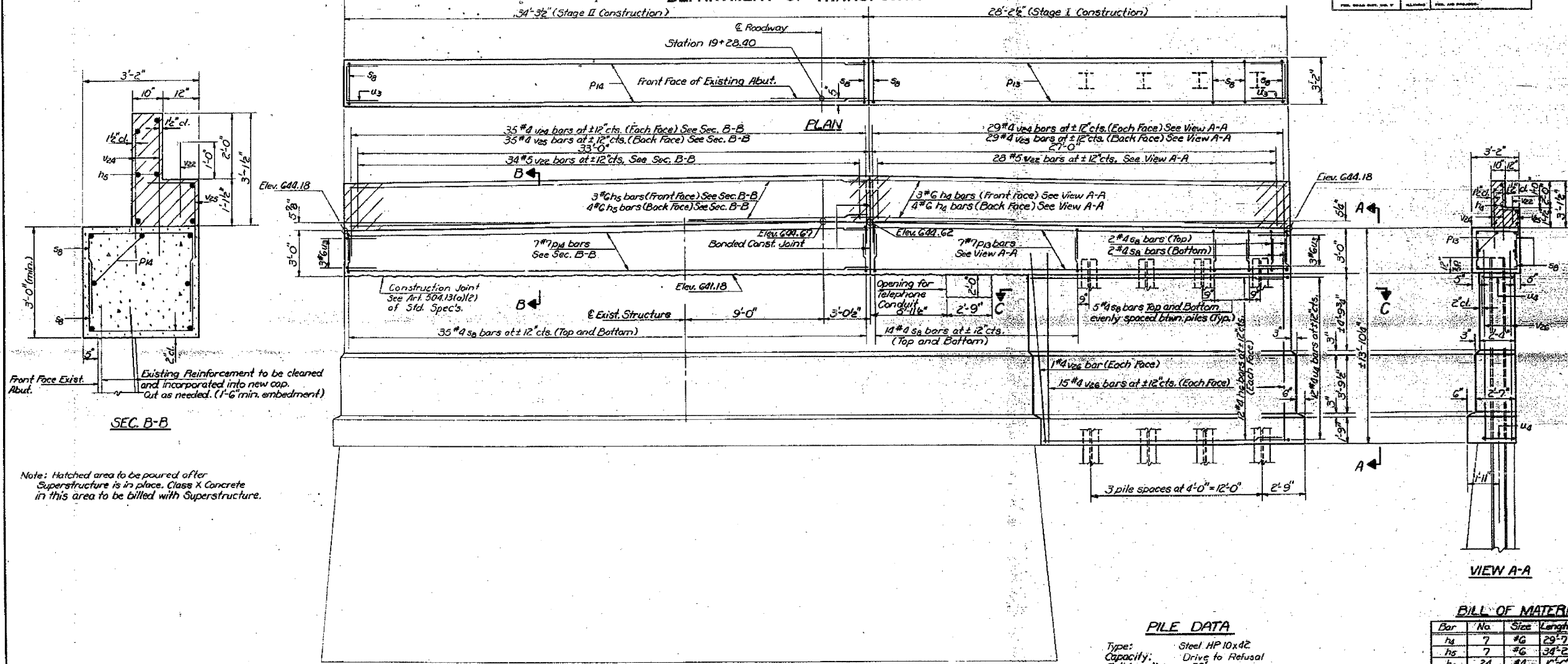

Note: Hatched area to be poured after Superstructure is in place. Class K Concrete in this area to be filled with Superstructure.

**PILE DATA**  
Type: Steel HP 10x42  
Capacity: Drive to Refusal  
Est. Length: 26  
No. Required: 4

**BILL OF MATERIAL**

Bar	No.	Size	Length	Shape
h <sub>8</sub>	7	#6	29'-7"	□
h <sub>6</sub>	7	#6	34'-2"	□
h <sub>2</sub>	24	#4	16'-6"	□
p <sub>8</sub>	7	#7	29'-7"	□
p <sub>6</sub>	7	#7	34'-2"	□
s <sub>8</sub>	132	#4	7'-0"	□
u <sub>8</sub>	6	#6	6'-5"	□
u <sub>6</sub>	12	#4	5'-8"	□
v <sub>2</sub>	62	#5	2'-0"	□
v <sub>4</sub>	128	#4	4'-6"	□
v <sub>6</sub>	64	#4	4'-0"	□
v <sub>8</sub>	32	#4	12'-0"	□
Class (Concrete): C-12				
Reinforcement Bars: Grade 60				
Groundwater: 10'-0"				

**ELEVATION**  
Looking South

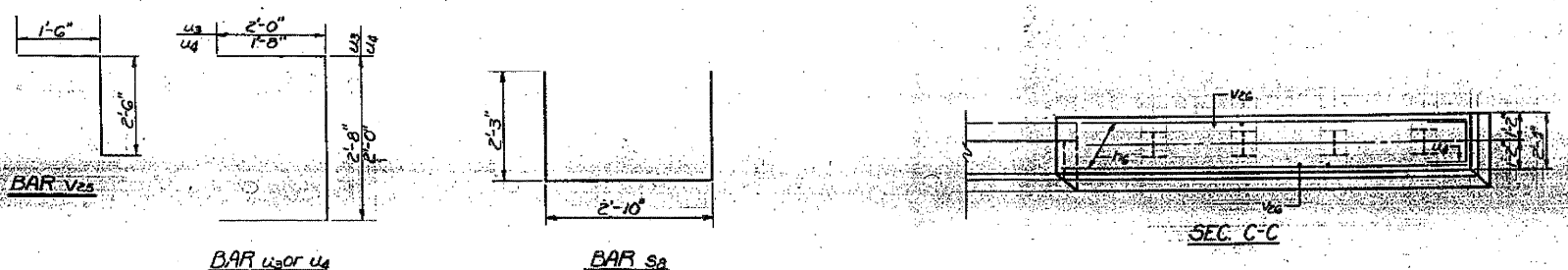

DESIGNED: DAN KRULL  
CHECKED: M.J. Ryan  
DRAWN: Joe Sutherland  
CHECKED: MJR

EXAMINED: [Signature]  
DATE: Feb 29 1980  
APPROVED: [Signature]

**SOUTH ABUTMENT**  
FA. RT. 646 SEC. 1BR-1  
WHITESIDE COUNTY  
STATION 19+24.0