

DATE: _____
 SURVEYED: _____
 ALIGNED: _____
 CHECKED: _____
 P.T. OF WAY CHECKED: _____
 PLOT DATE: _____

DATE: _____
 BY: _____
 SURVEYED: _____
 GRADES CHECKED: _____
 B.M. NOTED: _____
 STRUCTURE NOTATIONS CHECKED: _____

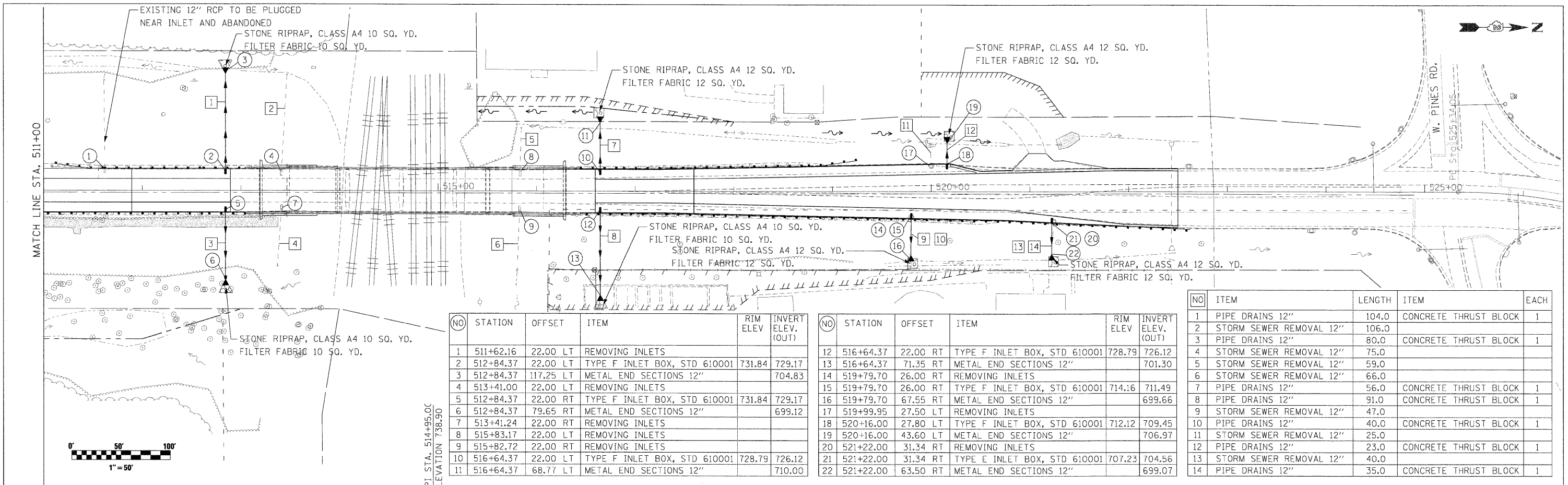

NO	STATION	OFFSET	ITEM	RIM ELEV.	INVERT ELEV. (OUT)
1	511+62.16	22.00 LT	REMOVING INLETS		
2	512+84.37	22.00 LT	TYPE F INLET BOX, STD 610001	731.84	729.17
3	512+84.37	117.25 LT	METAL END SECTIONS 12"		704.83
4	513+41.00	22.00 LT	REMOVING INLETS		
5	512+84.37	22.00 RT	TYPE F INLET BOX, STD 610001	731.84	729.17
6	512+84.37	79.65 RT	METAL END SECTIONS 12"		699.12
7	513+41.24	22.00 RT	REMOVING INLETS		
8	515+83.17	22.00 LT	REMOVING INLETS		
9	515+82.72	22.00 RT	REMOVING INLETS		
10	516+64.37	22.00 LT	TYPE F INLET BOX, STD 610001	728.79	726.12
11	516+64.37	68.77 LT	METAL END SECTIONS 12"		710.00

NO	STATION	OFFSET	ITEM	RIM ELEV.	INVERT ELEV. (OUT)
12	516+64.37	22.00 RT	TYPE F INLET BOX, STD 610001	728.79	726.12
13	516+64.37	71.35 RT	METAL END SECTIONS 12"		701.30
14	519+79.70	26.00 RT	REMOVING INLETS		
15	519+79.70	26.00 RT	TYPE F INLET BOX, STD 610001	714.16	711.49
16	519+79.70	67.55 RT	METAL END SECTIONS 12"		699.66
17	519+99.95	27.50 LT	REMOVING INLETS		
18	520+16.00	27.80 LT	TYPE F INLET BOX, STD 610001	712.12	709.45
19	520+16.00	43.60 LT	METAL END SECTIONS 12"		706.97
20	521+22.00	31.34 RT	REMOVING INLETS		
21	521+22.00	31.34 RT	TYPE E INLET BOX, STD 610001	707.23	704.56
22	521+22.00	63.50 RT	METAL END SECTIONS 12"		699.07

NO	ITEM	LENGTH	ITEM	EACH
1	PIPE DRAINS 12"	104.0	CONCRETE THRUST BLOCK	1
2	STORM SEWER REMOVAL 12"	106.0		
3	PIPE DRAINS 12"	80.0	CONCRETE THRUST BLOCK	1
4	STORM SEWER REMOVAL 12"	75.0		
5	STORM SEWER REMOVAL 12"	59.0		
6	STORM SEWER REMOVAL 12"	66.0		
7	PIPE DRAINS 12"	56.0	CONCRETE THRUST BLOCK	1
8	PIPE DRAINS 12"	91.0	CONCRETE THRUST BLOCK	1
9	STORM SEWER REMOVAL 12"	47.0		
10	PIPE DRAINS 12"	40.0	CONCRETE THRUST BLOCK	1
11	STORM SEWER REMOVAL 12"	25.0		
12	PIPE DRAINS 12"	23.0	CONCRETE THRUST BLOCK	1
13	STORM SEWER REMOVAL 12"	40.0		
14	PIPE DRAINS 12"	35.0	CONCRETE THRUST BLOCK	1

