

# EXISTING STRUCTURE PLANS (FOR REFERENCE ONLY)

STATE OF ILLINOIS  
DEPARTMENT OF TRANSPORTATION  
DIVISION OF HIGHWAYS

## PROPOSED HIGHWAY PLANS

FAP ROUTE 316 (IL26)  
SECTION (102BR)M & (102BR-1)M-1

LEE COUNTY  
C-92-015-06

FOR INDEX OF SHEETS, SEE SHEET NO. 2  
FOR STATE STANDARDS, SEE SHEET NO. 2

316 \* LEE 28

D-92-091-05

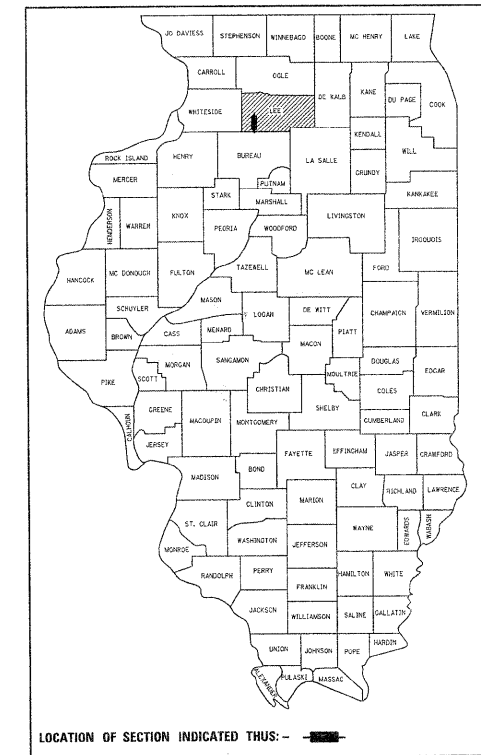

MARION TOWNSHIP SECTION - 21 & 22  
EAST GROVE SECTION - 3 & 4

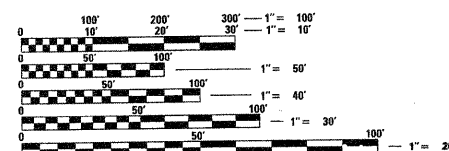

FULL SIZE PLANS HAVE BEEN PREPARED USING STANDARD ENGINEERING SCALES. REDUCED SIZED PLANS WILL NOT CONFORM TO STANDARD SCALES. IN MAKING MEASUREMENTS ON REDUCED PLANS, THE ABOVE SCALES MAY BE USED.

J.U.L.I.E.  
JOINT UTILITY LOCATION INFORMATION FOR EXCAVATION  
1-800-892-0123

CONTRACT NO. 64B28

PROJECT LOCATION #2  
STR. NO. 052-0025

PROJECT LOCATION #1  
STR. NO. 052-0026

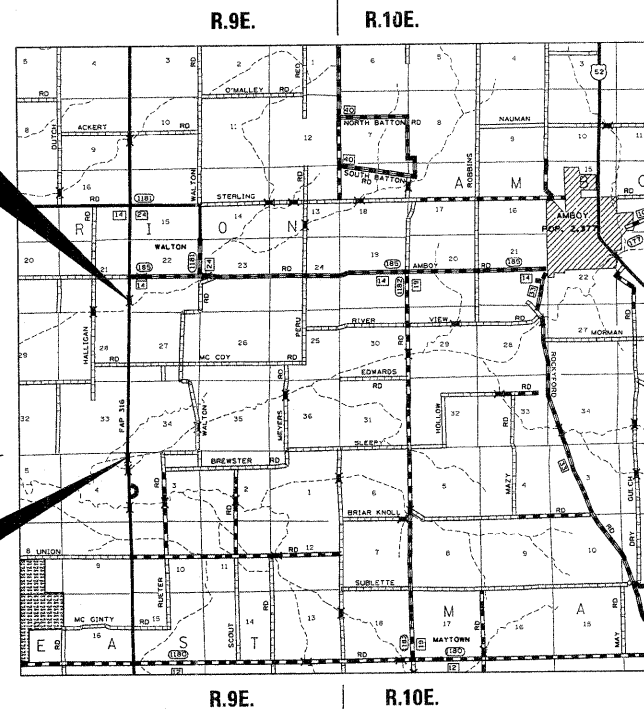

STATE OF ILLINOIS  
DEPARTMENT OF TRANSPORTATION  
DIVISION OF HIGHWAYS

SUBMITTED 6-1-2007  
*[Signature]*  
DEPUTY DIRECTOR OF HIGHWAYS, REGION ENGINEER

June 29, 2007  
*[Signature]*  
ENGINEER OF DESIGN AND ENVIRONMENT

June 29, 2007  
*[Signature]*  
DIRECTOR OF HIGHWAYS, CHIEF ENGINEER

**PRINTED BY THE AUTHORITY  
OF THE STATE OF ILLINOIS**

FILE NAME =	USER NAME = grantpm	DESIGNED -	REVISED -	<b>STATE OF ILLINOIS DEPARTMENT OF TRANSPORTATION</b>	<b>EXISTING STRUCTURE PLANS</b>	F.A.P. RTE. 316	SECTION *	COUNTY LEE	TOTAL SHEETS 216	SHEET NO. 160
ct:\pwork\pwork\grantpm\dms41818\02-21-tp\pca\dgn		DRAWN -	REVISED -							
	PLOT SCALE = 50.00000 / in.	CHECKED -	REVISED -							
	PLOT DATE = Thu Jul 14 10:19:56 2011	DATE -	REVISED -		SCALE:	SHEET NO.	OF	SHEETS	STA.	TO STA.
										CONTRACT NO. 64D57
										ILLINOIS FED. AID PROJECT