

F.A.P. RTE.	SECTION	COUNTY	TOTAL SHEETS NO.	SHEET NO.
326	(SCS,13C,108,109)R	KENDALL	931	161
STA.	TO STA.			
FED. ROAD DIST. NO.	ILLINOIS	FED. AID PROJECT		

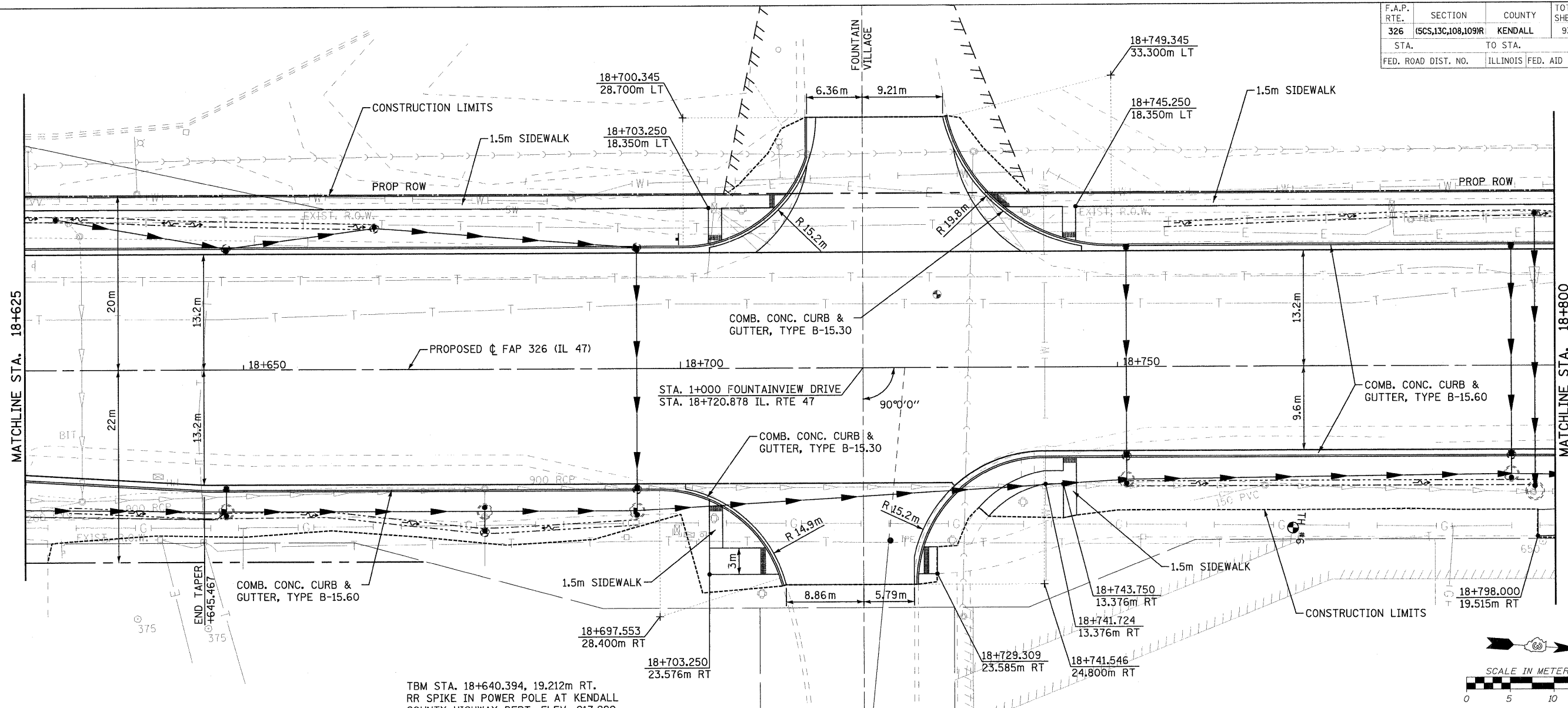

TBM STA. 18+640.394, 19.212m RT.
RR SPIKE IN POWER POLE AT KENDALL
COUNTY HIGHWAY DEPT. ELEV. 217.299

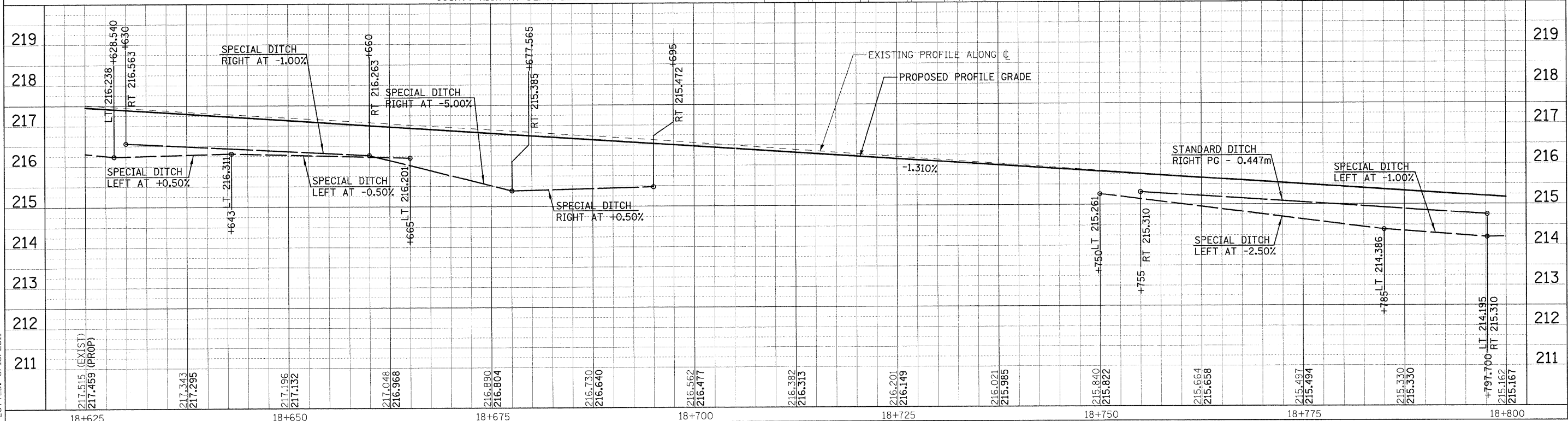
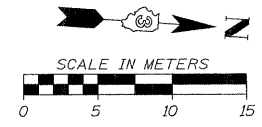

FILE: 161pp47_05.dgn
PLOTTER: B713/2011

Sheet: 5
Angle: 93.9081
Chain: P-IL47

HMG JOB NO. 5122