

F.A.P. RTE.	SECTION	COUNTY	TOTAL SHEETS	SHEET NO.
326	(5CS,13C,10B,109R)	KENDALL	931	318
STA.		TO STA.		
FED. ROAD DIST. NO.		ILLINOIS FED. AID PROJECT		

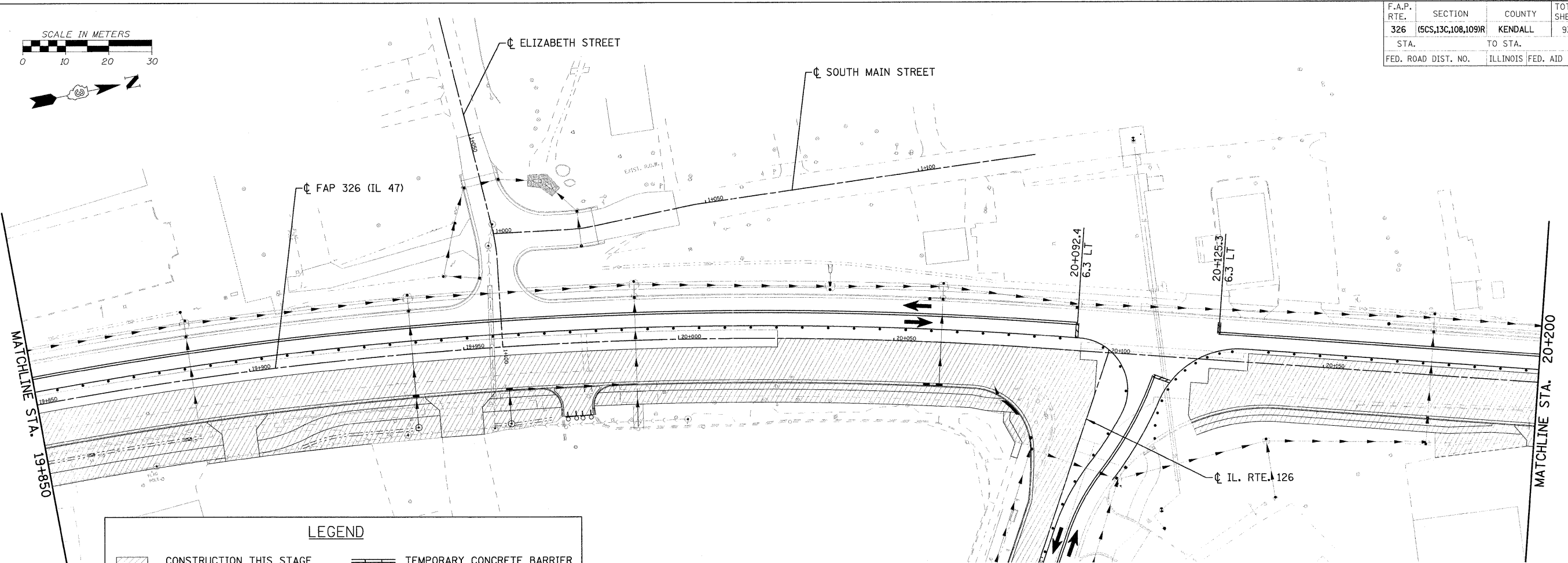

LEGEND	
	CONSTRUCTION THIS STAGE
	TEMPORARY PAVEMENT
	TRAFFIC FLOW
	TEMPORARY PAVEMENT MARKING
	SIGN ON PORTABLE OR PERMANENT SUPPORT
	TEMPORARY CONCRETE BARRIER
	IMPACT ATTENUATOR
	DRUM OR BARRICADE
	TYPE III BARRICADE WITH FLASHING LIGHTS

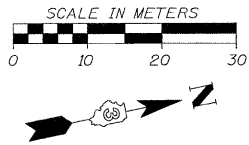
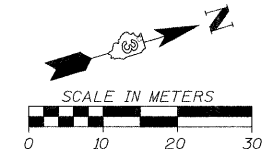
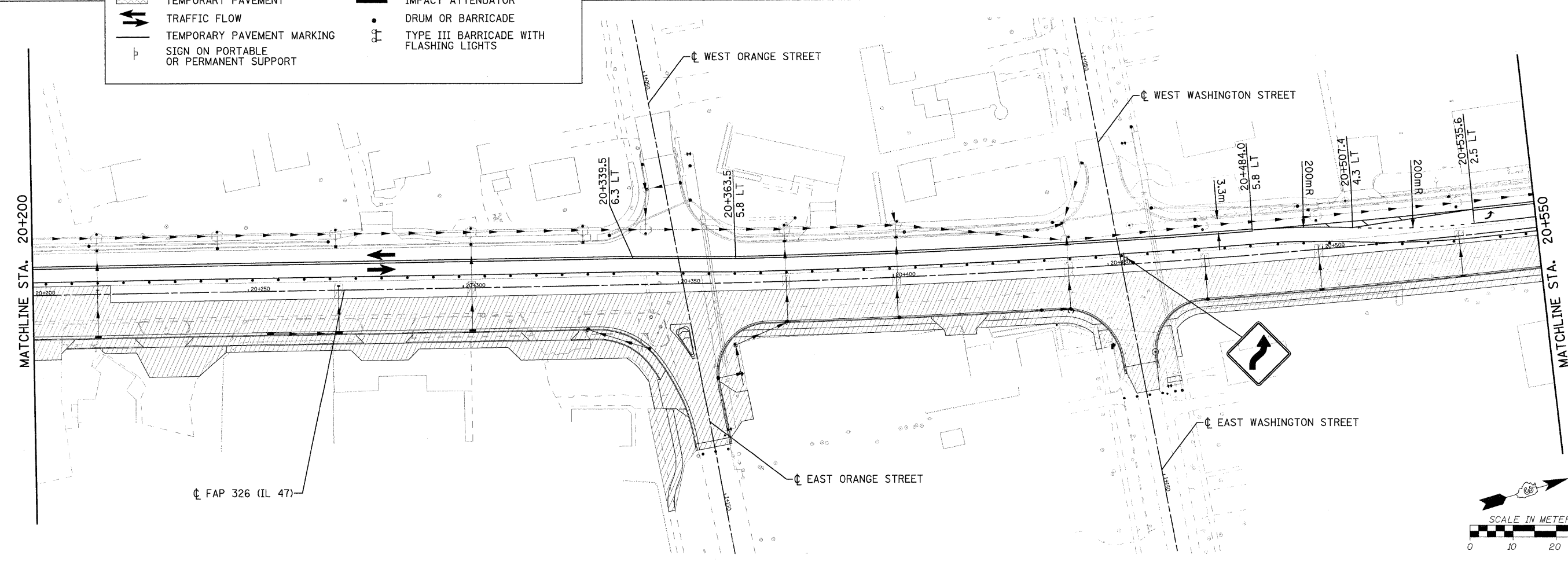

FILE: 318STAGE\_3\_47\_04.dgn  
PLOTTED: 8/11/2011

HMG JOB NO. 5122