

|                     |                    |                           |              |           |
|---------------------|--------------------|---------------------------|--------------|-----------|
| F.A.P. RTE.         | SECTION            | COUNTY                    | TOTAL SHEETS | SHEET NO. |
| 326                 | (5CS,13C,10B,109R) | KENDALL                   | 931          | 375       |
| STA.                |                    | TO STA.                   |              |           |
| FED. ROAD DIST. NO. |                    | ILLINOIS FED. AID PROJECT |              |           |

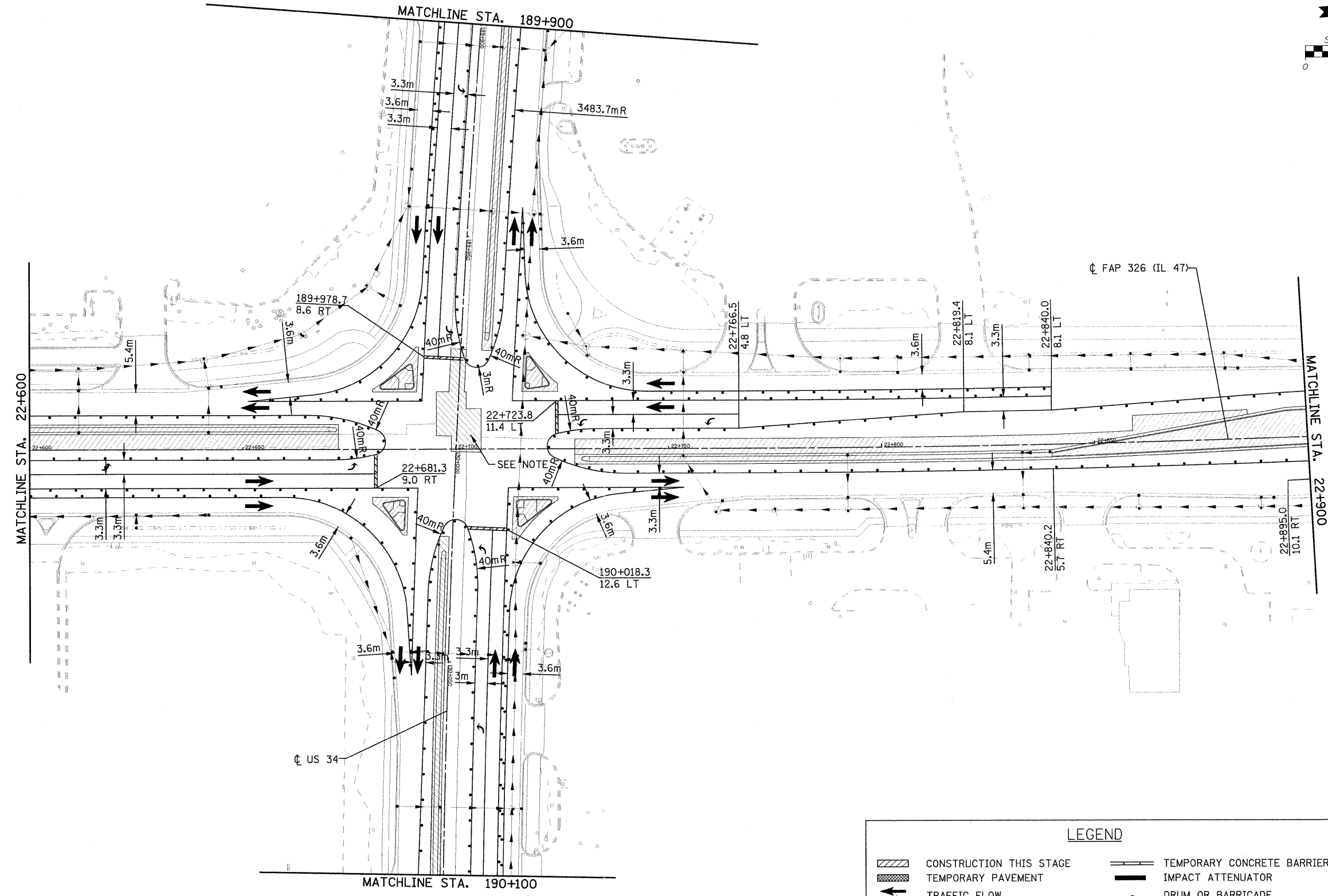
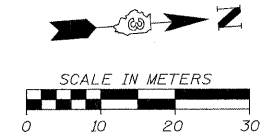

| LEGEND |                                       |  |   |
|--------|---------------------------------------|--|---|
|        | CONSTRUCTION THIS STAGE               |  | TEMPORARY CONCRETE BARRIER              |
|        | TEMPORARY PAVEMENT                    |  | IMPACT ATTENUATOR                       |
|        | TRAFFIC FLOW                          |  | DRUM OR BARRICADE                       |
|        | TEMPORARY PAVEMENT MARKING            |  | TYPE III BARRICADE WITH FLASHING LIGHTS |
|        | SIGN ON PORTABLE OR PERMANENT SUPPORT |  |   |

NOTE: REMAINING SLABS NOT IN PREVIOUS STAGES SHALL BE CONSTRUCTED UTILIZING TEMPORARY LANE SHIFTS AND/OR LANE CLOSURES. THE CONTRACTOR MAY, AT THEIR OPTION, DEVELOP INTERMEDIATE STAGES DURING THE CHANGE OVER FROM ONE STAGE TO THE NEXT TO COMPLETE THESE SLABS.

FILE: 375STAGE\_9\_47\_08.dgn  
PLOTTED: 8/11/2001

HMG JOB NO. 5122