

F.A.P. RTE.	SECTION	COUNTY	TOTAL SHEETS	SHEET NO.
326	(5CS,13C,108,109)R	KENDALL	931	385
STA. 00+900		TO STA. 22+550		
FED. ROAD DIST. NO.		ILLINOIS FED. AID PROJECT		

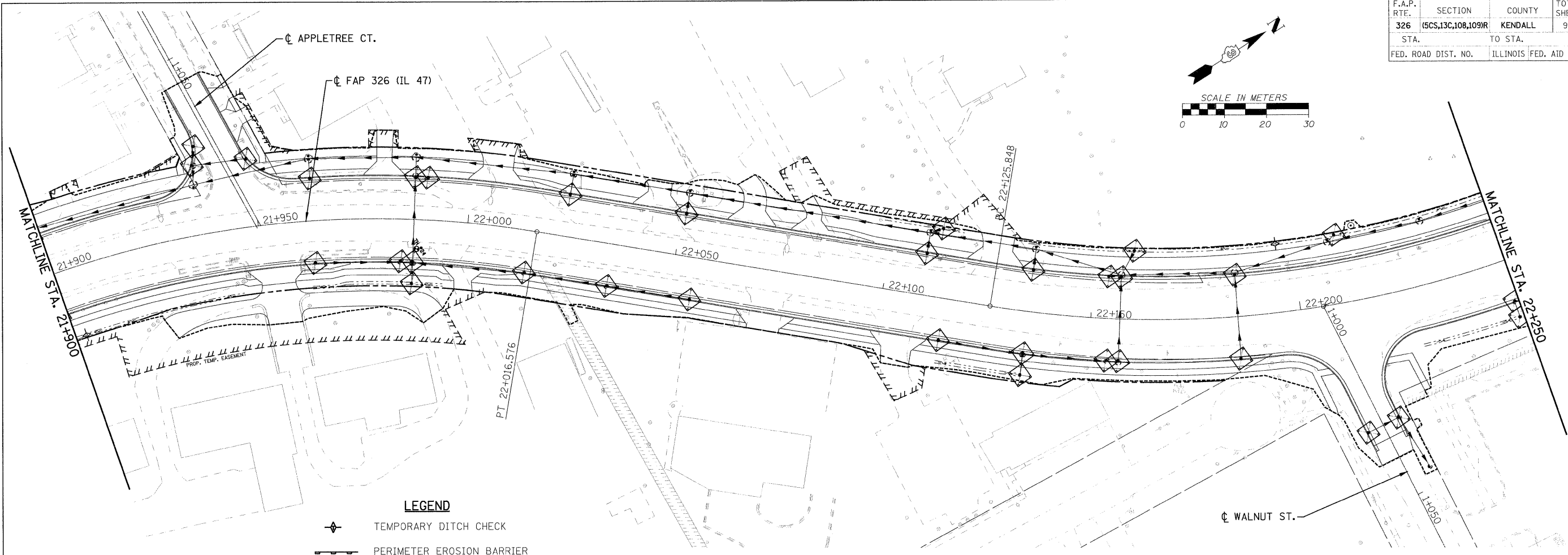

- LEGEND**
- TEMPORARY DITCH CHECK
 - PERIMETER EROSION BARRIER
 - INLET AND PIPE PROTECTION

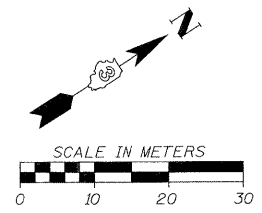
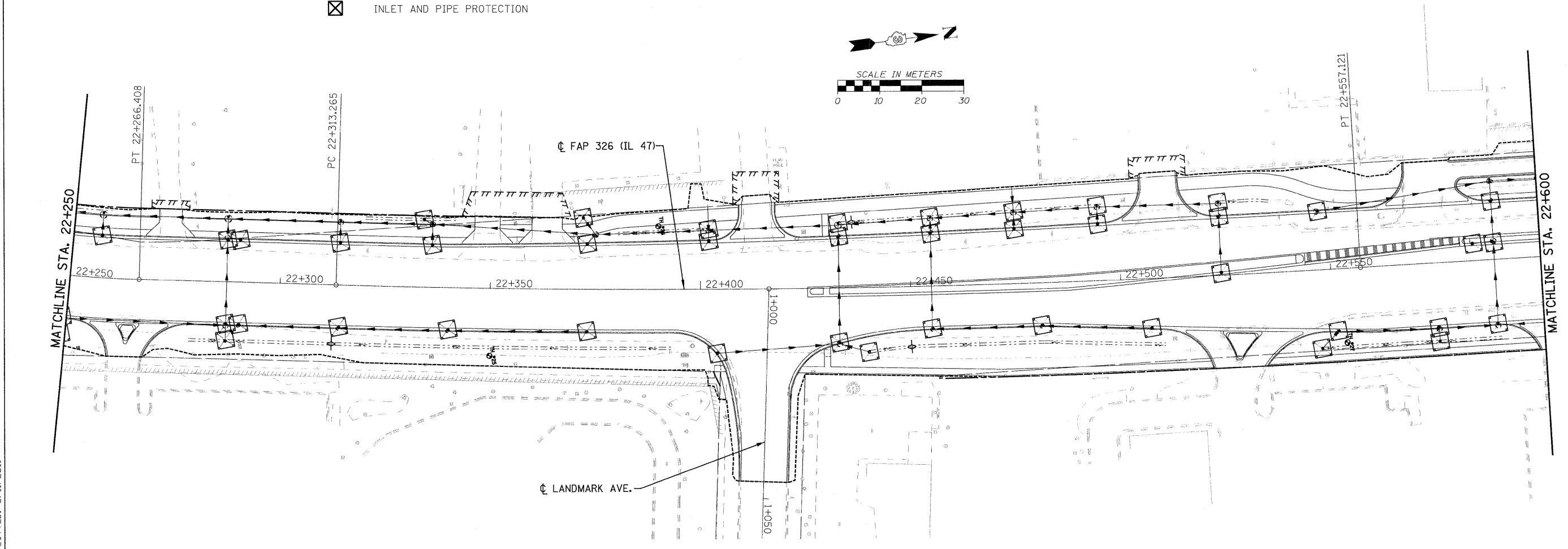
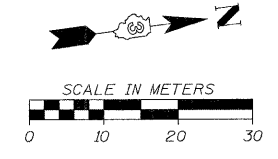

FILE: 385swppp47_07.dgn
PLOTTED: 8/11/2011

HMG JOB NO. 5122