

F.A.P. RTE.	SECTION	COUNTY	TOTAL SHEETS	SHEET NO.
326	(6CS,13C,108,109)R	KENDALL	931	386
STA.	TO STA.			
FED. ROAD DIST. NO.	ILLINOIS	FED. AID PROJECT		

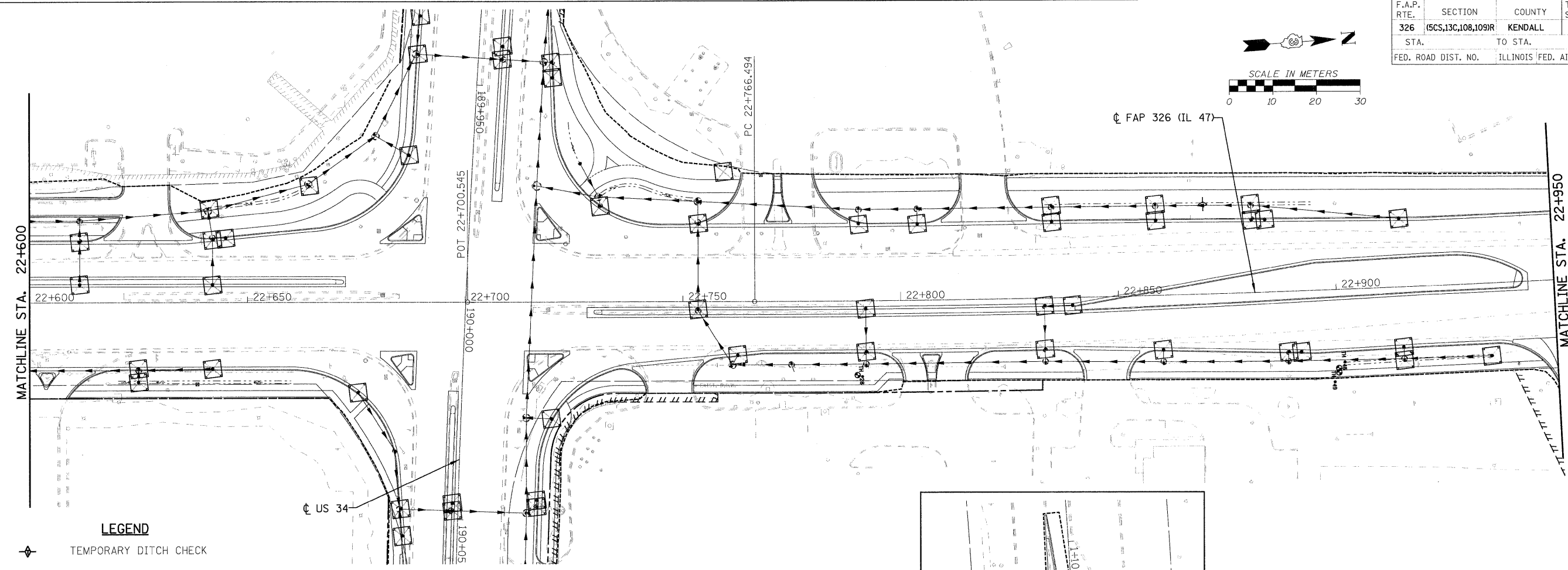

- LEGEND**
- ◆ TEMPORARY DITCH CHECK
  - ▬ PERIMETER EROSION BARRIER
  - ⊠ INLET AND PIPE PROTECTION

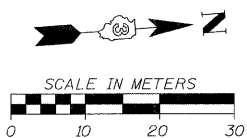
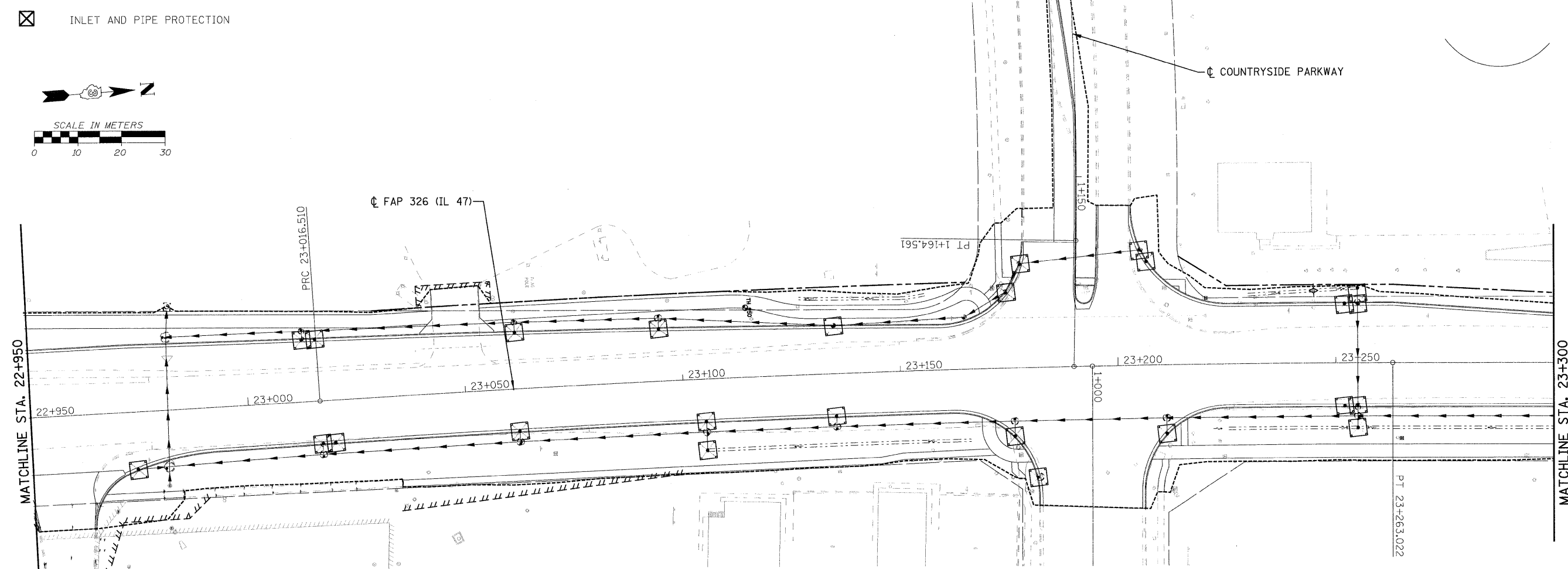
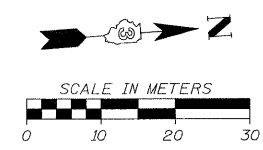

FILE: 386swppp47\_08.dgn  
PLOTTED: 8/11/2011

HMG JOB NO. 5122