

F.A.P. RTE.	SECTION	COUNTY	TOTAL SHEETS	SHEET NO.
326	(5CS,13C,108,109R)	KENDALL	931	407
STA.	TO STA.			
FED. ROAD DIST. NO.	ILLINOIS FED. AID PROJECT			

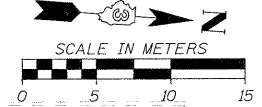

- P126 STORM SEWER, CL. A, R.G., 750 34.119m AT 1.40%
- P128 STORM SEWER, CL. A, R.G., 300 3.664m AT 2.00%
- P129 STORM SEWER, CL. A, R.G., 750 19.8m AT 1.40%
- P130 STORM SEWER, CL. A, R.G., 300 3.846m AT 2.00%
- P131 STORM SEWER, CL. A, R.G., 750 25.801m AT 1.40%
- P132 STORM SEWER, CL. A, R.G., 300 3.801m AT 2.00%
- P133 STORM SEWER, CL. A, R.G., 750 27.818m AT 1.40%
- P134 STORM SEWER, CL. A, R.G., 300 1.858m AT 2.00%
- P135 STORM SEWER, CL. A, R.G., 750 38.855m AT 1.40%
- P136 STORM SEWER, CL. A, R.G., 300 2.352m AT 2.00%
- P137 STORM SEWER, CL. A, R.G., 750 41.803m AT 1.40%
- P141 STORM SEWER, CL. A, R.G., 300 23.098m AT 1.00%
- P142 STORM SEWER, CL. A, R.G., 300 36.364m AT 2.00%
- P143 STORM SEWER, CL. A, R.G., 300 39.016m AT 2.00%
- P144 STORM SEWER, CL. A, R.G., 300 2.545m AT 1.00%
- P145 STORM SEWER, CL. A, R.G., 450 24.262m AT 1.00%
- P146 STORM SEWER, CL. A, R.G., 450 3.316m AT 1.00%

- 145 MH. TY. A, 1.2m DIA., TY. 1 FRAME, CL. LID STA. 18+605, 13.818m LT. GRATE 217.421 INV. (W) 215.798 INV. 216.286
- 146 INLET TY. B, TY. 3V F&G STA. 18+605, 11.428m RT. GRATE 217.469 INV. 215.546

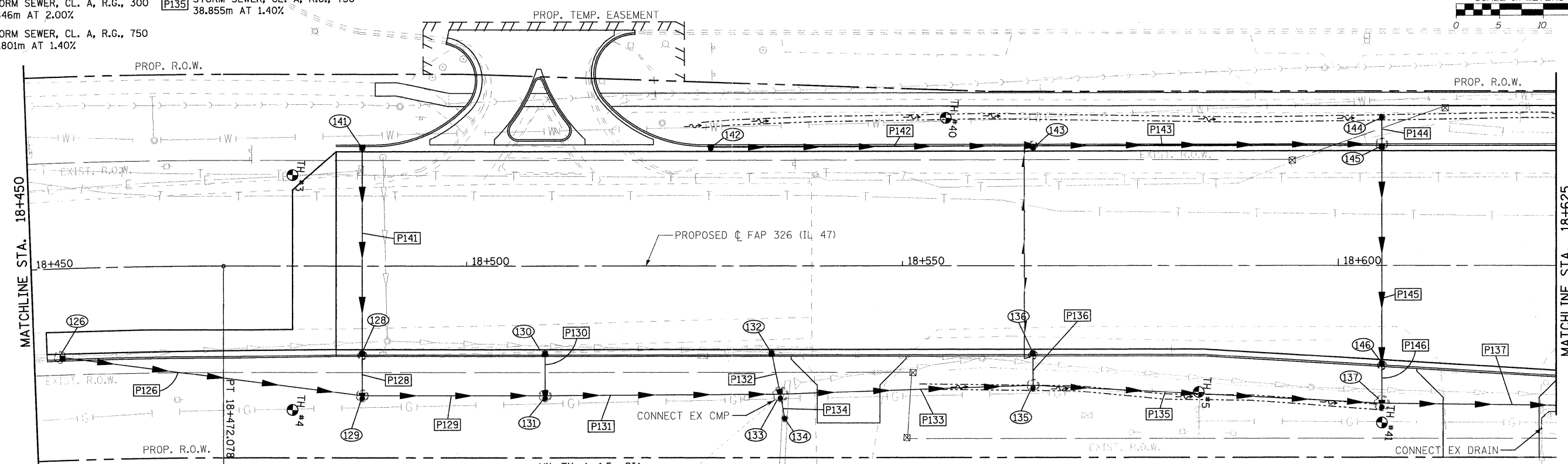

- 126 MH. TY. A, 1.5m DIA., TY. 3V F&G STA. 18+453, 9.978m RT. GRATE 220.507 INV. 218.755
- 128 INLET TY. B, TY. 3V F&G STA. 18+488, 10.067m RT. GRATE 219.684 INV. 218.492
- 129 MH. TY. A, 1.5m DIA., TY. 1 FRAME, CL. LID STA. 18+488, 14.875m RT. GRATE 219.926 INV. (S) 218.260 INV. (N) 218.260 INV. (W) 218.395
- 130 INLET TY. A, TY. 3V F&G STA. 18+508.998, 10.067m RT. GRATE 219.194 INV. 218.305
- 131 MH. TY. A, 1.5m DIA., TY. 1 FRAME, CL. LID STA. 18+509, 14.874m RT. GRATE 219.439 INV. (S) 217.966 INV. (N) 217.509 INV. (W) 218.209
- 132 INLET TY. A, TY. 3V F&G STA. 18+535, 10.067m RT. GRATE 218.646 INV. 217.757
- 133 MH. TY. A, 1.5m DIA., TY. 1 FRAME, CL. LID STA. 18+536, 14.725m RT. GRATE 218.872 INV. (S) 217.131 INV. (N) 216.521 INV. (W) 217.662 INV. (SE) 217.402
- 134 INLET TY. A, TY. 8 GRATE STA. 18+536.5, 17.5m RT. GRATE 218.347 INV. 217.458
- 135 MH. TY. A, 1.5m DIA., TY. 8 GRATE STA. 18+565, 13.713m RT. GRATE 217.549 INV. (S) 216.115 INV. (N) 215.506 INV. (W) 216.602
- 136 INLET TY. B, TY. 3V F&G STA. 18+565, 10.217m RT. GRATE 218.094 INV. 216.672
- 137 MH. TY. A, 1.5m DIA., TY. 8 GRATE STA. 18+605, 15.8m RT. GRATE 216.348 INV. (S,N) 214.945 INV. (W) 215.197
- 141 INLET TY. A, TY. 3V F&G STA. 18+488, 13.668m LT. GRATE 219.618 INV. 218.729
- 142 INLET TY. A, TY. 3V F&G STA. 18+528, 13.668m LT. GRATE 218.715 INV. (N) 217.826
- 143 INLET TY. B, TY. 3V F&G STA. 18+565, 13.817m LT. GRATE 218.022 INV. 217.086
- 144 INLET TY. A, TY. 8 GRATE STA. 18+605, 17m LT. GRATE 216.719 INV. 215.830

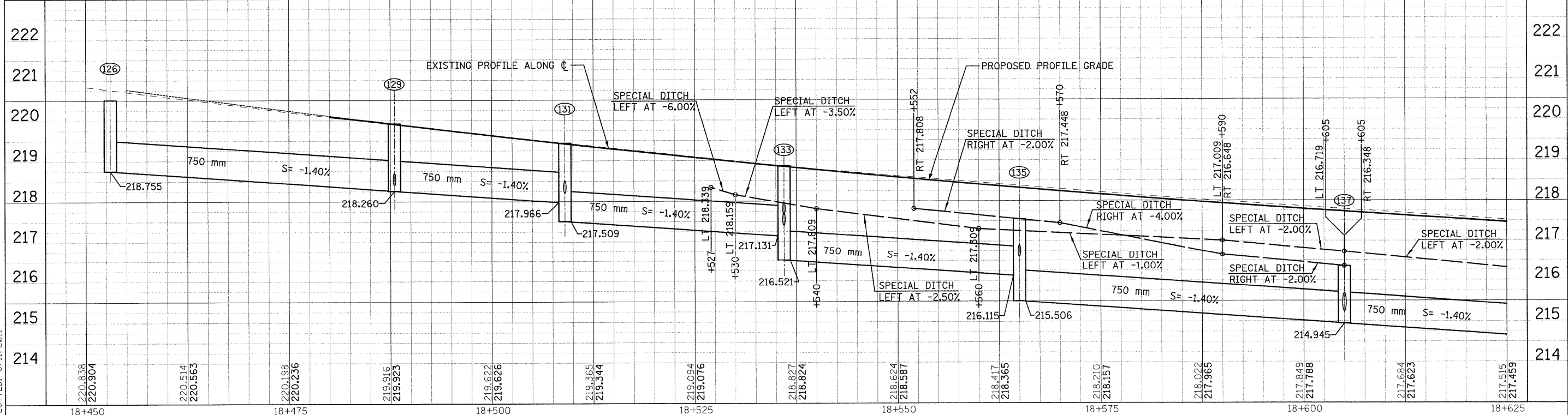

FILE: 407sm47_04.dgn
PLOTTED: 8/11/2011

Sheet: 4
Angle: 54.0447
Date: 8-11-11

HMG JOB NO. 5122