

F.A.P. RTE.	SECTION	COUNTY	TOTAL SHEETS	SHEET NO.
326	(5S,13C,108,109R)	KENDALL	931	414
STA.	TO STA.			
FED. ROAD DIST. NO.	ILLINOIS FED. AID PROJECT			

- P36 STORM SEWER, CL.A, R.G., 300 1.326m AT 2.0%
- P35 STORM SEWER, CL.A, R.G., 300 19.647m AT 2.0%
- P217 STORM SEWER, CL.A, R.G., 300 1.059m AT 2.0%
- P218 STORM SEWER, CL.A, R.G., 1200 31.957m AT 0.48%
- P225 STORM SEWER, CL.A, R.G., 300 1.831m AT 2.0%
- P226 STORM SEWER, CL.A, R.G., 450 25.930m AT 0.60%
- P227 STORM SEWER, CL.A, R.G., 300 1.831m AT 2.0%
- P228 STORM SEWER, CL.A, R.G., 450 25.930m AT 0.60%
- P229 STORM SEWER, CL.A, R.G., 450 5.225m AT 2.0%
- P230 STORM SEWER, CL.A, R.G., 450 1.596m AT 2.0%
- P231 STORM SEWER, CL.A, R.G., 600 19.929m AT 1.0%
- P232 STORM SEWER, CL.A, R.G., 600 0.934m AT 1.0%
- P233 STORM SEWER, CL.A, R.G., 1350 32.149m AT 0.48%
- P234 STORM SEWER, CL.A, R.G., 300 1.059m AT 4.0%
- P235 STORM SEWER, CL.A, R.G., 1350 32.149m AT 0.48%
- P236 STORM SEWER, CL.A, R.G., 300 19.865m AT 1.0%
- P237 STORM SEWER, CL.A, R.G., 300 11.999m AT 1.5%
- P238 STORM SEWER, CL.A, R.G., 300 8.440m AT 2.0%
- P239 STORM SEWER, CL.A, R.G., 300 8.559m AT 2.0%
- P240 STORM SEWER, CL.A, R.G., 300 6.361m AT 2.0%
- P241 STORM SEWER, CL.A, R.G., 300 2.213m AT 2.0%
- P242 STORM SEWER, CL.A, R.G., 300 16.108m AT 1.25%
- P243 STORM SEWER, CL.A, R.G., 450 18.698m AT 2.0%
- P244 STORM SEWER, CL.A, R.G., 450 1.071m AT 2.0%
- P245 STORM SEWER, CL.A, R.G., 1350 37.653m AT 0.48%
- P246 STORM SEWER, CL.A, R.G., 1350 40.149m AT 0.48%

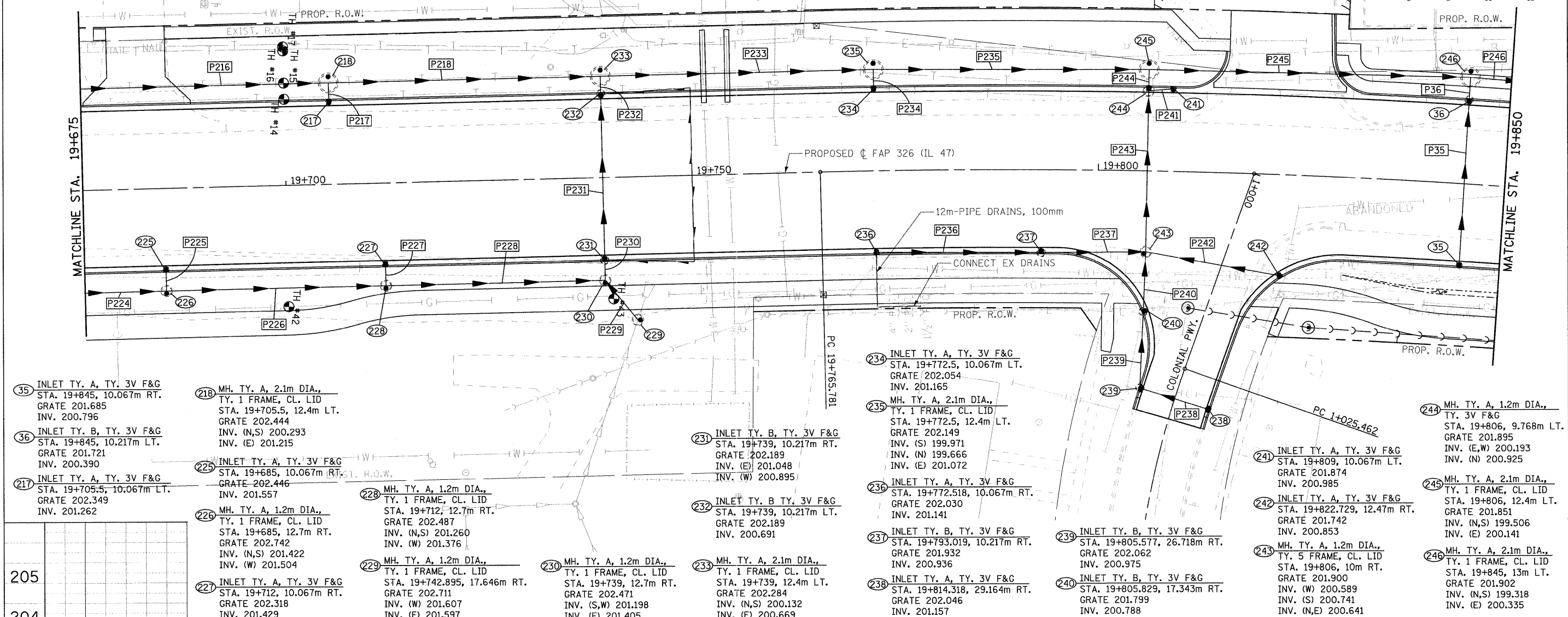

- 35 INLET TY. A, TY. 3V F&G STA. 19+845, 10.067m RT. GRATE 201.685 INV. 200.796
- 36 INLET TY. B, TY. 3V F&G STA. 19+845, 10.217m LT. GRATE 201.721 INV. 200.390
- 217 INLET TY. A, TY. 3V F&G STA. 19+705.5, 10.067m LT. GRATE 202.349 INV. 201.262
- 218 MH. TY. A, 2.1m DIA., TY. 1 FRAME, CL. LID STA. 19+705.5, 12.4m LT. GRATE 202.444 INV. (N,S) 200.293 INV. (E) 201.215
- 225 INLET TY. A, TY. 3V F&G STA. 19+685, 10.067m RT. GRATE 202.446 INV. 201.557
- 226 MH. TY. A, 1.2m DIA., TY. 1 FRAME, CL. LID STA. 19+685, 12.7m RT. GRATE 202.742 INV. (N,S) 201.422 INV. (W) 201.504
- 227 INLET TY. A, TY. 3V F&G STA. 19+712, 10.067m RT. GRATE 202.318 INV. 201.429
- 228 MH. TY. A, 1.2m DIA., TY. 1 FRAME, CL. LID STA. 19+712, 12.7m RT. GRATE 202.487 INV. (N,S) 201.260 INV. (W) 201.376
- 229 MH. TY. A, 1.2m DIA., TY. 1 FRAME, CL. LID STA. 19+742.895, 17.646m RT. GRATE 202.711 INV. (W) 201.607 INV. (E) 201.597
- 230 MH. TY. A, 1.2m DIA., TY. 1 FRAME, CL. LID STA. 19+739, 12.7m RT. GRATE 202.471 INV. (S,W) 201.198 INV. (E) 201.405
- 231 INLET TY. B, TY. 3V F&G STA. 19+739, 10.217m RT. GRATE 202.189 INV. (E) 201.048 INV. (W) 200.895
- 232 INLET TY. B, TY. 3V F&G STA. 19+739, 10.217m LT. GRATE 202.189 INV. 200.691
- 233 MH. TY. A, 2.1m DIA., TY. 1 FRAME, CL. LID STA. 19+739, 12.4m LT. GRATE 202.284 INV. (N,S) 200.132 INV. (E) 200.669
- 234 INLET TY. A, TY. 3V F&G STA. 19+772.5, 10.067m LT. GRATE 202.054 INV. 201.165
- 235 MH. TY. A, 2.1m DIA., TY. 1 FRAME, CL. LID STA. 19+772.5, 12.4m LT. GRATE 202.149 INV. (S) 199.971 INV. (N) 199.666 INV. (E) 201.072
- 236 INLET TY. A, TY. 3V F&G STA. 19+772.518, 10.067m RT. GRATE 202.030 INV. 201.141
- 237 INLET TY. B, TY. 3V F&G STA. 19+793.019, 10.217m RT. GRATE 201.932 INV. 200.936
- 238 INLET TY. A, TY. 3V F&G STA. 19+814.318, 29.164m RT. GRATE 202.046 INV. 201.157
- 239 INLET TY. B, TY. 3V F&G STA. 19+805.577, 26.718m RT. GRATE 202.062 INV. 200.975
- 240 INLET TY. B, TY. 3V F&G STA. 19+805.829, 17.343m RT. GRATE 201.799 INV. 200.788
- 241 INLET TY. A, TY. 3V F&G STA. 19+809, 10.067m LT. GRATE 201.874 INV. 200.985
- 242 INLET TY. A, TY. 3V F&G STA. 19+822.729, 12.47m RT. GRATE 201.742 INV. 200.853
- 243 MH. TY. A, 1.2m DIA., TY. 5 FRAME, CL. LID STA. 19+806, 10m RT. GRATE 201.900 INV. (W) 200.589 INV. (S) 200.741 INV. (N,E) 200.641
- 244 MH. TY. A, 1.2m DIA., TY. 3V F&G STA. 19+806, 9.768m LT. GRATE 201.895 INV. (E,W) 200.193 INV. (N) 200.925
- 245 MH. TY. A, 2.1m DIA., TY. 1 FRAME, CL. LID STA. 19+806, 12.4m LT. GRATE 201.851 INV. (N,S) 199.506 INV. (E) 200.141
- 246 MH. TY. A, 2.1m DIA., TY. 1 FRAME, CL. LID STA. 19+845, 13m LT. GRATE 201.902 INV. (N,S) 199.318 INV. (E) 200.335

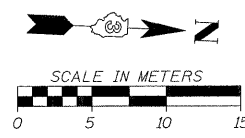
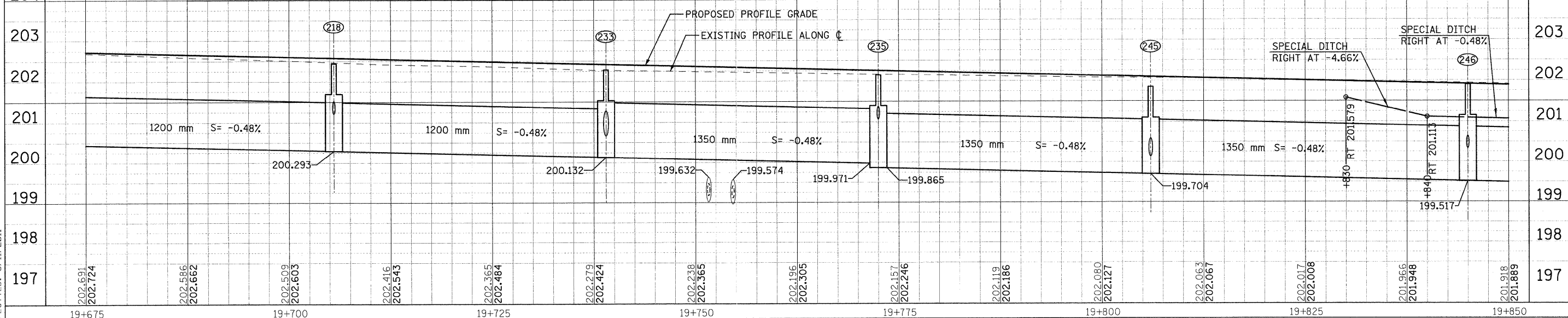

FILE: 414stn47_11.dgn
PLOTTED: 8/11/2011

HMG JOB NO. 5122