

- P316 STORM SEWER, CL.A, R.G., 300 2.367m AT 3.00%
- P317 STORM SEWER, CL.A, R.G., 300 0.785m AT 4.00%
- P318 STORM SEWER, CL.A, R.G., 1500 16.787m AT 0.55%
- P319 STORM SEWER, CL.A, R.G., 1500 10.387m AT 0.55%
- P324 STORM SEWER, CL.A, R.G., 300 2.019m AT 2.75%
- P325 STORM SEWER, CL.A, R.G., 300 15.558m AT 2.00%
- P327 STORM SEWER, CL.A, R.G., 300 5.967m AT 1.00%
- P328 STORM SEWER, CL.A, R.G., 300 11.020m AT 1.00%
- P329 STORM SEWER, CL.A, R.G., 300 0.786m AT 1.00%
- P337 STORM SEWER, CL.A, R.G., 600 11.141m AT 1.90%
- P338 STORM SEWER, CL.A, R.G., 600 9.333m AT 1.50%
- P339 STORM SEWER, CL.A, R.G., 1500 36.787m AT 0.55%
- P340 STORM SEWER, CL.A, R.G., 300 15.573m AT 2.00%
- P341 STORM SEWER, CL.A, R.G., 300 23.264m AT 3.50%
- P342 STORM SEWER, CL.A, R.G., 1650 28.323m AT 0.50%

- P343 STORM SEWER, CL.A, R.G., 1650 13.093m AT 0.50%
- P344 STORM SEWER, CL.A, R.G., 300 2.828m AT 4.00%
- P345 STORM SEWER, CL.A, R.G., 1650 19.615m AT 0.50%
- P346 STORM SEWER, CL.A, R.G., 300 2.828m AT 4.00%
- P347 STORM SEWER, CL.A, R.G., 1650 19.615m AT 0.50%
- P348 STORM SEWER, CL.A, R.G., 300 2.828m AT 4.00%
- P349 STORM SEWER, CL.A, R.G., 1650 17.615m AT 0.50%
- P372 STORM SEWER, CL.A, R.G., 300 29.364m AT 4.80%
- P373 STORM SEWER, CL.A, R.G., 300 32.181m AT 4.80%

- 316 INLET TY. A, TY. 11V F&G STA. 20+552, 9.336m LT. GRATE 193.406 INV. 192.517
- 317 INLET TY. B, TY. 11V F&G STA. 20+555, 9.485m LT. GRATE 193.319 INV. 192.274
- 318 M.H. TY.A, 2.4m DIA., TY. 5 FRAME, CL. LID STA. 20+556.6, 7.7m LT. GRATE 193.339 INV. (N) 189.770 INV. (S) 190.594 INV. (W) 192.179 INV. (E) 191.720

- 319 M.H. TY.A, 2.4m DIA., TY. 5 FRAME, CL. LID STA. 20+575, 7.7m LT. GRATE 192.834 INV. (N) 189.273 INV. (S) 189.669
- 324 INLET TY. B, TY. 11V F&G STA. 20+553.6, 9.485m RT. GRATE 193.361 INV. 192.454
- 325 M.H. TY. A, 1.2m DIA. TY. 11V F&G STA. 20+556.6, 9.635m RT. GRATE 193.275 INV. (S) 192.371 INV. (W) 192.066

- 327 INLET TY. B, TY. 11V F&G STA. 20+631.986, 14.089m LT. GRATE 191.285 INV. (N,S) 189.819
- 328 INLET TY. A, TY. 11V F&G STA. 20+643.642, 14.239m LT. GRATE 190.825 INV. 189.936
- 329 INLET TY. B, TY. 11V F&G STA. 20+627, 9.485m LT. GRATE 191.091 INV. 189.752

F.A.P. RTE.	SECTION	COUNTY	TOTAL SHEETS	SHEET NO.
326	(5CS,13C,10B,109)R	KENDALL	931	419
STA.		TO STA.		
FED. ROAD DIST. NO.		ILLINOIS FED. AID PROJECT		

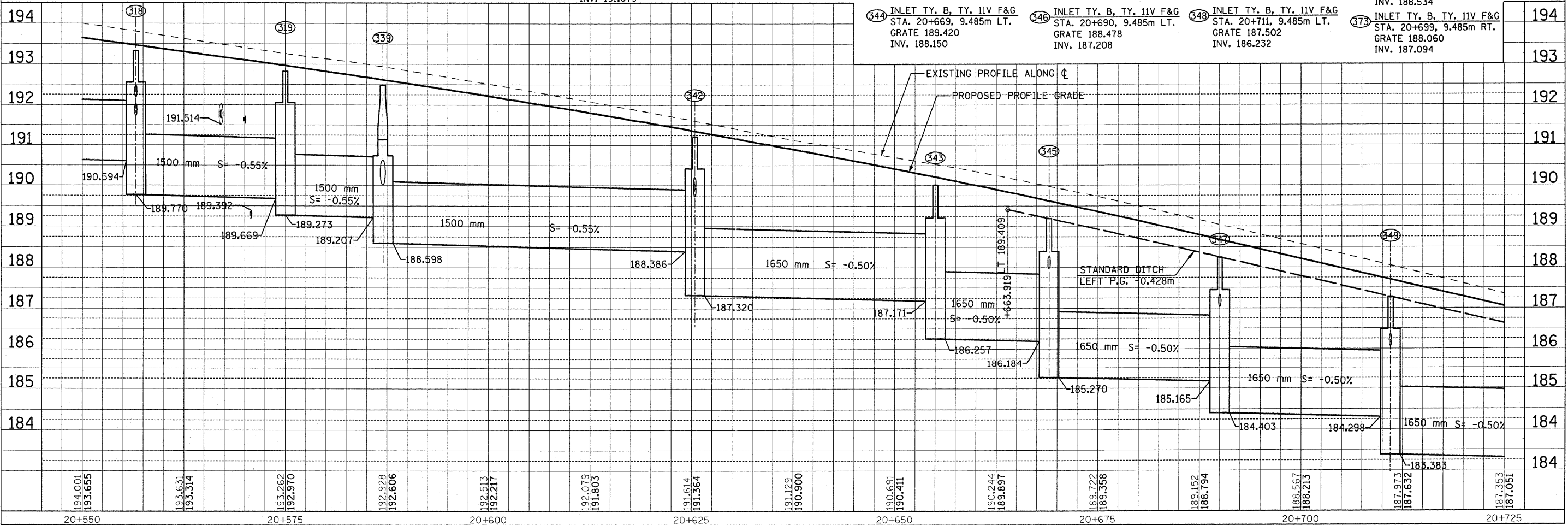
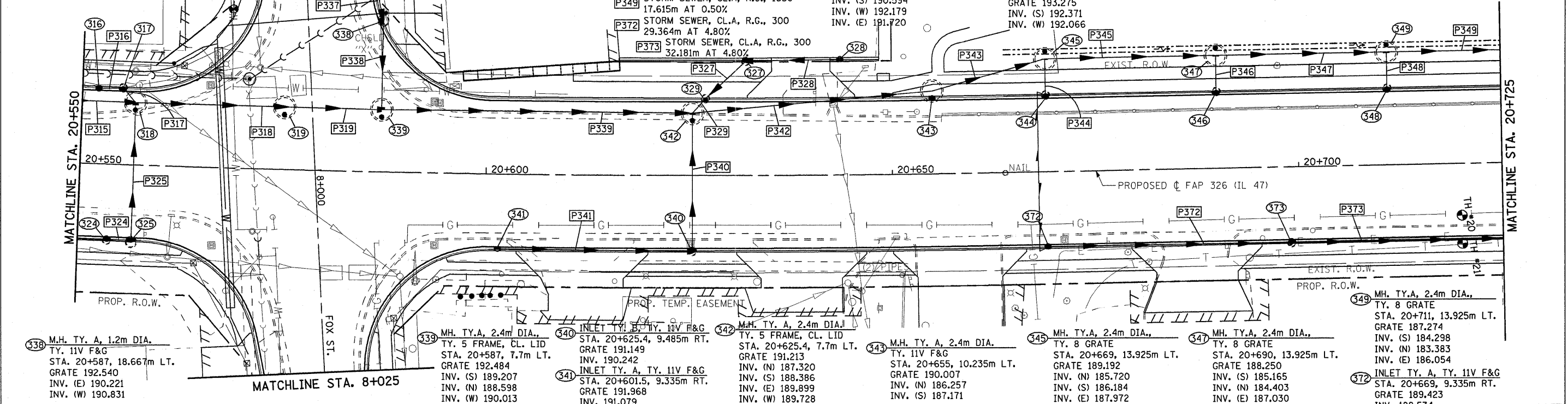
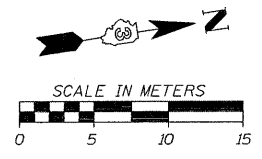

FILE: 419stwm47_16.dgn
PLOTTED: 8/22/2011

Sheet: 16
Angle: 81.7537
Color: P-1347

HMC JOB NO. 5122