

F.A.P. RTE.	SECTION	COUNTY	TOTAL SHEETS	SHEET NO.
326	(5CS,13C,108,109R)	KENDALL	931	421
STA.	TO STA.			
FED. ROAD DIST. NO.	ILLINOIS FED. AID PROJECT			

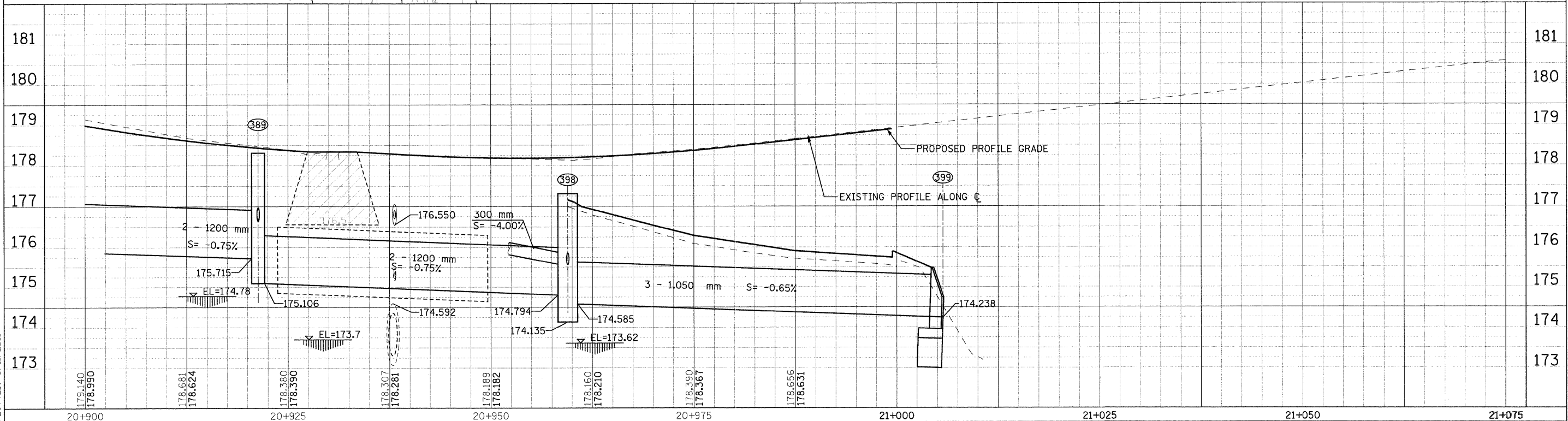
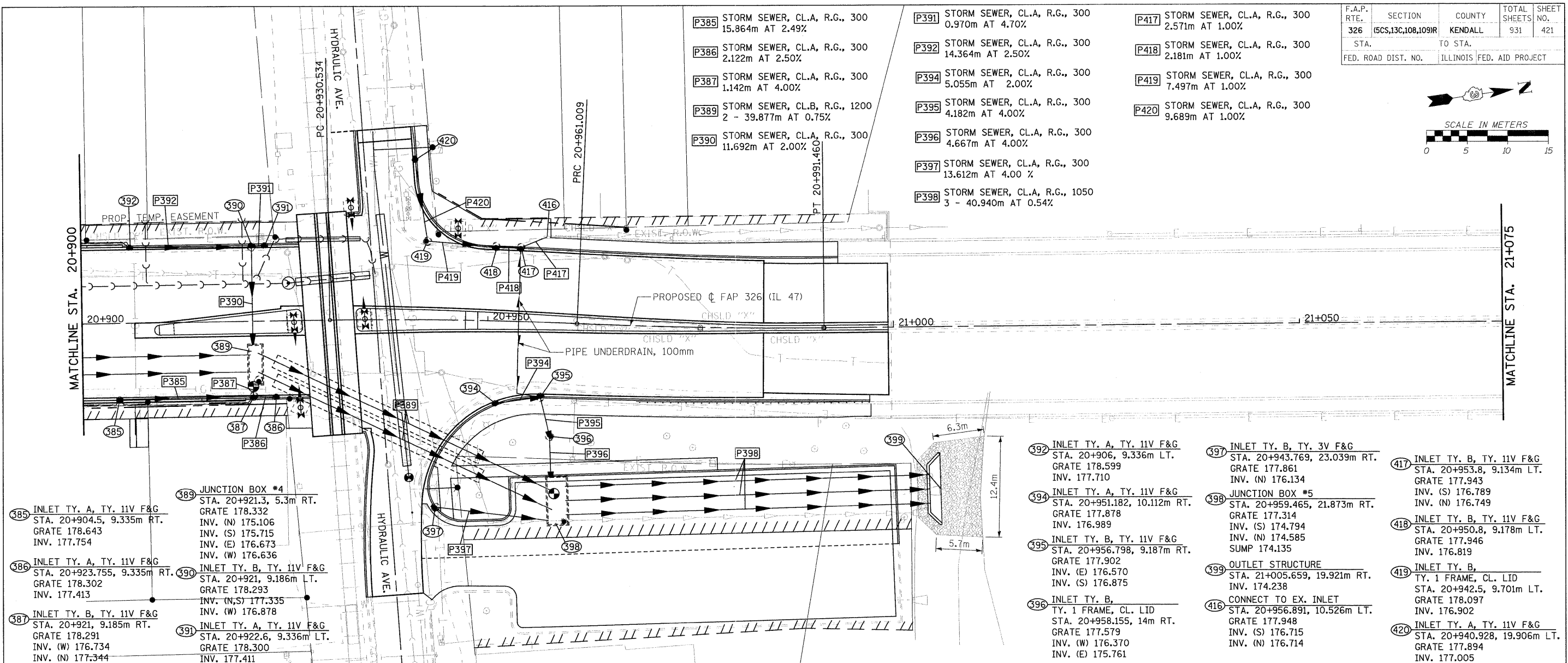
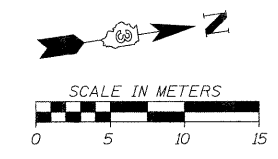

FILE: 421stn47_18.dgn
PLOTTED: 8/11/2011

Sheet 18
Angle: 01.0e1
Color: P.1a17

HMG JOB NO. 5122