

F.A.P. RTE.	SECTION	COUNTY	TOTAL SHEETS	SHEET NO.
326	(SCS,13C,108,109)R	KENDALL	931	450
STA.		TO STA.		
FED. ROAD DIST. NO.		ILLINOIS FED. AID PROJECT		

440 MH. TY. A, 1.2 m DIA.,
TY. 1 FRAME, CL. LID
STA. 1+068, 7.5m LT.
GRATE 191.402
INV. 189.799

441 INLET TY. B, TY. 3V F&G
STA. 1+068, 5.728m LT.
GRATE 191.085
INV. 189.966

442 INLET TY. A, TY. 3V F&G
STA. 1+068, 5.817m RT.
GRATE 191.086
INV. 190.197

443 MH. TY. A, 1.2 m DIA.,
TY. 3V F&G
STA. 1+028, 5.384m LT.
GRATE 191.320
INV. 190.200

444 MH. TY. A, 1.2m DIA.,
TY. 1 FRAME, CL. LID
STA. 1+018.5, 3.426m LT.
GRATE 191.405
INV. (W) 190.297
INV. (N) 190.400

445 INLET TY. A, TY. 3V F&G
STA. 1+018.5, 4.767m LT.
GRATE 191.453
INV. 190.564

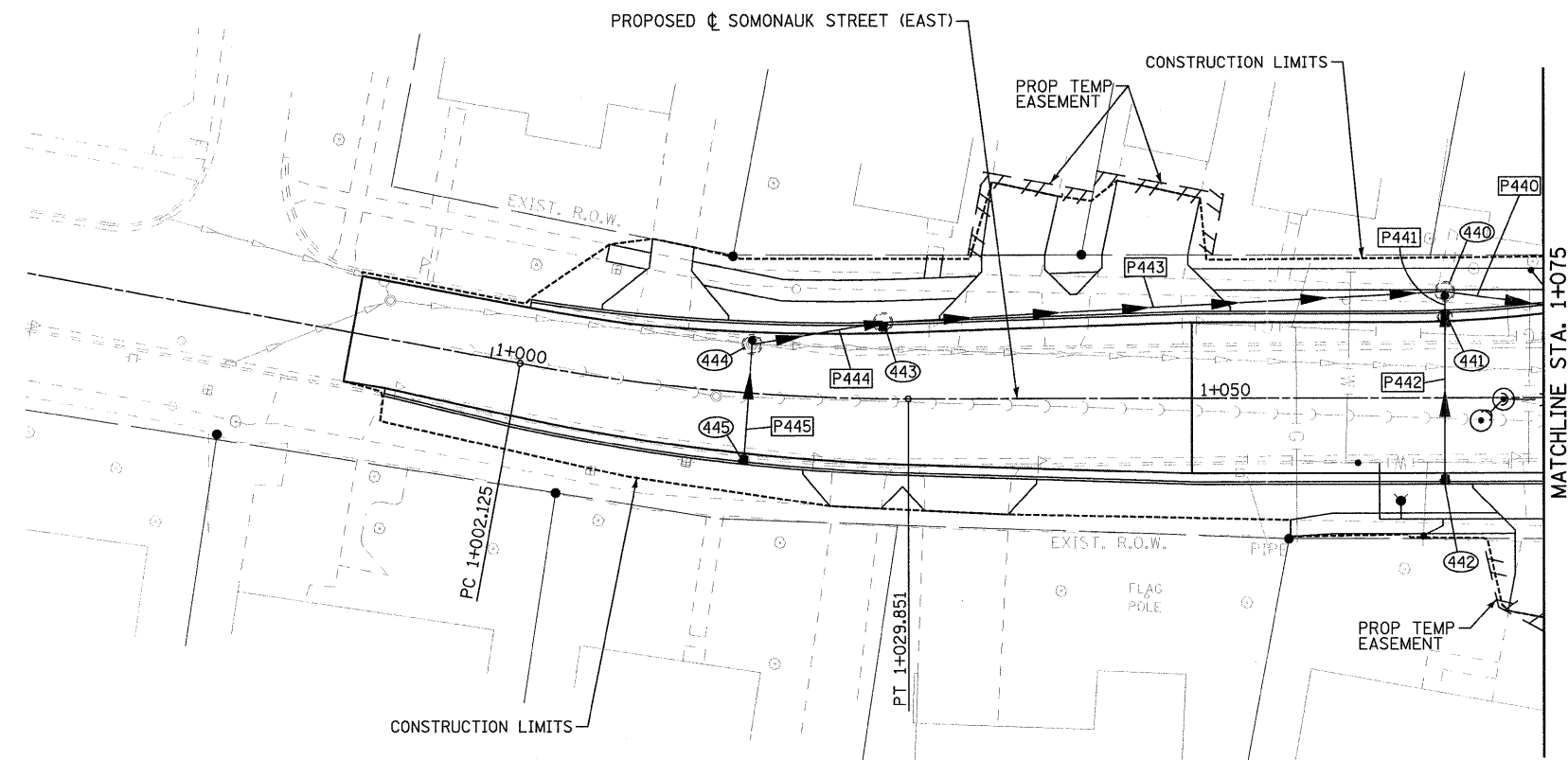

SEE IL RTE. 47 SHEET FOR STORM SEWER CONTINUATION

- P440 STORM SEWER, CL. A, R.G., 450
12.550m AT 2.00%
- P441 STORM SEWER, CL. A, R.G., 300
0.788m AT 2.00%
- P442 STORM SEWER, CL. A, R.G., 300
10.908m AT 2.00%
- P443 STORM SEWER, CL.A, R.G., 450
38.986m AT 1.00%
- P444 STORM SEWER, CL.A, R.G., 450
8.630m AT 1.00%
- P445 STORM SEWER, CL.A, R.G., 300
7.391m AT 2.00%

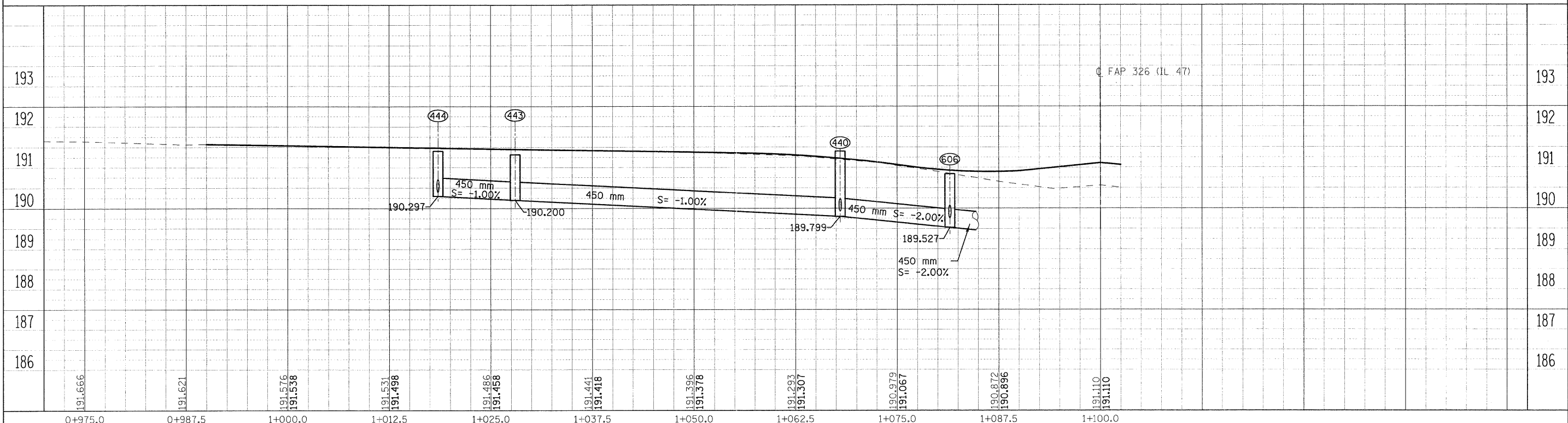
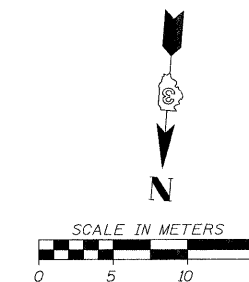

FILE: 450stnSomo.dgn
PLOTTED: 8/17/2011

HMC JOB NO. 5122