

F.A.P. RTE.	SECTION	COUNTY	TOTAL SHEETS	SHEET NO.
326	(5CS,13C,108,109)R	KENDALL	931	463
STA.	TO STA.			
FED. ROAD DIST. NO.	ILLINOIS FED. AID PROJECT			

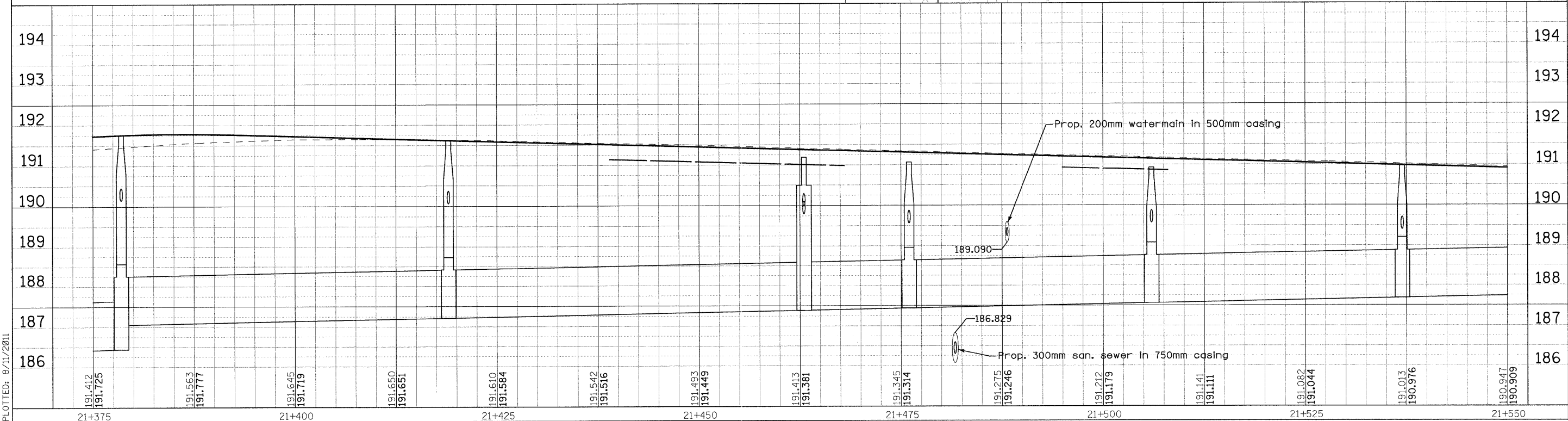
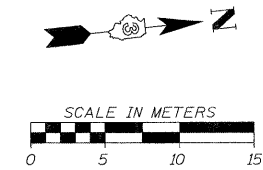
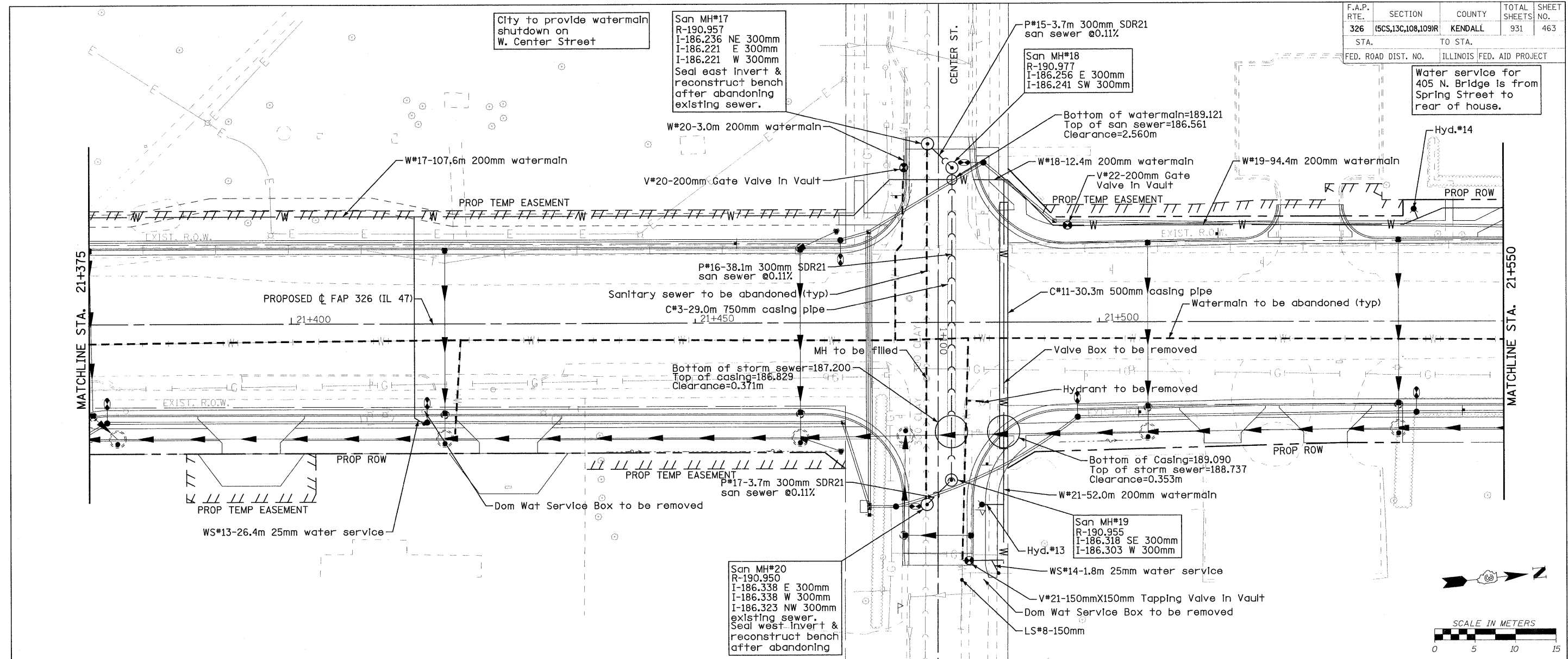

FILE: 463W&Spp\_21.dgn  
PLOTTED: 8/11/2011

Sheet: 21  
Angle: 83.9071  
Chain: P\_1147

HMC JOB NO. 5122