

F.A.P. RTE.	SECTION	COUNTY	TOTAL SHEETS	SHEET NO.
326	(6CS,13G,108,109R)	KENDALL	931	534
STA.	TO STA.			
FED. ROAD DIST. NO.	ILLINOIS FED. AID PROJECT			

LEGEND

- EXPANSION JOINT PER STD. 420001
- +--+ SAWED CONTRACTION JOINT PER STD. 420001
- SAWED LONGITUDINAL JOINT PER STD. 420001
- [Grid Pattern] PAVEMENT FABRIC
- XXX-XXX- PROPOSED SURFACE ELEVATION

STA. 20+831.394 C FAP 326 (IL 47) =
STA. 1+100 C VAN EMMON ST. W.

STA. 20+829.642 C FAP 326 (IL 47) =
STA. 1+100 C VAN EMMON ST. E

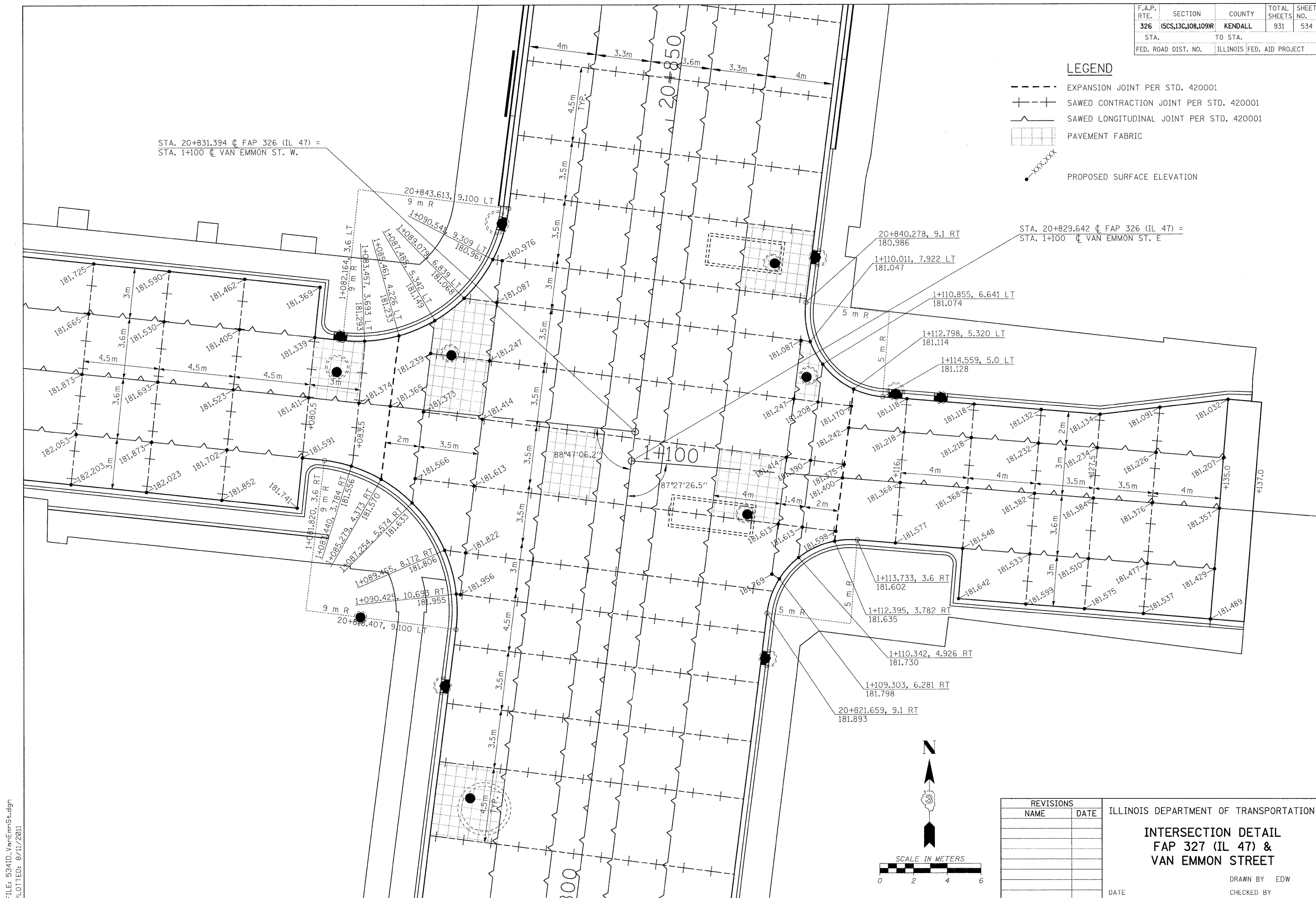

FILE: 5341D_VanEmmSt.dgn
PLOTTED: 8/11/2011

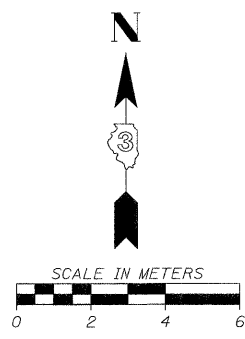

REVISIONS		ILLINOIS DEPARTMENT OF TRANSPORTATION
NAME	DATE	
		INTERSECTION DETAIL FAP 327 (IL 47) & VAN EMMON STREET DRAWN BY EDW CHECKED BY DATE

HMG JOB NO. 5122