

F.A.P. RTE.	SECTION	COUNTY	TOTAL SHEETS	SHEET NO.
326	(SCS,13C,108,109)R	KENDALL	931	541
STA.		TO STA.		
FED. ROAD DIST. NO.		ILLINOIS FED. AID PROJECT		

LEGEND

- EXPANSION JOINT PER STD. 420001
- +--+ SAWED CONTRACTION JOINT PER STD. 420001
- SAWED LONGITUDINAL JOINT PER STD. 420001
- ▭ PAVEMENT FABRIC
- PROPOSED SURFACE ELEVATION

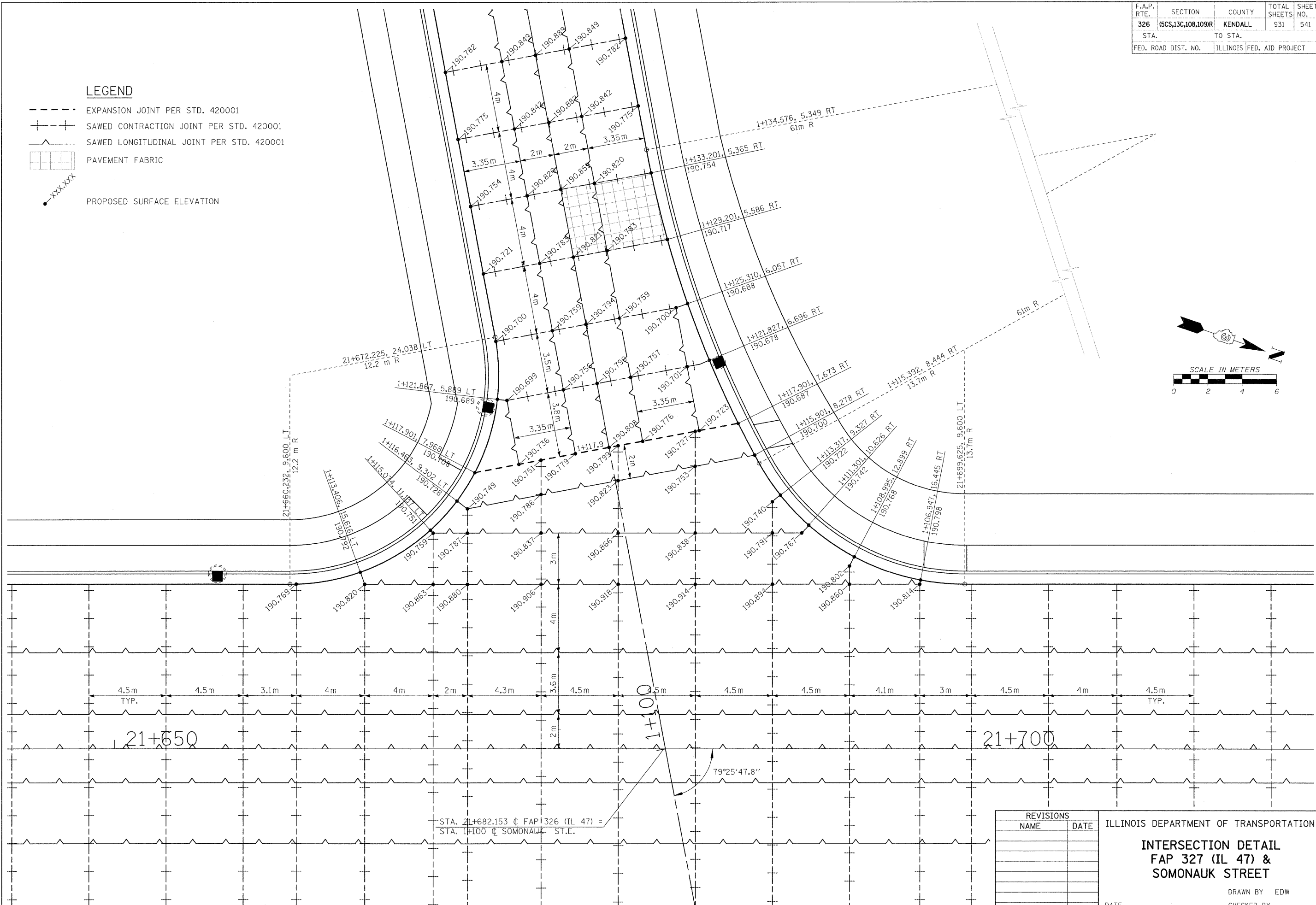

REVISIONS	
NAME	DATE

ILLINOIS DEPARTMENT OF TRANSPORTATION
INTERSECTION DETAIL
FAP 327 (IL 47) &
SOMONAUK STREET
 DRAWN BY EDW
 CHECKED BY
 DATE

FILE: 5411D_SomnkSt.dgn
 PLOTTED: 8/11/2011

HMG JOB NO. 5122