

F.A.P. RTE.	SECTION	COUNTY	TOTAL SHEETS	SHEET NO.
326	(SCS,13C,108,109)R	KENDALL	931	546
STA.		TO STA.		
FED. ROAD DIST. NO.		ILLINOIS FED. AID PROJECT		

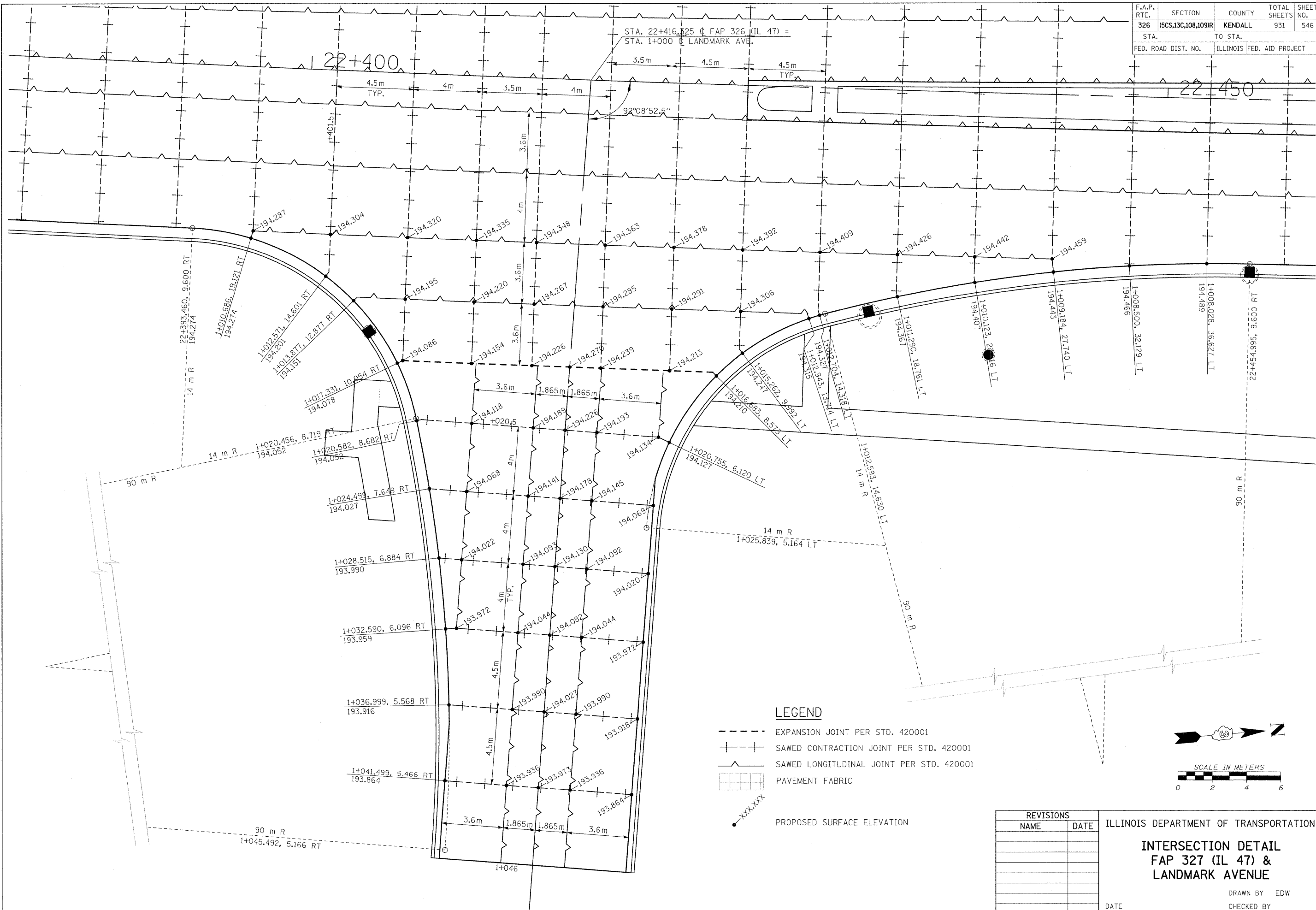

LEGEND

- EXPANSION JOINT PER STD. 420001
- + + + SAWED CONTRACTION JOINT PER STD. 420001
- SAWED LONGITUDINAL JOINT PER STD. 420001
- [Grid Pattern] PAVEMENT FABRIC
- XXX.XXX PROPOSED SURFACE ELEVATION

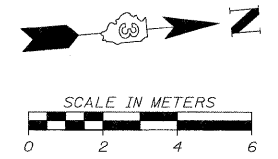

REVISIONS	
NAME	DATE

ILLINOIS DEPARTMENT OF TRANSPORTATION
INTERSECTION DETAIL
FAP 327 (IL 47) &
LANDMARK AVENUE
 DRAWN BY EDW
 CHECKED BY
 DATE

FILE: 5461D.Lndmk.dgn
PLOTTED: 8/11/2011

HMG JOB NO. 5122