

F.A.P. RTE.	SECTION	COUNTY	TOTAL SHEETS	SHEET NO.
326	(5CS,13C,108,109)R	KENDALL	931	565
STA.	TO STA.			
FED. ROAD DIST. NO.	ILLINOIS	FED. AID PROJECT		

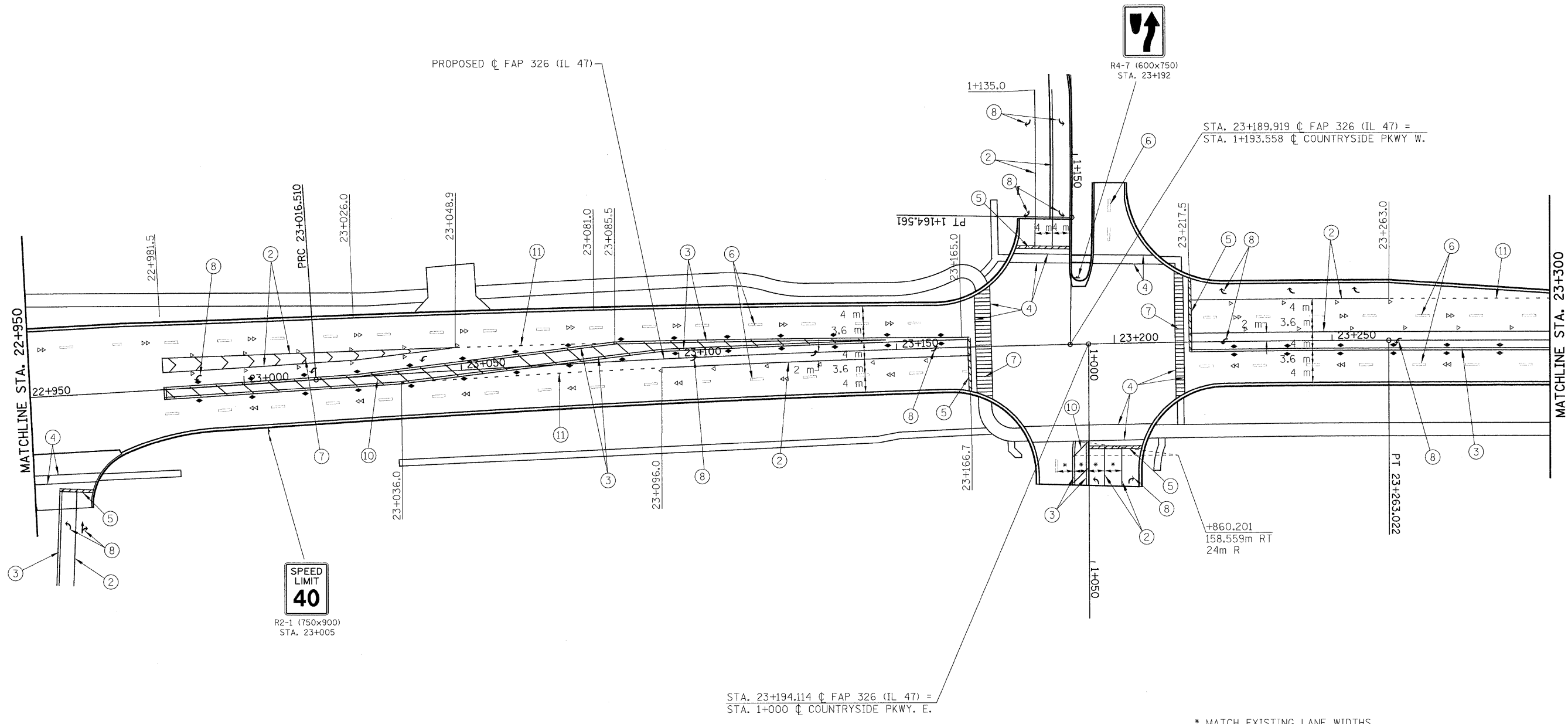

**PAVEMENT MARKING LEGEND**

- |                                |                             |
|--------------------------------|-----------------------------|
| ① 100 mm SOLID (YELLOW)        | ⑦ 300 mm SOLID (WHITE)      |
| ② 200 mm SOLID (WHITE)         | ⑧ LETTERS & ARROWS          |
| ③ 100 mm DOUBLE SOLID (YELLOW) | ⑨ 150 mm SKIP DASH (YELLOW) |
| ④ 150 mm SOLID (WHITE)         | ⑩ 300 mm SOLID (YELLOW)     |
| ⑤ 600 mm SOLID (WHITE)         | ⑪ 200 mm DOTTED (WHITE)     |
| ⑥ 150 mm SKIP DASH (WHITE)     | ⑫ 100 mm SOLID (WHITE)      |

**RAISED REFLECTIVE PAVEMENT MARKING**

- ◁ ONE-WAY CRYSTAL MARKER ON 12.2 m CENTERS
- ◆ TWO-WAY AMBER MARKER ON 12.2 m CENTERS
- ◀ ONE-WAY AMBER MARKER ON 12.2 m CENTERS

\* MATCH EXISTING LANE WIDTHS

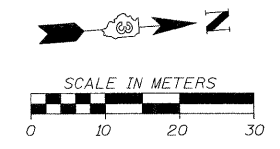

FILE: 565pm- & signs-47\_16.dgn  
PLOTTED: 8/11/2011

HMG JOB NO. 5122