

F.A.P. RTE.	SECTION	COUNTY	TOTAL SHEETS	SHEET NO.
326	(5CS,13C,108,109)R	KENDALL	931	569
STA.		TO STA.		
FED. ROAD DIST. NO.		ILLINOIS FED. AID PROJECT		

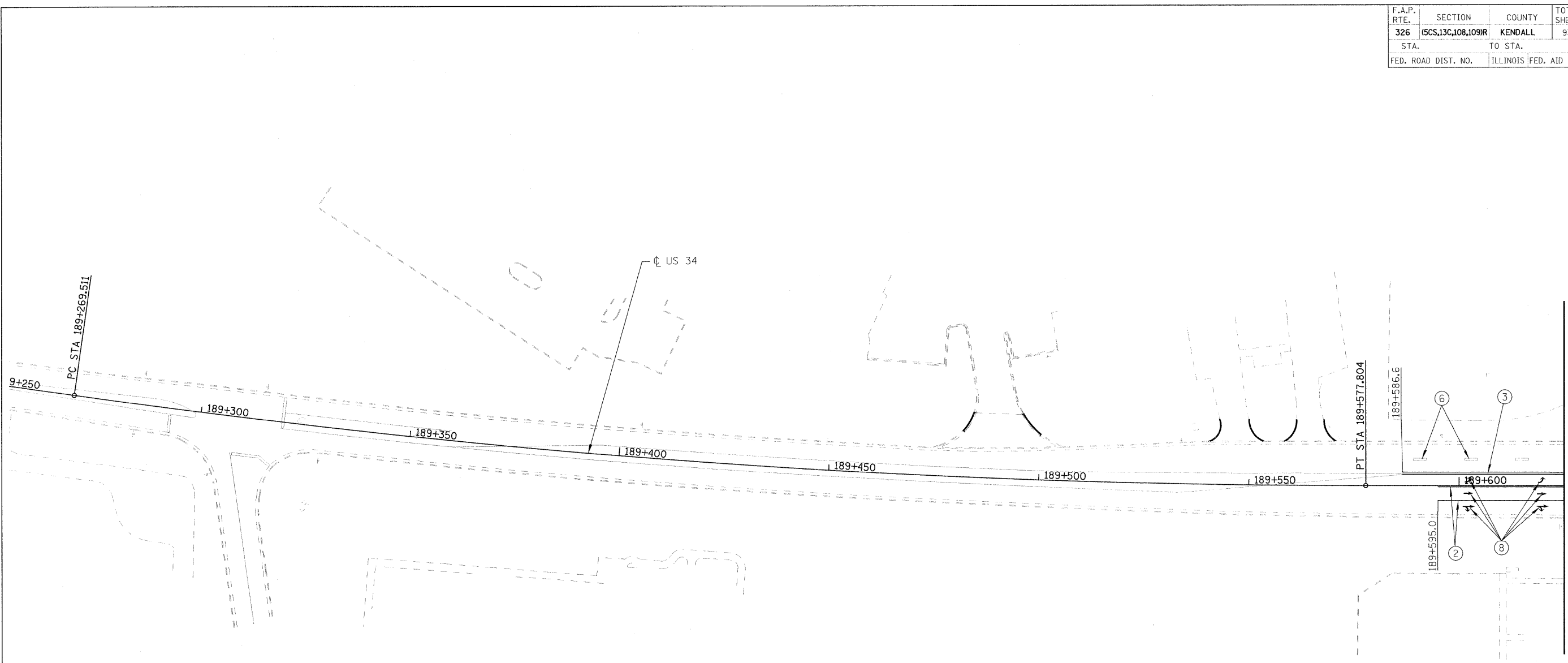

PAVEMENT MARKING LEGEND

- | | |
|--------------------------------|-----------------------------|
| ① 100 mm SOLID (YELLOW) | ⑦ 300 mm SOLID (WHITE) |
| ② 200 mm SOLID (WHITE) | ⑧ LETTERS & ARROWS |
| ③ 100 mm DOUBLE SOLID (YELLOW) | ⑨ 150 mm SKIP DASH (YELLOW) |
| ④ 150 mm SOLID (WHITE) | ⑩ 300 mm SOLID (YELLOW) |
| ⑤ 600 mm SOLID (WHITE) | ⑪ 200 mm DOTTED (WHITE) |
| ⑥ 150 mm SKIP DASH (WHITE) | ⑫ 100 mm SOLID (WHITE) |

RAISED REFLECTIVE PAVEMENT MARKING

- ◁ ONE-WAY CRYSTAL MARKER ON 12.2 m CENTERS
- ◆ TWO-WAY AMBER MARKER ON 12.2 m CENTERS
- ◀ ONE-WAY AMBER MARKER ON 12.2 m CENTERS

FILE: 569pm_&_signs_34_01.dgn
PLOTTED: 8/11/2011

HMG JOB NO. 5122