

F.A.P. RTE.	SECTION	COUNTY	TOTAL SHEETS	SHEET NO.
326		KENDALL	931	611
STA. N/A		TO STA. N/A		
FED. ROAD DIST. NO. 5		ILLINOIS FED. AID PROJECT		

TEMPORARY TRAFFIC SIGNAL LEGEND

- TEMPORARY CONTROLLER AND CABINET
- TEMPORARY TRAFFIC SIGNAL HEAD WITH BACKPLATE
- TEMPORARY PEDESTRIAN PUSH-BUTTON
- TEMPORARY PED. SIGNAL HEAD, BRACKET MOUNTED
- VIDEO DETECTION SYSTEM
- TEMPORARY WOOD POLE (CLASS 5) 14 m MINIMUM
- TEMPORARY SPAN WIRE, TETHER WIRE AND CABLE
- GUY WIRES
- TEMPORARY LUMINAIRE, SODIUM VAPOR, 400 WATT

EXISTING SIGNAL LEGEND

- HANDHOLE
- DOUBLE HANDHOLE
- MAST ARM ASSEMBLY AND POLE
- CONTROLLER
- SIGNAL POST

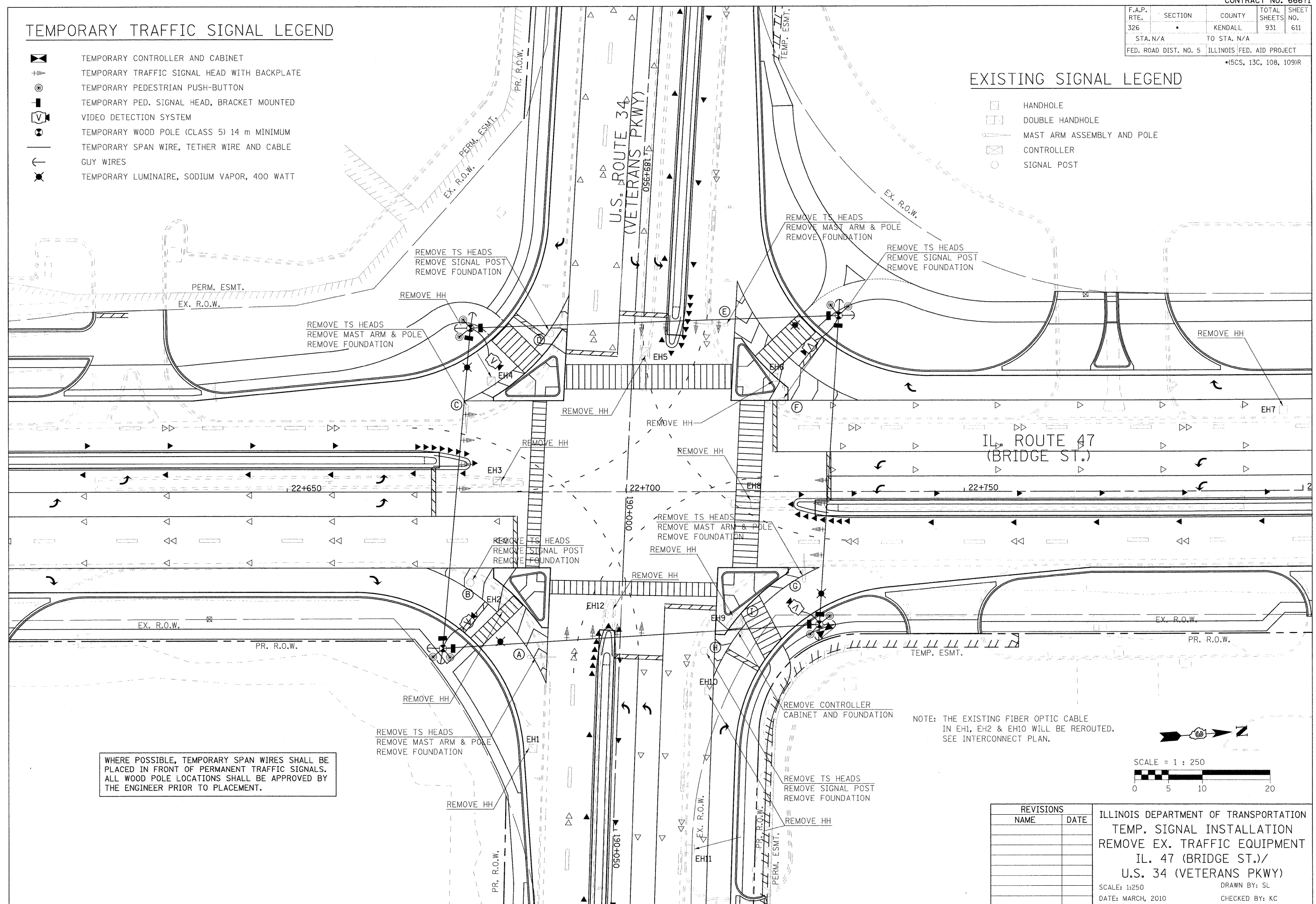

WHERE POSSIBLE, TEMPORARY SPAN WIRES SHALL BE PLACED IN FRONT OF PERMANENT TRAFFIC SIGNALS. ALL WOOD POLE LOCATIONS SHALL BE APPROVED BY THE ENGINEER PRIOR TO PLACEMENT.

NOTE: THE EXISTING FIBER OPTIC CABLE IN EH1, EH2 & EH10 WILL BE REROUTED. SEE INTERCONNECT PLAN.

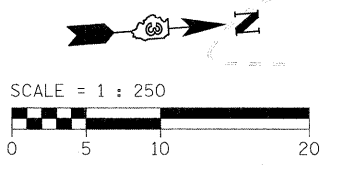

REVISIONS	
NAME	DATE

ILLINOIS DEPARTMENT OF TRANSPORTATION
 TEMP. SIGNAL INSTALLATION
 REMOVE EX. TRAFFIC EQUIPMENT
 IL. 47 (BRIDGE ST.)/
 U.S. 34 (VETERANS PKWY)
 SCALE: 1:250
 DATE: MARCH, 2010
 DRAWN BY: SL
 CHECKED BY: KC

PLOT DATE = 8/17/2011
 FILE NAME = h:\15122\design\611-6131134_r.mxd
 PLOT SCALE = 6:3600 in / in
 USER NAME = JBERDESOP.