

F.A.P. RTE.	SECTION	COUNTY	TOTAL SHEETS	SHEET NO.
326	(5CS,13C,108,109)R	KENDALL	931	702
STA. 18+750.000		TO STA. 18+780.000		
FED. ROAD DIST. NO.		ILLINOIS FED. AID PROJECT		

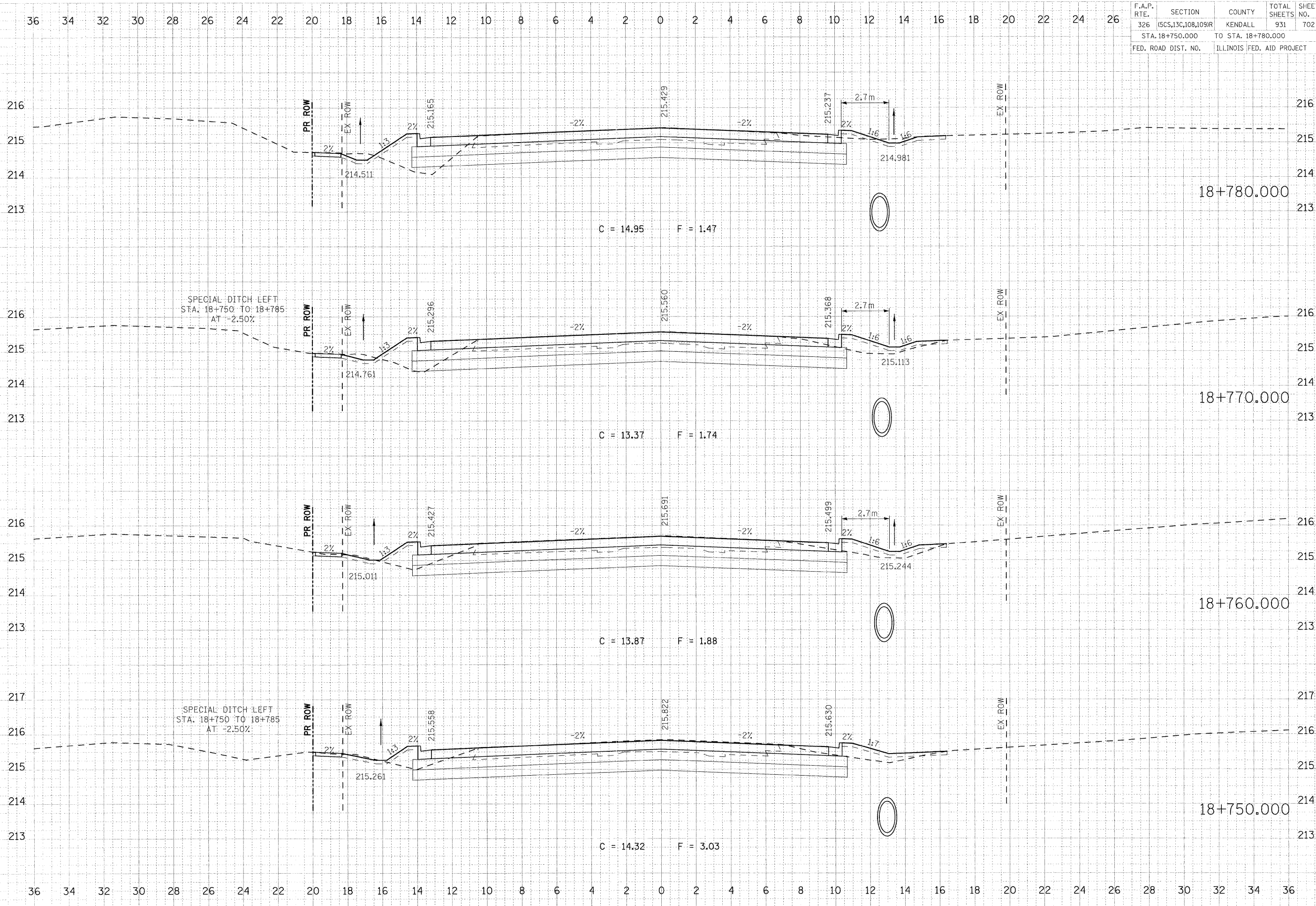

FINAL SURVEY PLOTTED  
 NOTE BOOK AREAS CHECKED  
 NO. \_\_\_\_\_

ORIGINAL SURVEY PLOTTED  
 NOTE BOOK AREAS CHECKED  
 NO. \_\_\_\_\_

PLOT DATE = 07/26/2011  
 FILE NAME = 693-792XS Sta 18+750.dgn  
 PLOT SCALE = 0.1200" = 1' / MM.  
 USER NAME = USERDESCR