

F.A.P. RTE.	SECTION	COUNTY	TOTAL SHEETS	SHEET NO.
326	5CS,13C,108,109R	KENDALL	931	703
STA. 18+783.292		TO STA. 18+810.000		
FED. ROAD DIST. NO.		ILLINOIS FED. AID PROJECT		

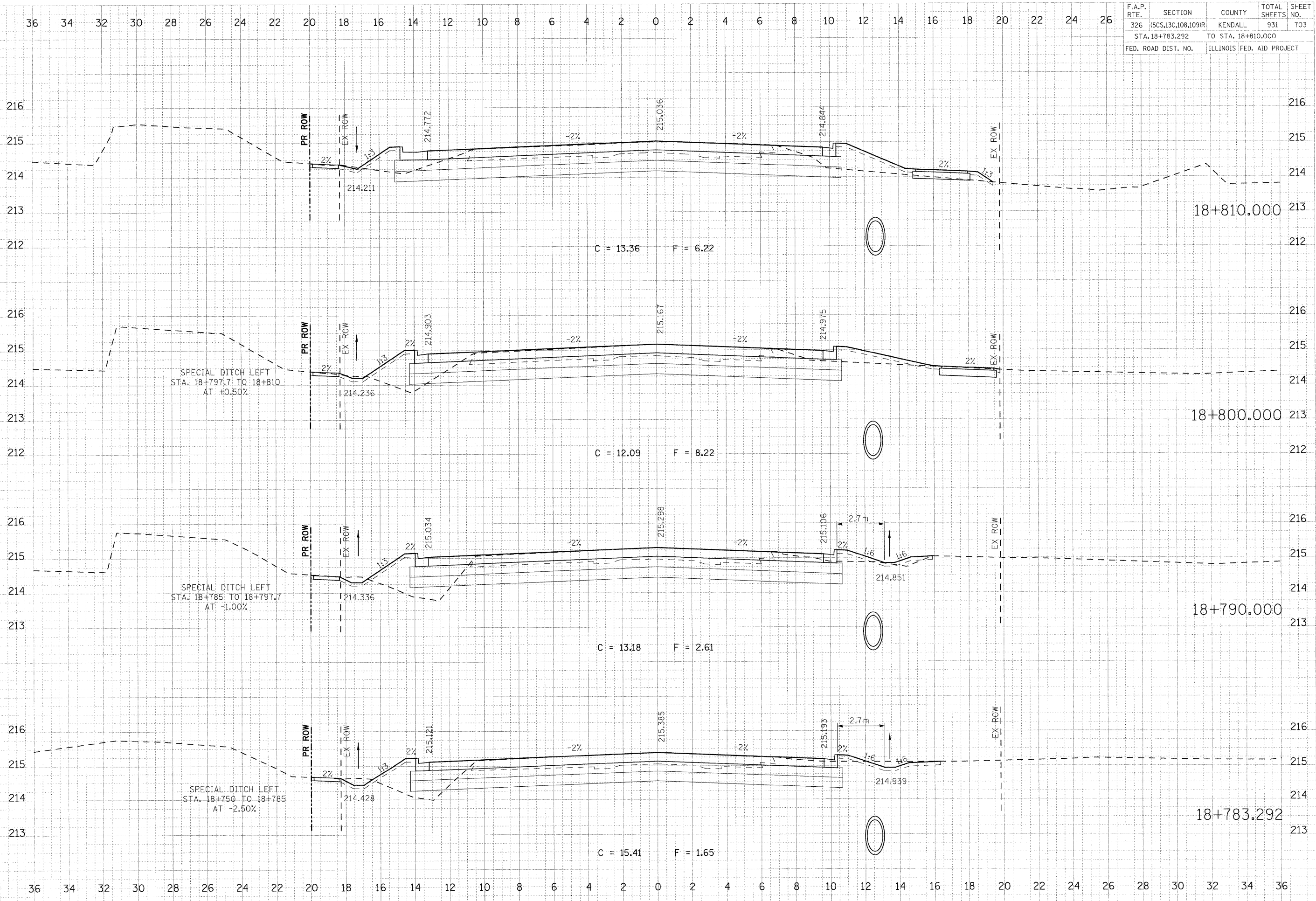

FINAL SURVEY PLOTTED DATE: 07/26/2011
 NOTE BOOK: 013008
 AREA: 47s
 USER: USERDESCR

DATE: 07/26/2011
 SURVEY: 07/26/2011
 NOTE BOOK: 013008
 AREA: 47s
 USER: USERDESCR

PLOT DATE = 07/26/2011
 PLOT NAME = 013008_47s.dgn
 PLOT SCALE = 1:1000
 USER NAME = USERDESCR