

F.A.P. RTE.	SECTION	COUNTY	TOTAL SHEETS	SHEET NO.
326	(SCS,13C,108,109)R	KENDALL	931	707
STA. 18+900.000		TO STA. 18+930.000		
FED. ROAD DIST. NO.		ILLINOIS FED. AID PROJECT		

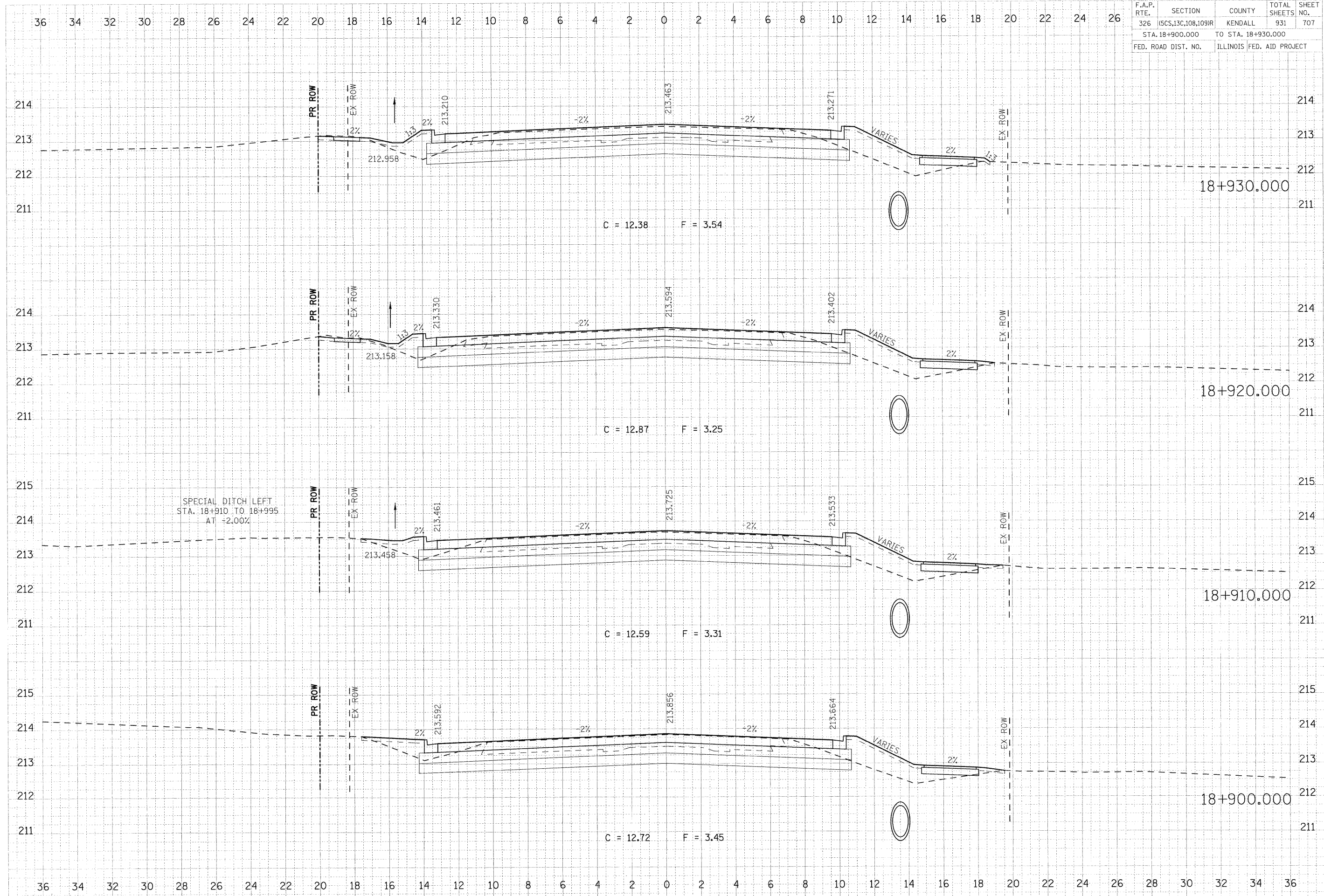

FINAL SURVEYED BY DATE
 SURVEYED BY DATE
 NOTE BOOK TEMPLATE
 AREAS CHECKED
 AREAS CHECKED

ORIGINAL SURVEYED BY DATE
 SURVEYED BY DATE
 NOTE BOOK TEMPLATE
 AREAS CHECKED
 AREAS CHECKED

PLOT DATE = 07/26/2001
 FILE NAME = 610762X6.MNF_47.dgn
 USER NAME = JSEBRESOR