

F.A.P. RTE.	SECTION	COUNTY	TOTAL SHEETS	SHEET NO.
326	(5CS,13C,108,109)R	KENDALL	931	734
STA. 19+840.000		TO STA. 19+870.000		
FED. ROAD DIST. NO.		ILLINOIS FED. AID PROJECT		

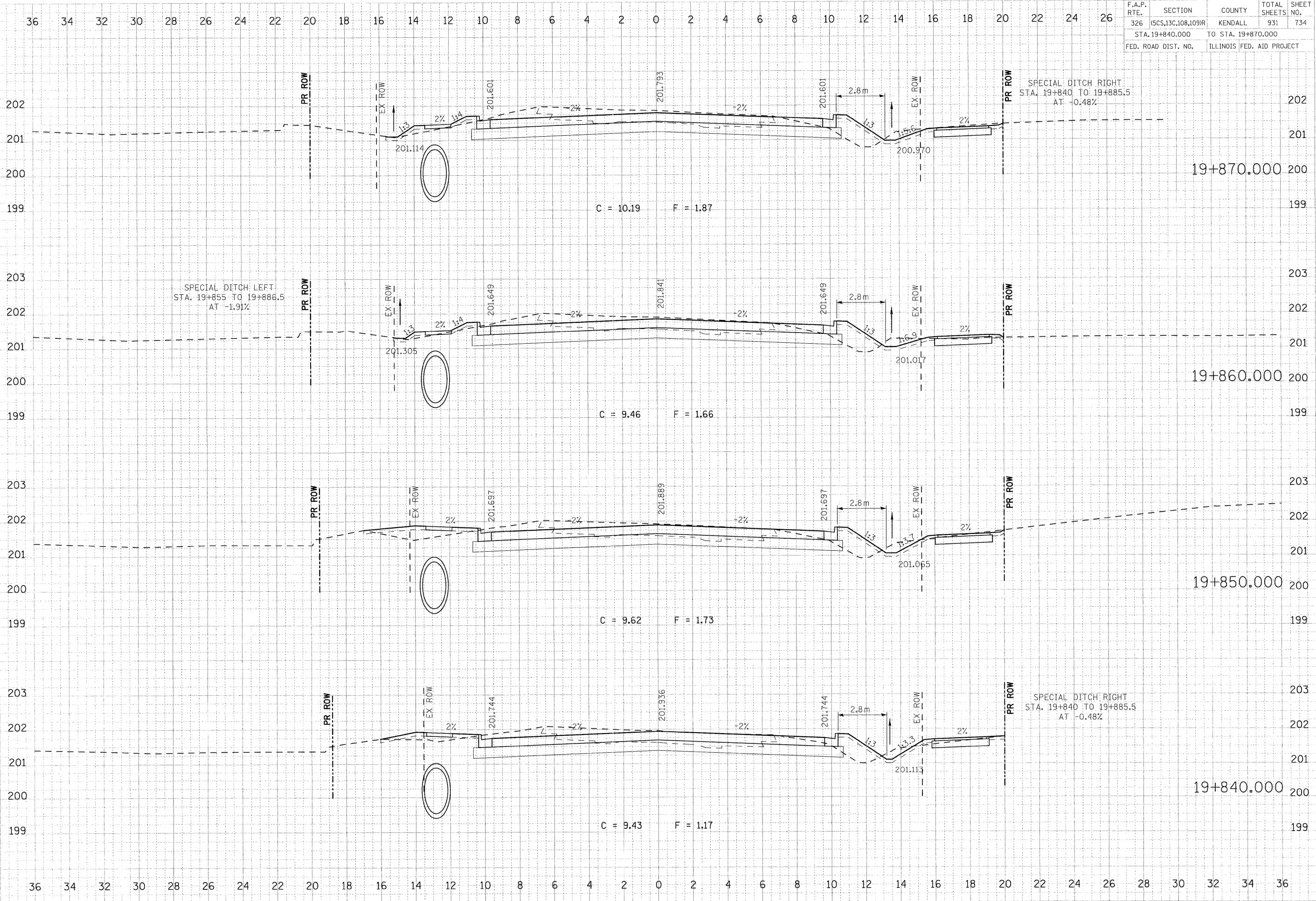

FINAL  
 SURVEY  
 NOTE BOOK  
 AREAS  
 CHECKED

ORIGINAL  
 SURVEY  
 NOTE BOOK  
 AREAS  
 CHECKED

PLOT DATE = 07/26/2011  
 FILE NAME = 676226-1147-47a.dgn  
 PLOT SCALE = 1"=100'  
 USER NAME = JUSERDESCR