

F.A.P. RTE.	SECTION	COUNTY	TOTAL SHEETS	SHEET NO.
326	(SCS,13C,108,109)R	KENDALL	931	735
STA. 19+880.000		TO STA. 19+900.000		
FED. ROAD DIST. NO.		ILLINOIS FED. AID PROJECT		

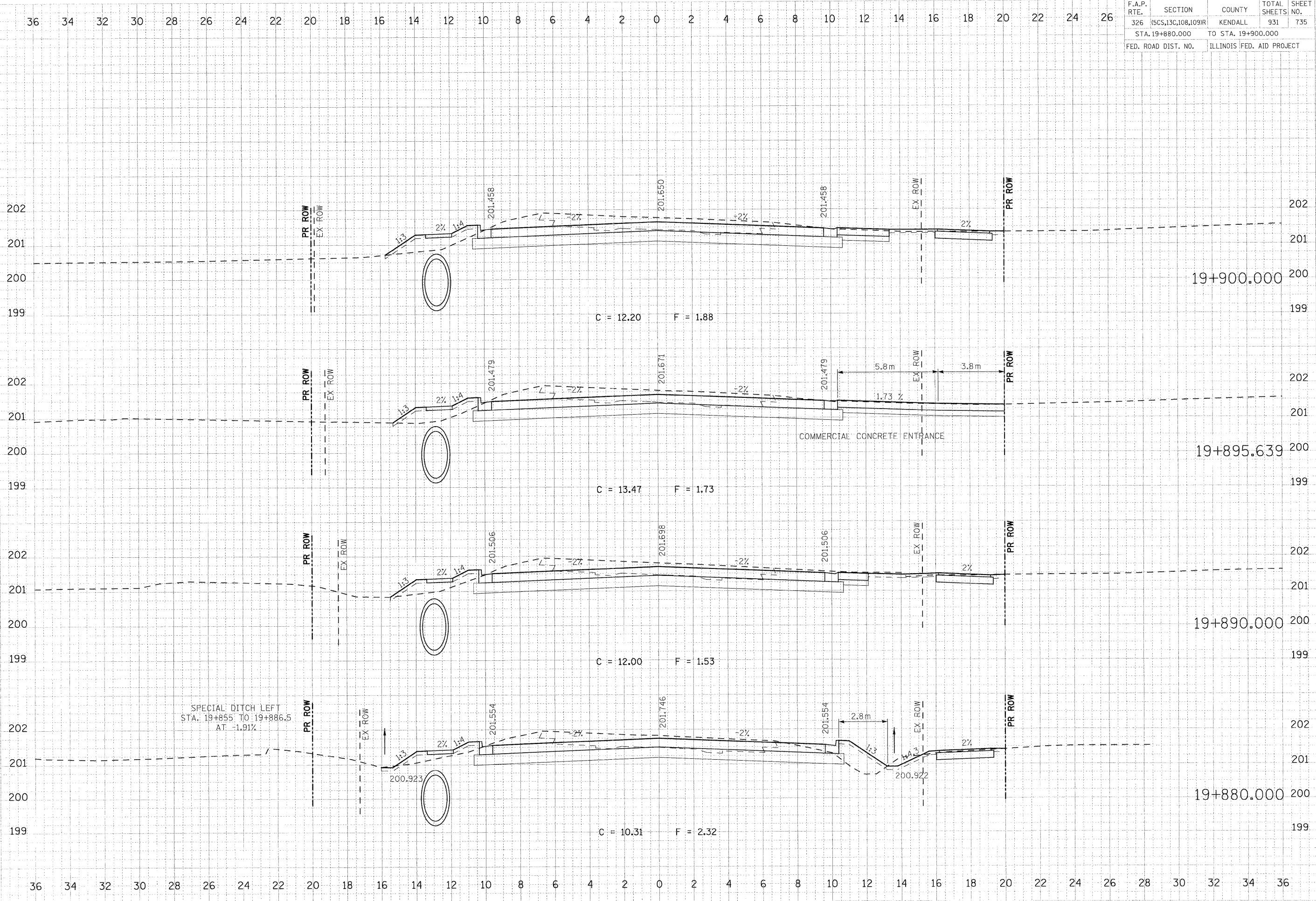

FINAL SURVEYED BY DATE  
 SURVEYED BY DATE  
 NOTE BLOCK AREAS CHECKED  
 NO. AREAS CHECKED

ORIGINAL SURVEYED BY DATE  
 SURVEYED BY DATE  
 NOTE BLOCK AREAS CHECKED  
 NO. AREAS CHECKED

PLOT DATE = 07/26/2011  
 FILE NAME = 593782X6.sht\_47a.dgn  
 SCALE = 1:1000  
 USER NAME = JUSERESOR