

F.A.P. RTE.	SECTION	COUNTY	TOTAL SHEETS	SHEET NO.
326	(SCS,13C,108,109)R	KENDALL	931	775
STA. 20+790.000		TO STA. 20+800.000		
FED. ROAD DIST. NO.		ILLINOIS FED. AID PROJECT		

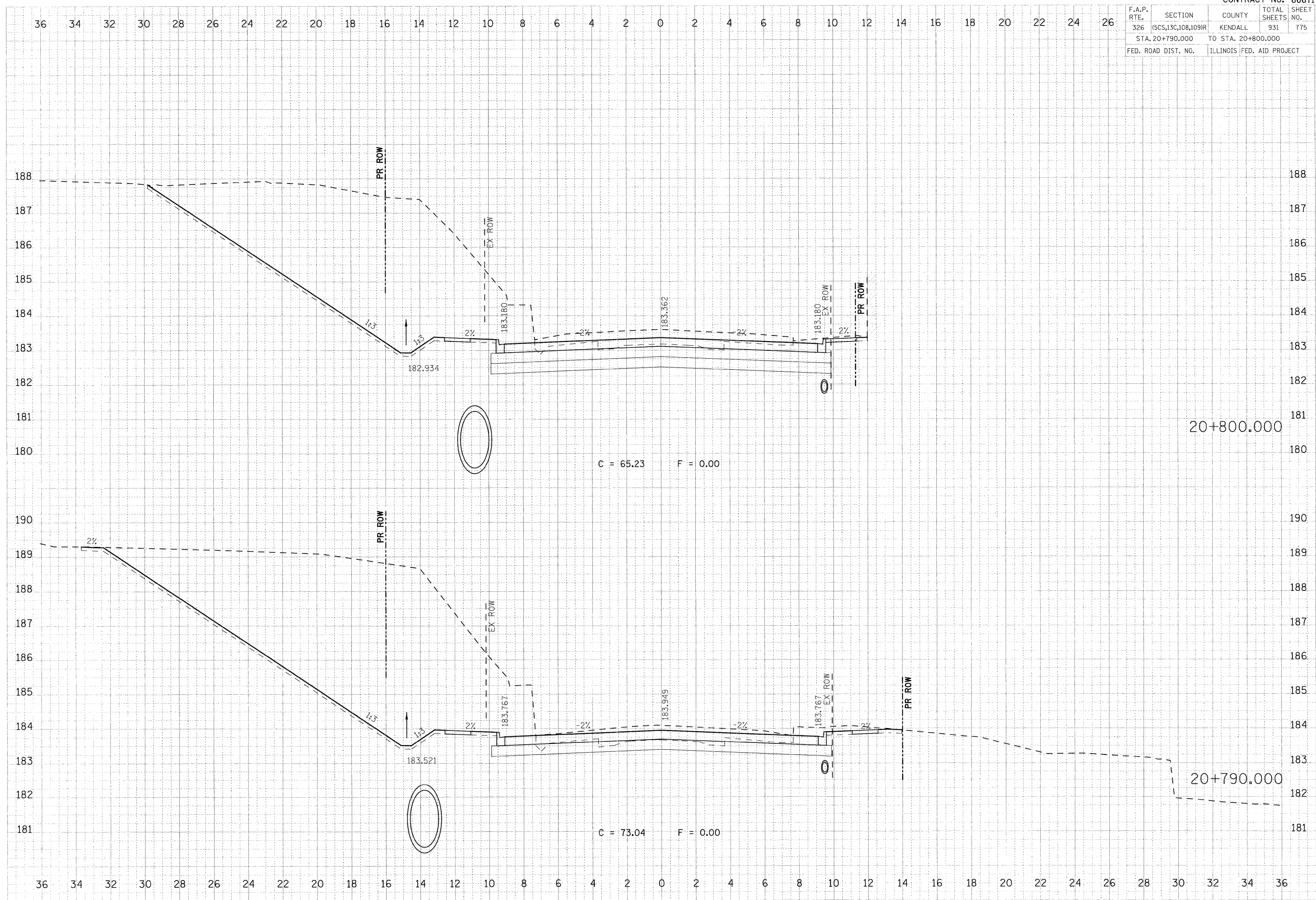

FINAL	DATE
SUPPLY	
REVISION	
NO.	

ORIGINAL	DATE
SUPPLY	
REVISION	
NO.	

PLOT DATE = 07/26/2011  
 FILE NAME = 603-7925.dwg  
 PLOT SCALE = 0.1000 / MM.  
 USER NAME = USERDESCR