

F.A.P. RTE.	SECTION	COUNTY	TOTAL SHEETS	SHEET NO.
326	(SCS,13C,108,109)R	KENDALL	931	808
STA. 21+758.439		TO STA. 21+770.000		
FED. ROAD DIST. NO.		ILLINOIS FED. AID PROJECT		

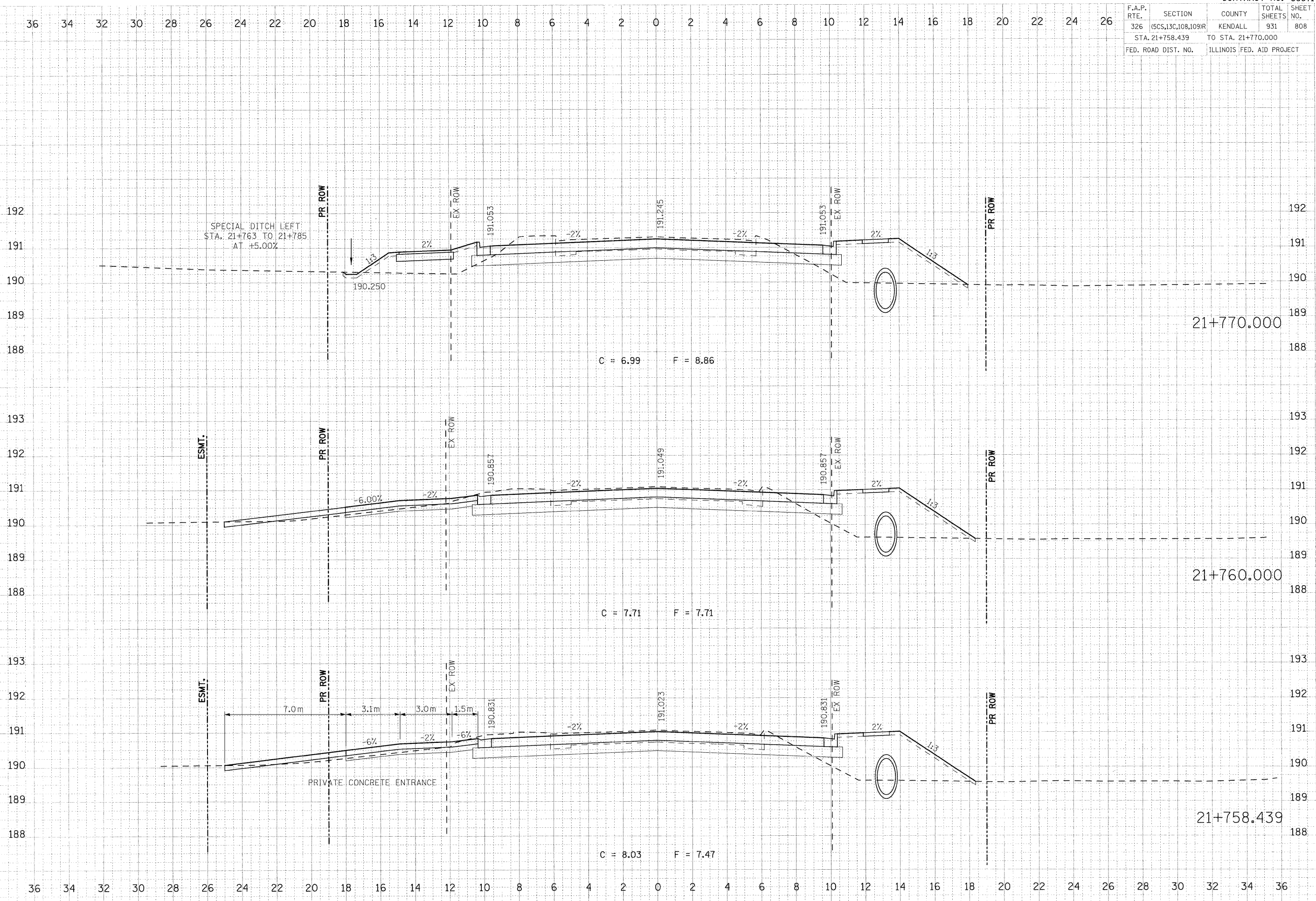

FINAL	DATE
REVISED	BY
NOTED	
APPROVED	
CHECKED	
DESIGNED	
DRAWN	

ORIGINAL	DATE
REVISED	BY
NOTED	
APPROVED	
CHECKED	
DESIGNED	
DRAWN	

PLOT DATE = 07/05/2011
 PLOT NAME = C:\ASST\ASST\47n.dgn
 PLOT SCALE = 0.1000 @ 1" = 10'
 USER NAME = USERDESCR.