

DETAIL 1: S.E. PLAN VIEW

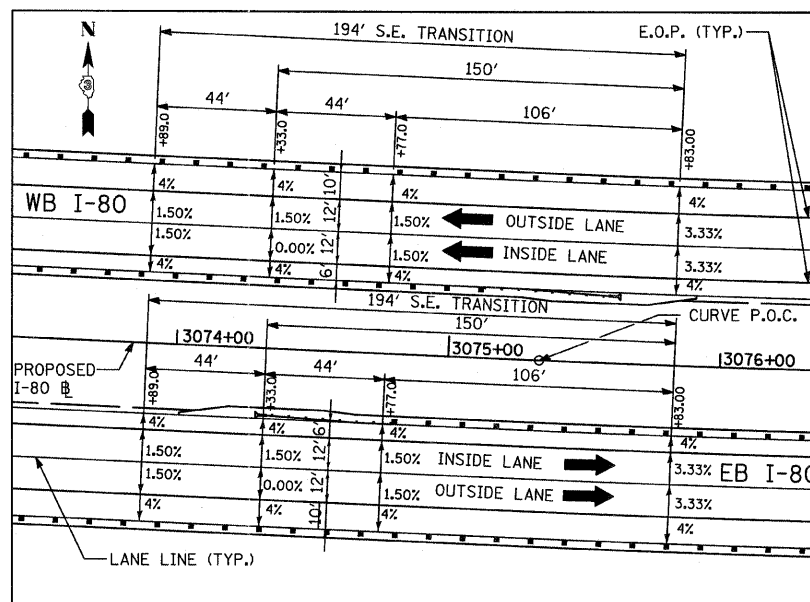

DETAIL 2: S.E. PLAN VIEW

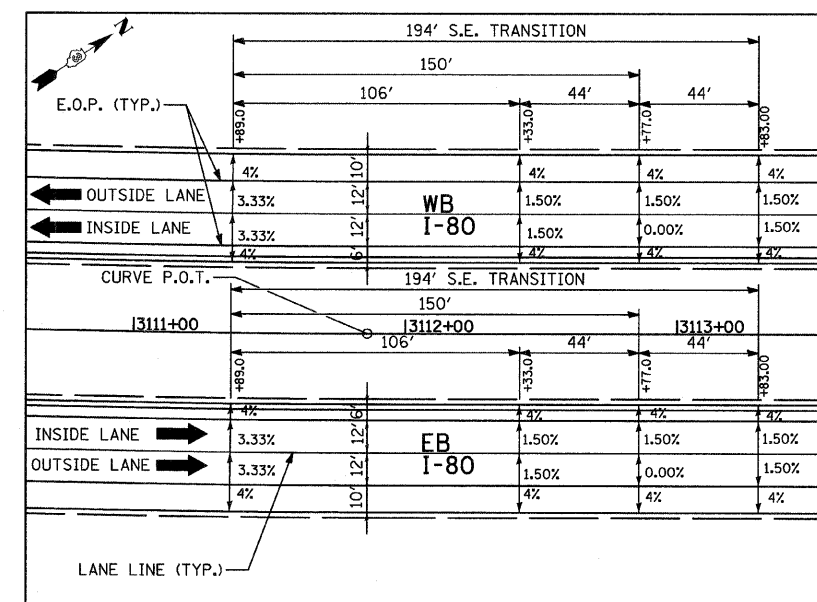

DETAIL 3: S.E. PLAN VIEW

SUPERELEVATION TRANSITION TABLE

DIRECTION OF TRAVEL	BEGINNING STATION OF TRANSITION	INSIDE LANE CROSS SLOPE (%)	OUTSIDE LANE CROSS SLOPE (%)	LANE(S) ROTATING	SUPERELEVATION "e" (%)	LANE(S) WIDTH W (FT)	SUPERELEVATION TRANSITION LENGTH (FT)	TANGENT RUNOUT DISTANCE (FT)	SUPERELEVATION RUNOUT LENGTH (FT)	ENDING STATION OF TRANSITION	TRANSITION DESCRIPTION
WB I-80	3061+51.00	-1.50	+1.50	OUTSIDE	1.50	12	90	45	45	3062+41.00	SUPERELEVATED TO NORMAL CROWN - SEE DETAIL 1
EB I-80	3061+51.00	+1.50	-1.50	INSIDE	1.50	12	90	45	45	3062+41.00	SUPERELEVATED TO NORMAL CROWN - SEE DETAIL 1
WB I-80	3073+89.00	-1.50	-1.50	INSIDE AND OUTSIDE	3.33	12	194	44	150	3075+83.00	NORMAL CROWN TO SUPERELEVATED - SEE DETAIL 2
EB I-80	3073+89.00	-1.50	-1.50	INSIDE AND OUTSIDE	3.33	12	194	44	150	3075+83.00	NORMAL CROWN TO SUPERELEVATED - SEE DETAIL 2
WB I-80	3111+36.00	+3.33	-3.33	INSIDE AND OUTSIDE	3.33	12	194	44	150	3113+30.00	SUPERELEVATED TO NORMAL CROWN - SEE DETAIL 3
EB I-80	3111+36.00	-3.33	+3.33	INSIDE AND OUTSIDE	3.33	12	194	44	150	3113+30.00	SUPERELEVATED TO NORMAL CROWN - SEE DETAIL 3

LEGEND

- ➔ DIRECTION OF TRAVEL
- X.XX% CROSS SLOPE IN PERCENT/
DIRECTION OF CROSS SLOPE

TYLIN INTERNATIONAL	USER NAME =	DESIGNED - CAC	REVISED -	STATE OF ILLINOIS DEPARTMENT OF TRANSPORTATION	F.A.I. ROUTE 80 (I-80) SUPERELEVATION DETAILS	F.A.I. RTE.	SECTION	COUNTY	TOTAL SHEETS	SHEET NO.
	PLOT SCALE =	DRAWN - CAC	REVISED -			80	(106-5)HBR-1.VBR(06-6)JRS-3&I	BUREAU	249	178
	PLOT DATE =	CHECKED - JDF	REVISED -			CONTRACT NO. 66686				
		DATE - 9/7/2011	REVISED -			FED. ROAD DIST. NO.	ILLINOIS FED. AID PROJECT			
SCALE: NONE					SHEET NO. 1 OF 1 SHEET	STA. TO STA.				