

DATE	
BY	
DESIGNED	
DRAWN	
CHECKED	
DATE	
REVISIONS	
NO.	
FINAL SURVEY	
NOTE BOOK	
NO.	
AREAS CHECKED	

DATE	
BY	
DESIGNED	
DRAWN	
CHECKED	
DATE	
REVISIONS	
NO.	
ORIGINAL SURVEY	
NOTE BOOK	
NO.	
AREAS CHECKED	

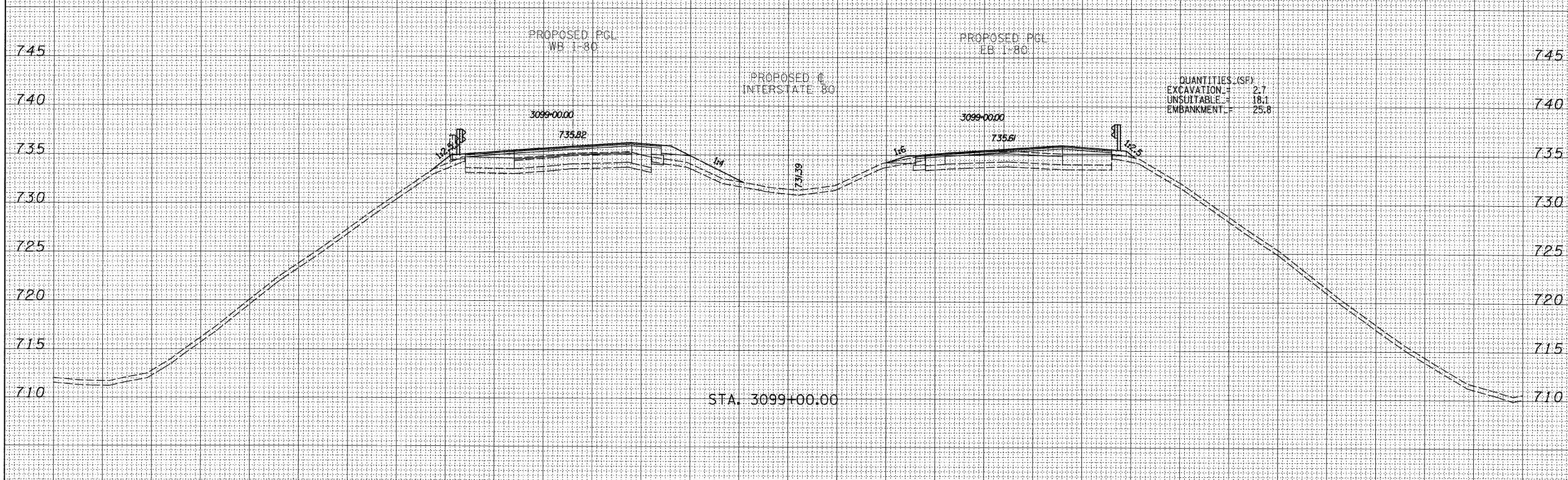
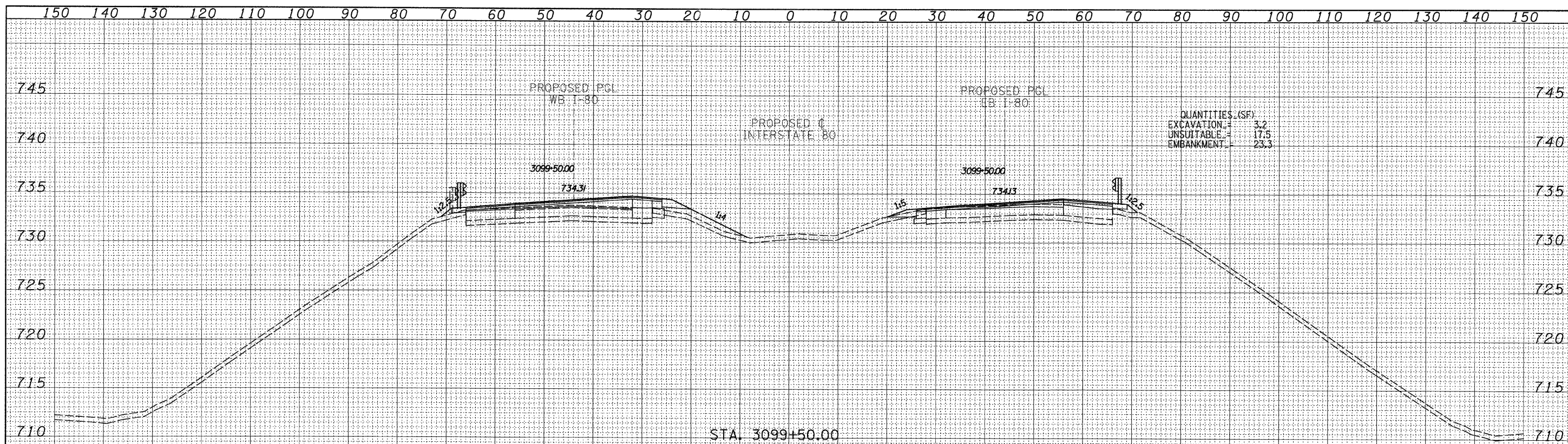

TYLIN INTERNATIONAL	USER NAME =	DESIGNED - JDF	REVISED -	STATE OF ILLINOIS DEPARTMENT OF TRANSPORTATION	F.A.I. ROUTE 80 (I-80) PROPOSED CROSS SECTIONS	F.A.I. RTE.	SECTION	COUNTY	TOTAL SHEETS	SHEET NO.
	PLOT SCALE =	DRAWN - JDF	REVISED -			80	(06-5)HBR-1.VBR(06-6)RS-3&I	BUREAU	249/196	CONTRACT NO. 66686
	PLOT DATE =	CHECKED - JPM	REVISED -	SCALE: 1" = 10'	SHEET NO. OF SHEETS	STA. 3099+00.00 TO STA. 3099+50.00		FED. ROAD DIST. NO. ILLINOIS FED. AID PROJECT		
		DATE - 9/7/2011	REVISED -							

P:\602429.1(I-80)\Road\602429.10_A\36686-sht-xssht.dgn