

FINAL SURVEY	DATE
SURVEYED	BY
NOTE BOOK	
TEMPLATE	
AREAS CHECKED	
NO.	

ORIGINAL SURVEY	DATE
SURVEYED	BY
NOTE BOOK	
TEMPLATE	
AREAS CHECKED	
NO.	

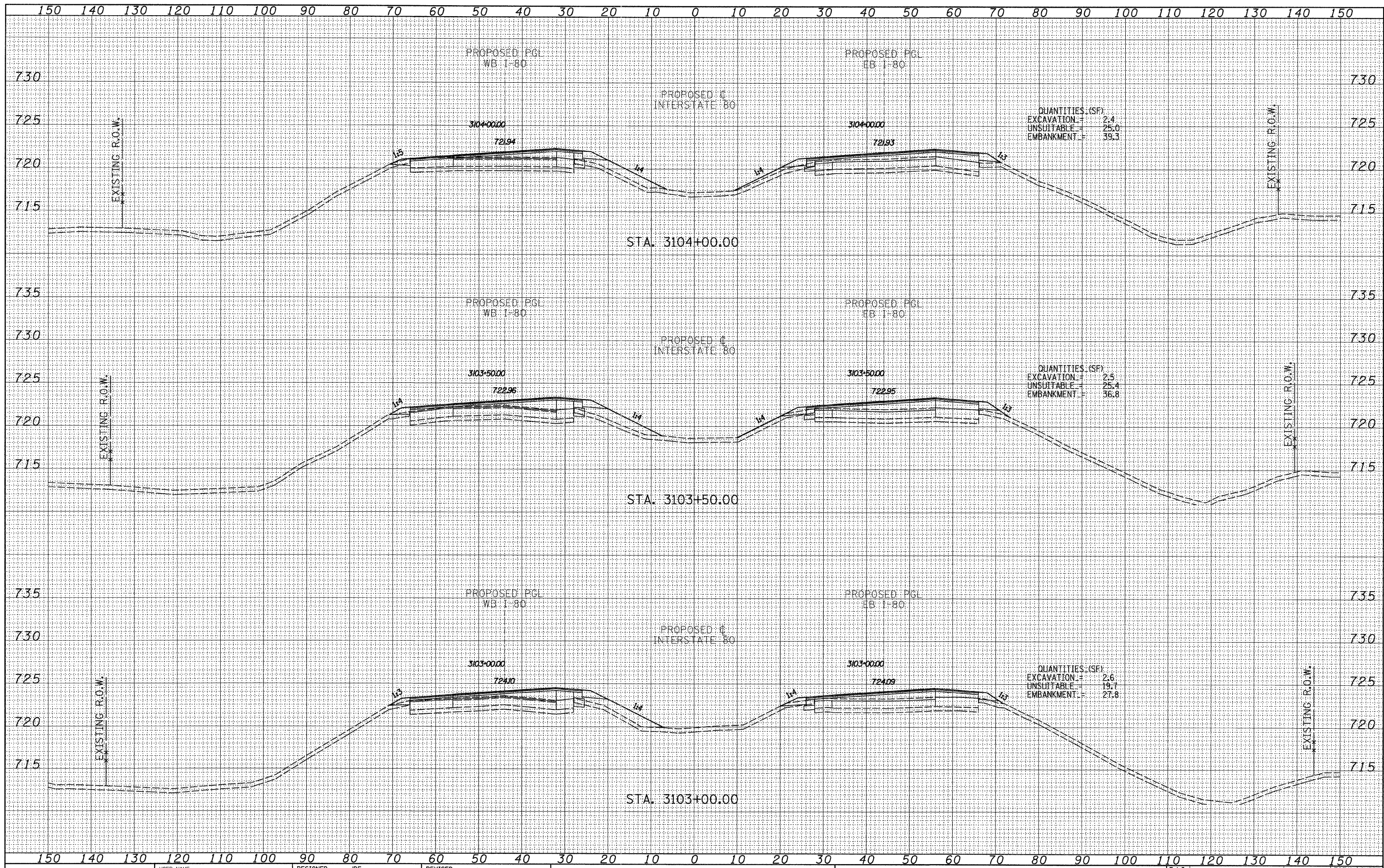

QUANTITIES (SF)
 EXCAVATION = 2.4
 UNSUITABLE = 25.0
 EMBANKMENT = 39.3

QUANTITIES (SF)
 EXCAVATION = 2.5
 UNSUITABLE = 25.4
 EMBANKMENT = 36.8

QUANTITIES (SF)
 EXCAVATION = 2.6
 UNSUITABLE = 19.7
 EMBANKMENT = 27.8

TYLIN INTERNATIONAL

USER NAME =	DESIGNED - JDF	REVISED -
PLOT SCALE =	DRAWN - JDF	REVISED -
PLOT DATE =	CHECKED - JPM	REVISED -
	DATE - 9/7/2011	REVISED -

STATE OF ILLINOIS
 DEPARTMENT OF TRANSPORTATION

F.A.I. ROUTE 80 (I-80)
 PROPOSED CROSS SECTIONS

SCALE: 1" = 10' H
 SHEET NO. OF SHEETS STA. 3103+00.00 TO STA. 3104+00.00

F.A.I. RTE.	SECTION	COUNTY	TOTAL SHEETS	SHEET NO.
80	[106-5HBR-1, VBR(106-6)JRS-3&I	BUREAU	249	194
FED. ROAD DIST. NO.		ILLINOIS FED. AID PROJECT		CONTRACT NO. 66686

P:\602429.10\Road\602429.10.A\366686-sht-xssht.dgn