

FINAL	DATE
SURVEY	BY
NOTE BOOK	
TEMPLATE	
AREAS	
CHECKED	
NO.	

ORIGINAL	DATE
SURVEY	BY
NOTE BOOK	
TEMPLATE	
AREAS	
CHECKED	
NO.	

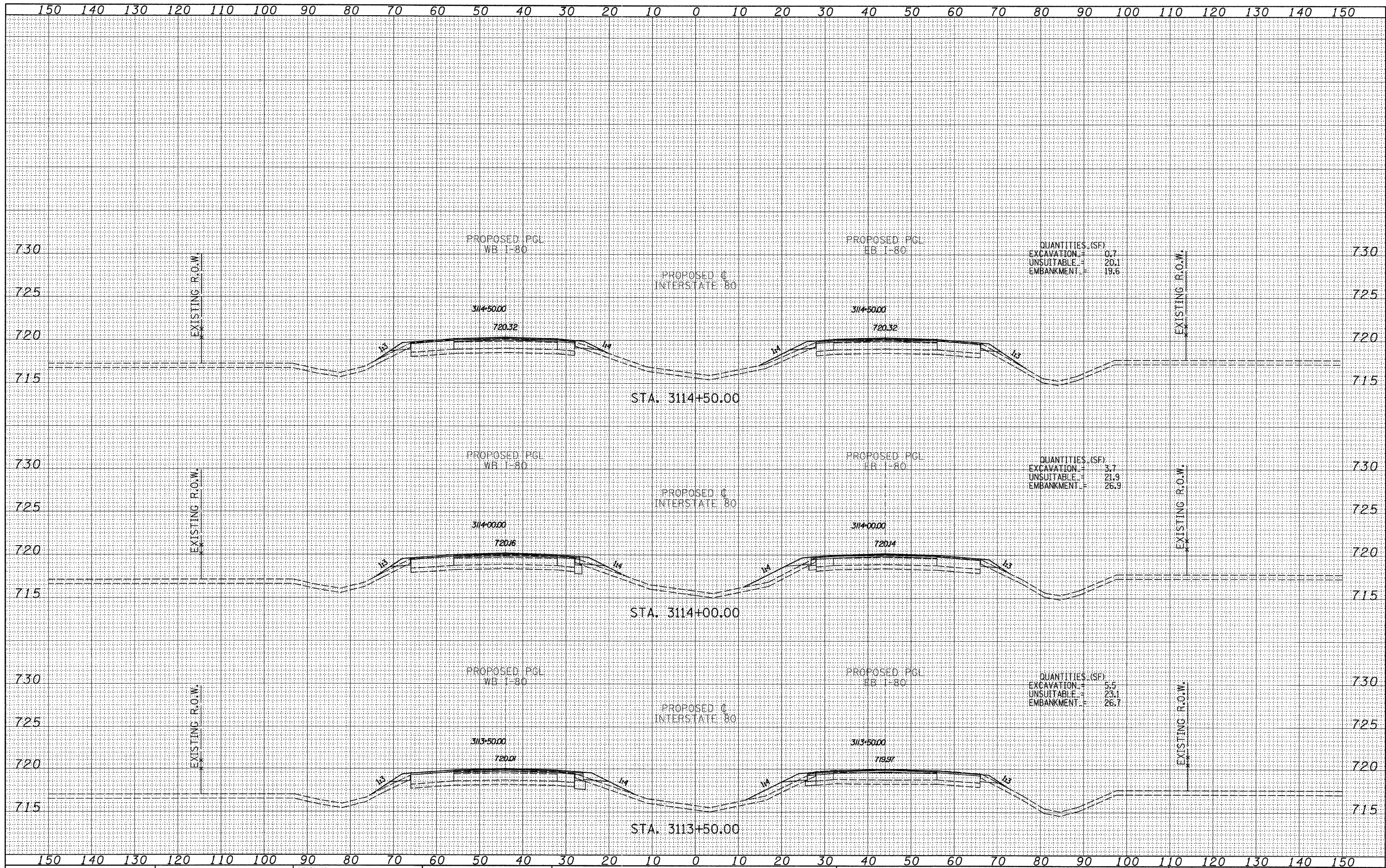

TYLIN INTERNATIONAL

USER NAME =	DESIGNED - JDF	REVISED -
PLOT SCALE =	DRAWN - JDF	REVISED -
PLOT DATE =	CHECKED - JPM	REVISED -
	DATE - 9/7/2011	REVISED -

STATE OF ILLINOIS  
DEPARTMENT OF TRANSPORTATION

F.A.I. ROUTE 80 (I-80)  
PROPOSED CROSS SECTIONS

SCALE: 1" = 10' H  
SHEET NO. OF SHEETS STA. 3113+50.00 TO STA. 3114+50.00

F.A.I. RTE.	SECTION	COUNTY	TOTAL SHEETS	SHEET NO.
80	(106-5)HBR-1, VBR(06-6)RS-3&I	BUREAU	249	20
FED. ROAD DIST. NO.			ILLINOIS FED. AID PROJECT	
			CONTRACT NO. 66686	

P:\602429.1(I-80)\Road\602429.10\_A\366686-shr-xssht.dgn