

FINAL SURVEY	SURVEYED	BY	DATE
NOTE BOOK	PLOTTED		
NO.	TEMPLATE		
	AREAS		
	CHECKED		

ORIGINAL SURVEY	SURVEYED	BY	DATE
NOTE BOOK	PLOTTED		
NO.	TEMPLATE		
	AREAS		
	CHECKED		

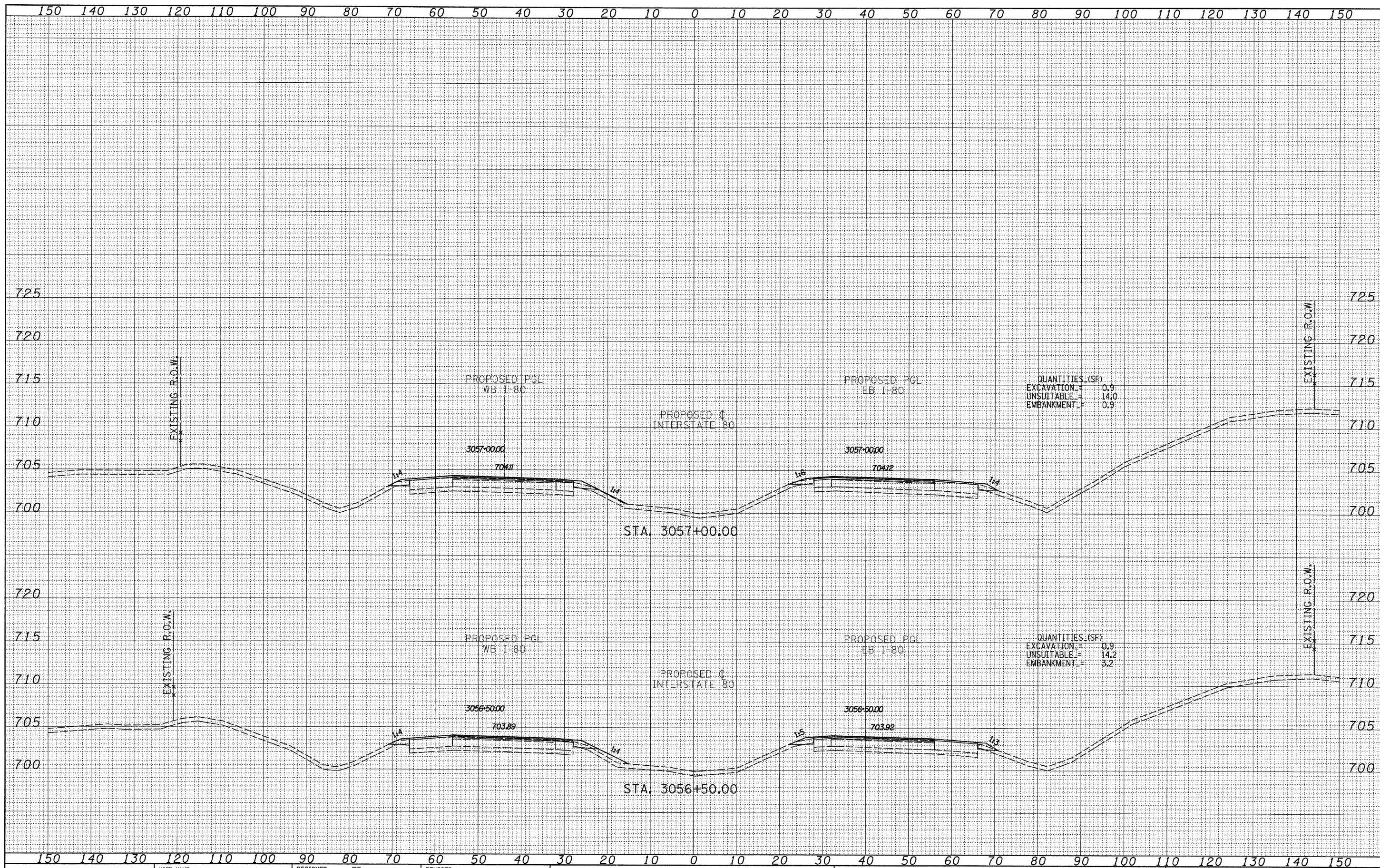

TYLIN INTERNATIONAL

USER NAME =	DESIGNED - JDF	REVISED -
	DRAWN - JDF	REVISED -
	CHECKED - JPM	REVISED -
	DATE - 9/7/2011	REVISED -

**STATE OF ILLINOIS
DEPARTMENT OF TRANSPORTATION**

**F.A.I. ROUTE 80 (I-80)
PROPOSED CROSS SECTIONS**

SCALE: 1" = 40' H
SHEET NO. OF SHEETS STA. 3056+50.00 TO STA. 3057+00.00

F.A.I. RTE.	SECTION	COUNTY	TOTAL SHEETS	SHEET NO.
80	[06-5]HR-1, VBR[06-6]RS-3&I	BUREAU	249	264
FED. ROAD DIST. NO.		ILLINOIS FED. AID PROJECT		
CONTRACT NO. 66686				

P:\602429.1(I-80)\Road\602429.10_A\0366686-sht-xxsht.dgn