

|              |               |      |
|--------------|---------------|------|
| FINAL SURVEY | SURVEYED      | DATE |
| NOTE BOOK    | PLOTTED       | BY   |
| NO.          | TEMPLATE      |      |
|              | AREAS CHECKED |      |

|                 |               |      |
|-----------------|---------------|------|
| ORIGINAL SURVEY | SURVEYED      | DATE |
| NOTE BOOK       | PLOTTED       | BY   |
| NO.             | TEMPLATE      |      |
|                 | AREAS CHECKED |      |

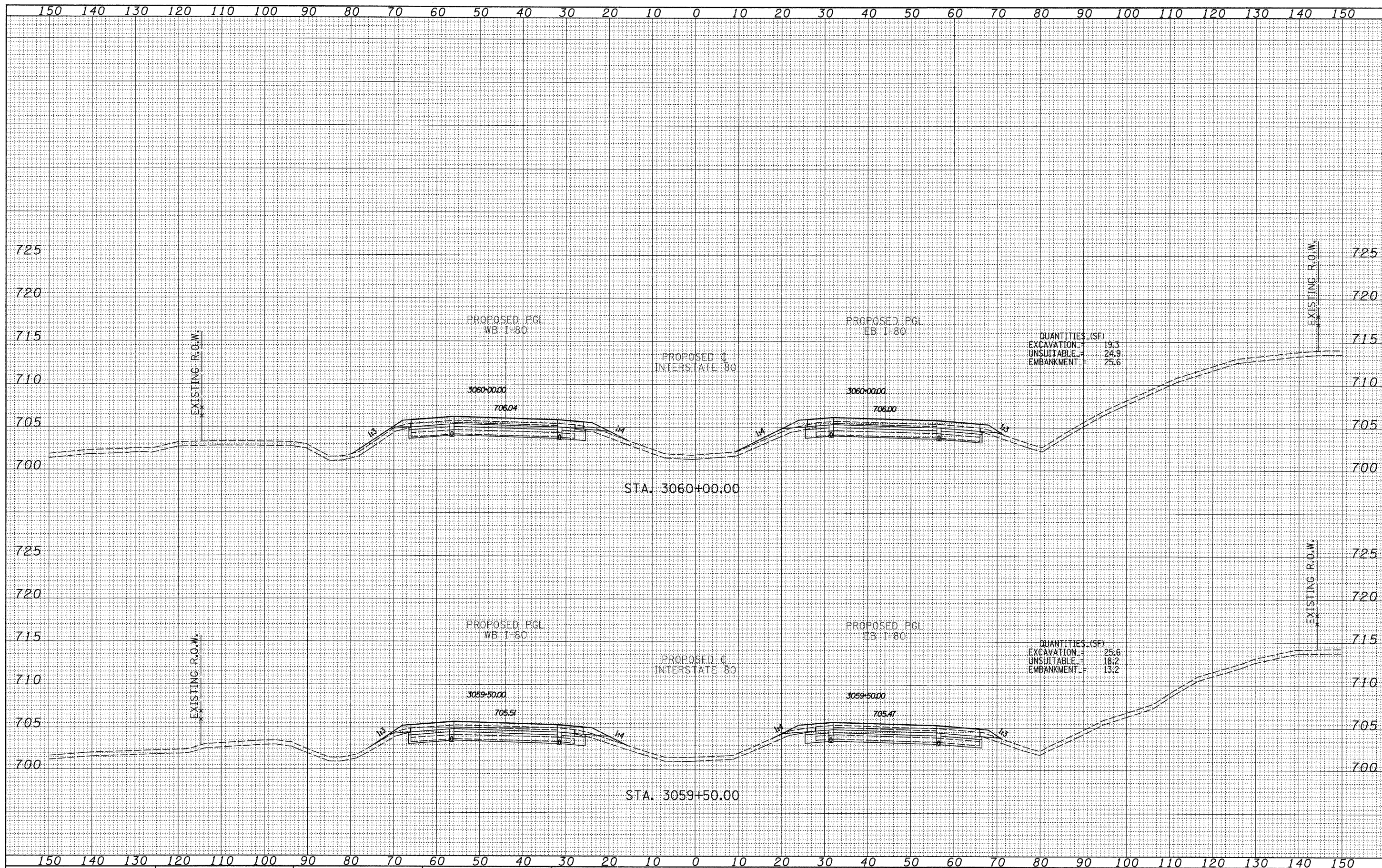

**TYLIN INTERNATIONAL**

|              |                 |           |
|--------------|-----------------|-----------|
| USER NAME =  | DESIGNED - JDF  | REVISED - |
| PLOT SCALE = | DRAWN - JDF     | REVISED - |
| PLOT DATE =  | CHECKED - JPM   | REVISED - |
|              | DATE - 9/7/2011 | REVISED - |

**STATE OF ILLINOIS  
DEPARTMENT OF TRANSPORTATION**

**F.A.I. ROUTE 80 (I-80)  
PROPOSED CROSS SECTIONS**

SCALE: 1" = 10' V, 1" = 100' H SHEET NO. OF SHEETS STA. 3059+50.00 TO STA. 3060+00.00

| F.A.I. RTE.        | SECTION                     | COUNTY | TOTAL SHEETS                                    | SHEET NO. |
|--------------------|-----------------------------|--------|---|-----------|
| 80                 | [06-5]HR-1, VBR(06-6)RS-3&I | BUREAU | 249   | 267       |
| CONTRACT NO. 66686 |                             |        | FED. ROAD DIST. NO. [ILLINOIS] FED. AID PROJECT |           |

P:\602429\I(1-80)\Road\602429\10\_A\036686-sht-xsht.dgn