

DATE	BY
SURVEYED	PLOTTED
NOTE BOOK	TEMPLATE
NO.	AREAS CHECKED

DATE	BY
SURVEYED	PLOTTED
NOTE BOOK	TEMPLATE
NO.	AREAS CHECKED

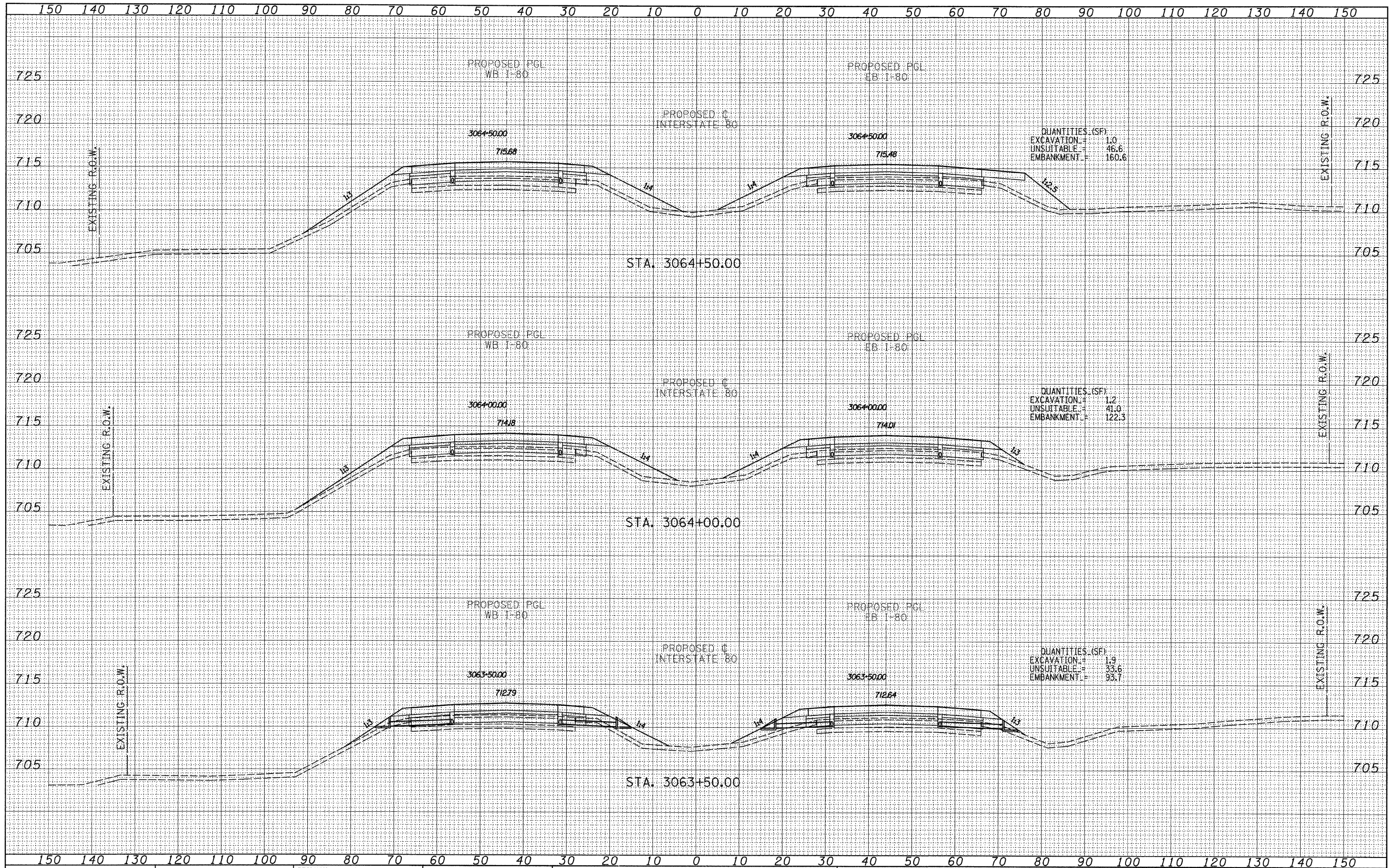

<b>TYLIN INTERNATIONAL</b> USER NAME = PLOT SCALE = PLOT DATE =	DESIGNED - JDF DRAWN - JDF CHECKED - JPM DATE - 9/7/2011	REVISED - REVISED - REVISED - REVISED -	<b>STATE OF ILLINOIS</b> <b>DEPARTMENT OF TRANSPORTATION</b> <b>F.A.I. ROUTE 80 (I-80)</b> <b>PROPOSED CROSS SECTIONS</b>	F.A.I. RTE. 80 SECTION [06-5HBR-1.VBR(06-61)RS-3&I] COUNTY BUREAU TOTAL SHEETS 249 SHEET NO. 210 CONTRACT NO. 66686
	SCALE: 1" = 10' SHEET NO. OF SHEETS STA. 3063+50.00 TO STA. 3064+50.00	FED. ROAD DIST. NO. [ILLINOIS] FED. AID PROJECT		

P:\602429.1(I-80)\Road\602429.10.A\366686-sht-xsht.dgn