

DATE	
BY	
FINAL SURVEY	SURVEYED
NOTE BOOK	PLOTTED
NO.	TEMPLATE
	AREAS CHECKED

DATE	
BY	
ORIGINAL SURVEY	SURVEYED
NOTE BOOK	PLOTTED
NO.	TEMPLATE
	AREAS CHECKED

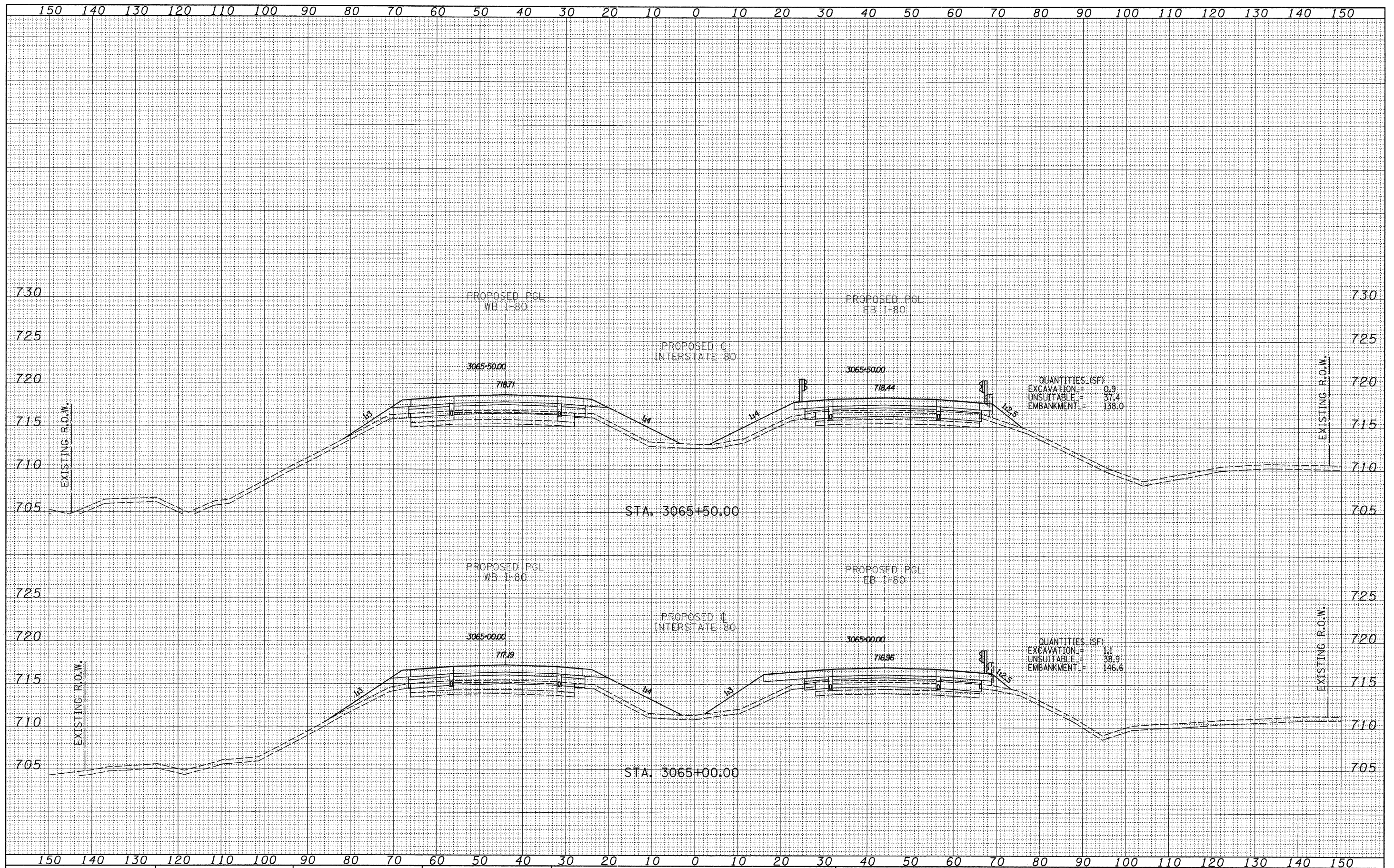

<b>TYLINT</b> INTERNATIONAL USER NAME = PLOT SCALE = PLOT DATE =	DESIGNED - JDF DRAWN - JDF CHECKED - JPM DATE - 9/7/2011	REVISED - REVISED - REVISED - REVISED -	<b>STATE OF ILLINOIS</b> <b>DEPARTMENT OF TRANSPORTATION</b>	<b>F.A.I. ROUTE 80 (I-80)</b> <b>PROPOSED CROSS SECTIONS</b>		F.A.I. RTE. 80	SECTION (06-5)HR-1.VBR(06-6)RS-3&I	COUNTY BUREAU	TOTAL SHEETS 249	SHEET NO. 211
	P:\602429\I(80)\Road\602429.10.A\366686-sht-xssht.dgn	SCALE: 1" = 10' V, 1" = 100' H		SHEET NO. OF SHEETS	STA. 3065+00.00 TO STA. 3065+50.00	FED. ROAD DIST. NO.	ILLINOIS FED. AID PROJECT	CONTRACT NO. 66686		