

FINAL SURVEY	SURVEYED	DATE
NOTE BOOK	PLOTTED	BY
NO.	TEMPLATE	
	AREAS CHECKED	

ORIGINAL SURVEY	SURVEYED	DATE
NOTE BOOK	PLOTTED	BY
NO.	TEMPLATE	
	AREAS CHECKED	

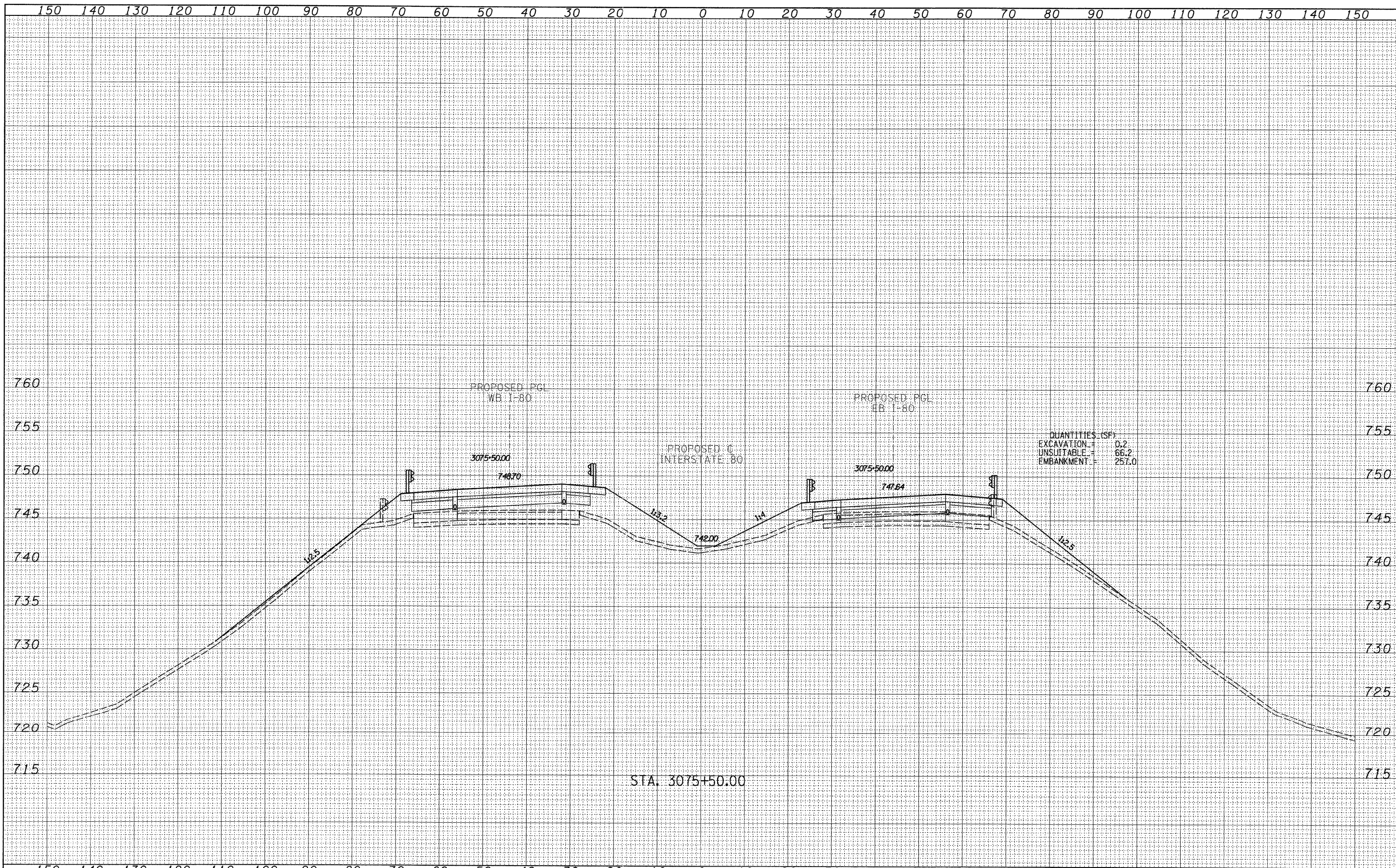

TYLIN INTERNATIONAL USER NAME = DESIGNED - JDF DRAWN - JDF CHECKED - JPM DATE - 9/7/2011	REVISIONS REVISED - REVISED - REVISED - REVISED -	STATE OF ILLINOIS DEPARTMENT OF TRANSPORTATION		F.A.I. ROUTE 80 (I-80) PROPOSED CROSS SECTIONS		F.A.I. RTE. 80	SECTION (106-5)HBR-1, VBR(106-6)RS-3&I	COUNTY BUREAU	TOTAL SHEETS 249	SHEET NO. 22
				SCALE: 1" = 40'	SHEET NO. OF SHEETS	STA. 3075+50.00 TO STA. 3075+50.00	FED. ROAD DIST. NO.	ILLINOIS FED. AID PROJECT	CONTRACT NO. 66696	

P:\602429\I(1-80)\Road\602429.10_A\0366696-sht-xsht.dgn