

FINAL SURVEY	SURVEYED	BY	DATE
NOTE BOOK NO.	PLOTTED		
	TEMPLATE		
	AREAS CHECKED		

ORIGINAL SURVEY	SURVEYED	BY	DATE
NOTE BOOK NO.	PLOTTED		
	TEMPLATE		
	AREAS CHECKED		

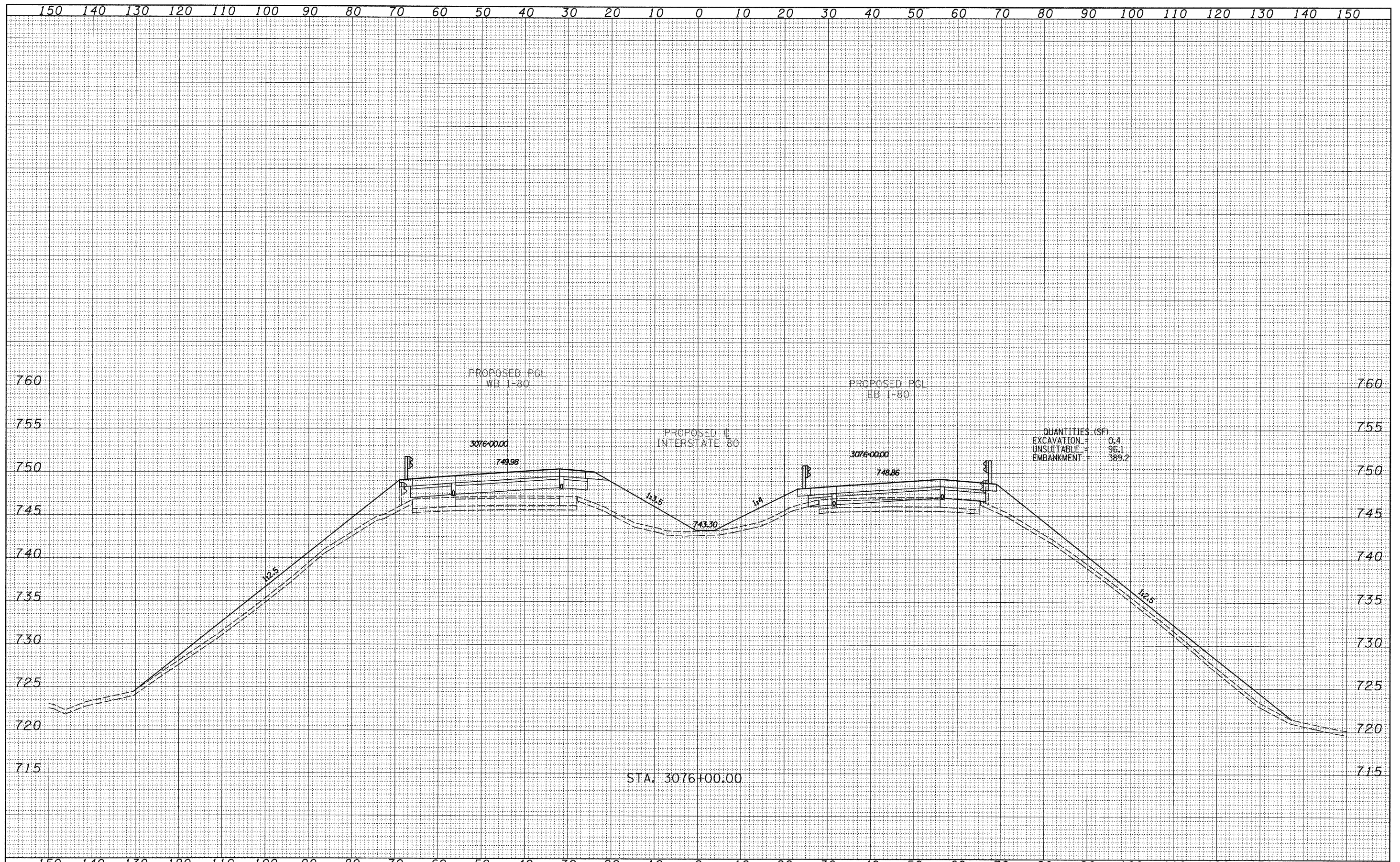

QUANTITIES (SF):

EXCAVATION	0.4
UNSUITABLE	96.1
EMBANKMENT	389.2

STA. 3076+00.00

**TYL** INTERNATIONAL

USER NAME =	DESIGNED - JDF	REVISED -
PLLOT SCALE =	DRAWN - JDF	REVISED -
PLLOT DATE =	CHECKED - JPM	REVISED -
	DATE - 9/7/2011	REVISED -

**STATE OF ILLINOIS  
DEPARTMENT OF TRANSPORTATION**

**F.A.I. ROUTE 80 (I-80)  
PROPOSED CROSS SECTIONS**

SCALE: 1" = 10' V, 1" = 100' H SHEET NO. OF SHEETS STA. 3076+00.00 TO STA. 3076+00.00

F.A.I. RTE.	SECTION	COUNTY	TOTAL SHEETS	SHEET NO.
80	[06-5]HBR-1.VBR[06-6]RS-3&I	BUREAU	249	222
FED. ROAD DIST. NO.		ILLINOIS FED. AID PROJECT		
		CONTRACT NO. 66686		

P:\602429\I(1-80)\Road\602429.10\_A\0366686-sht-xsht.dgn