

|              |               |      |
|--------------|---------------|------|
| FINAL SURVEY | SURVEYED      | DATE |
| NOTE BOOK    | PLOTTED       | BY   |
| NO.          | TEMPLATE      |      |
|              | AREAS CHECKED |      |

|                 |               |      |
|-----------------|---------------|------|
| ORIGINAL SURVEY | SURVEYED      | DATE |
| NOTE BOOK       | PLOTTED       | BY   |
| NO.             | TEMPLATE      |      |
|                 | AREAS CHECKED |      |

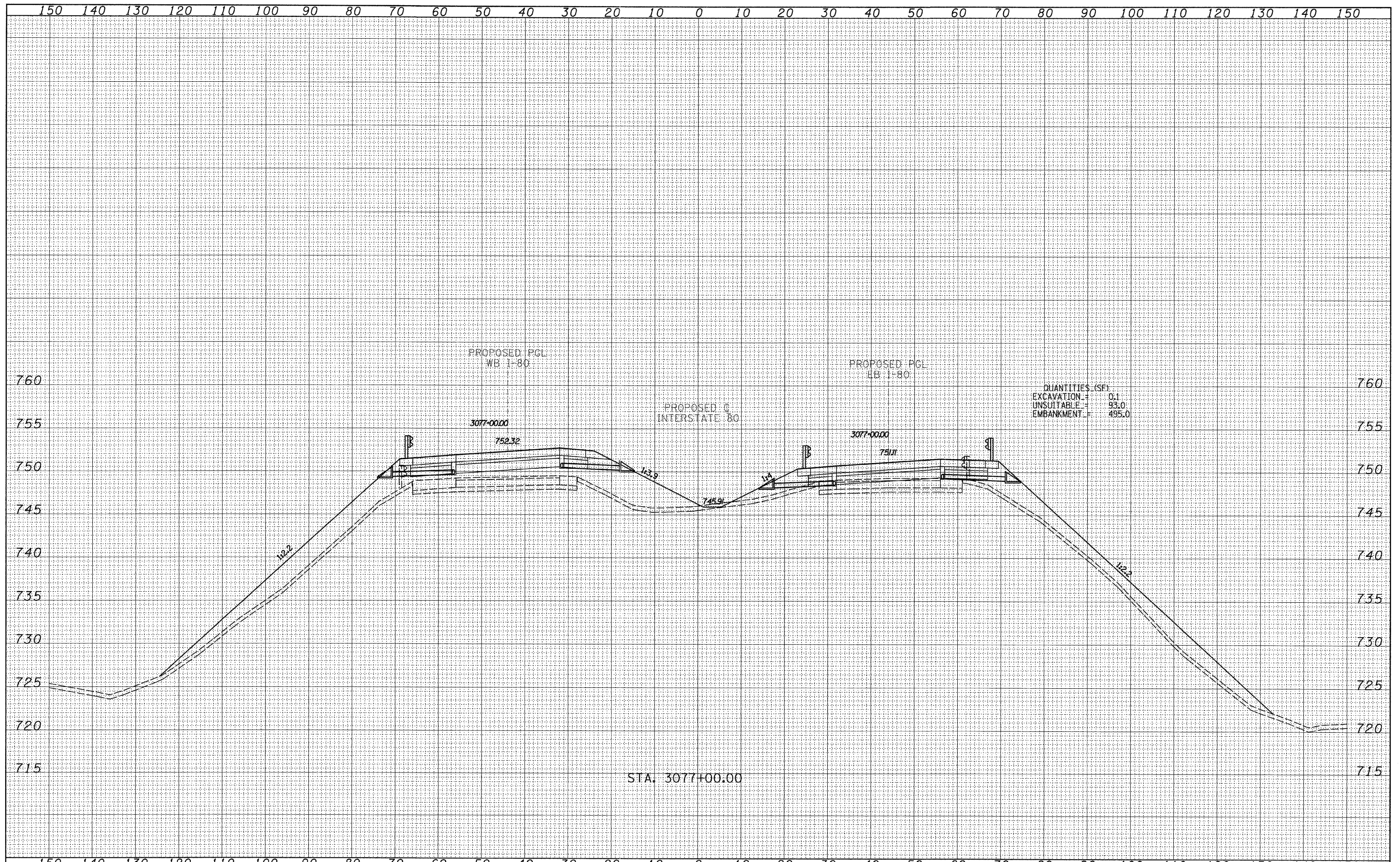

QUANTITIES (SF)  
 EXCAVATION = 0.1  
 UNSUITABLE = 93.0  
 EMBANKMENT = 495.0

STA. 3077+00.00

TYLINTERNATIONAL

|              |                 |           |
|--------------|-----------------|-----------|
| USER NAME =  | DESIGNED - JDF  | REVISED - |
| PLOT SCALE = | DRAWN - JDF     | REVISED - |
| PLOT DATE =  | CHECKED - JPM   | REVISED - |
|              | DATE - 9/7/2011 | REVISED - |

STATE OF ILLINOIS  
 DEPARTMENT OF TRANSPORTATION

F.A.I. ROUTE 80 (I-80)  
 PROPOSED CROSS SECTIONS

SCALE: 1" = 10' H  
 SHEET NO. OF SHEETS STA. 3077+00.00 TO STA. 3077+00.00

| F.A.I. RTE.                                     | SECTION                      | COUNTY | TOTAL SHEETS       | SHEET NO. |
|---|------------------------------|--------|--------------------|-----------|
| 80  | [(06-5)HBR-1.VBR(06-6)RS-3&I | BUREAU | 249                | 224       |
| FED. ROAD DIST. NO. [ILLINOIS] FED. AID PROJECT |                              |        | CONTRACT NO. 66686 |           |