

FINAL SURVEY	SUBMITTED	DATE
NOTE BOOK	PLOTTED	BY
NO.	TEMPLATE	
	AREAS CHECKED	

ORIGINAL SURVEY	SUBMITTED	DATE
NOTE BOOK	PLOTTED	BY
NO.	TEMPLATE	
	AREAS CHECKED	

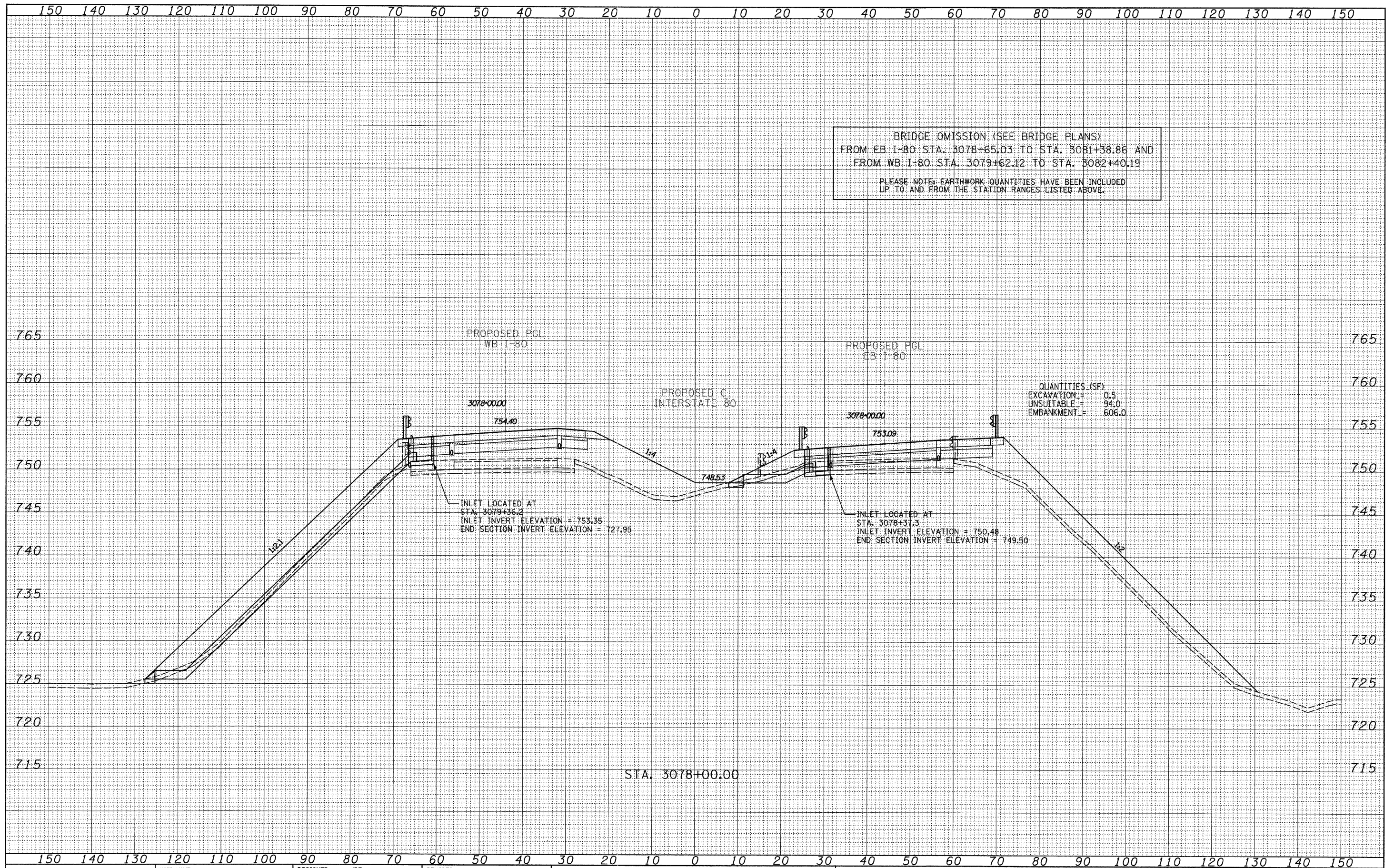

TYLIN INTERNATIONAL	USER NAME =	DESIGNED - JDF	REVISED -	STATE OF ILLINOIS DEPARTMENT OF TRANSPORTATION	F.A.I. ROUTE 80 (I-80) PROPOSED CROSS SECTIONS		F.A.I. RTE.	SECTION	COUNTY	TOTAL SHEETS	SHEET NO.
	PLOT SCALE =	DRAWN - JDF	REVISED -		80	[06-5HBR-1.VBR(06-6)RS-3&]	BUREAU	29926	CONTRACT NO. 66686		
	PLOT DATE =	CHECKED - JPM	REVISED -	SCALE: 1" = 10'	SHEET NO. OF SHEETS	STA. 3078+00.00 TO STA. 3078+00.00	FED. ROAD DIST. NO.	ILLINOIS FED. AID PROJECT			
		DATE - 9/7/2011	REVISED -								

P:\602429.1(I-80)\Road\602429.10_A\0366686-sht-xssht.dgn