

FINAL SURVEY	SURVEYED	DATE
NOTE BOOK	PLOTTED	BY
NO.	TEMPLATE	
	AREAS CHECKED	
	AREAS CHECKED	

ORIGINAL SURVEY	SURVEYED	DATE
NOTE BOOK	PLOTTED	BY
NO.	TEMPLATE	
	AREAS CHECKED	
	AREAS CHECKED	

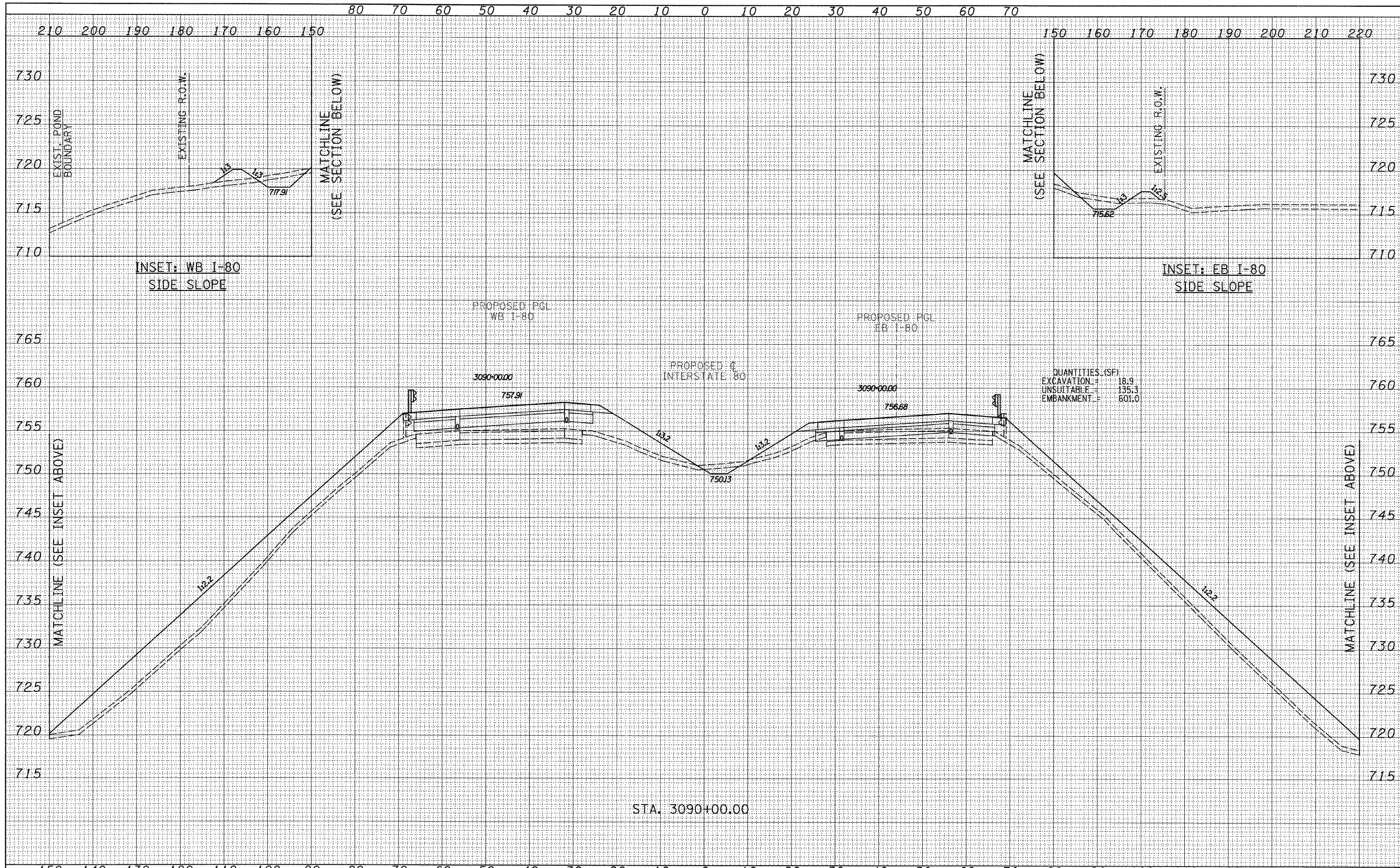

QUANTITIES (SF)

EXCAVATION	=	18.9
UNSUITABLE	=	135.3
EMBANKMENT	=	601.0

TYLIN INTERNATIONAL

USER NAME =	DESIGNED - JDF	REVISED -
PLLOT SCALE =	DRAWN - JDF	REVISED -
PLLOT DATE =	CHECKED - JPM	REVISED -
	DATE - 9/7/2011	REVISED -

**STATE OF ILLINOIS
DEPARTMENT OF TRANSPORTATION**

**F.A.I. ROUTE 80 (I-80)
PROPOSED CROSS SECTIONS**

SCALE: 1" = 10' V, 1" = 100' H

SHEET NO. OF SHEETS STA. 3090+00.00 TO STA. 3090+00.00

F.A.I. RTE.	SECTION	COUNTY	TOTAL SHEETS	SHEET NO.
80	[06-5HBR-1.VBR(06-6)RS-3&I	BUREAU	249	24
CONTRACT NO. 66686				
FED. ROAD DIST. NO. [ILLINOIS] FED. AID PROJECT				

P:\602429.1(I-80)\Road\602429.10_A\0366686-sht-xsht.dgn