

STAGE 1 CONSTRUCTION TYPICAL SECTION
(LOOKING EAST AT STRUCTURE)
FOR INFORMATION ONLY

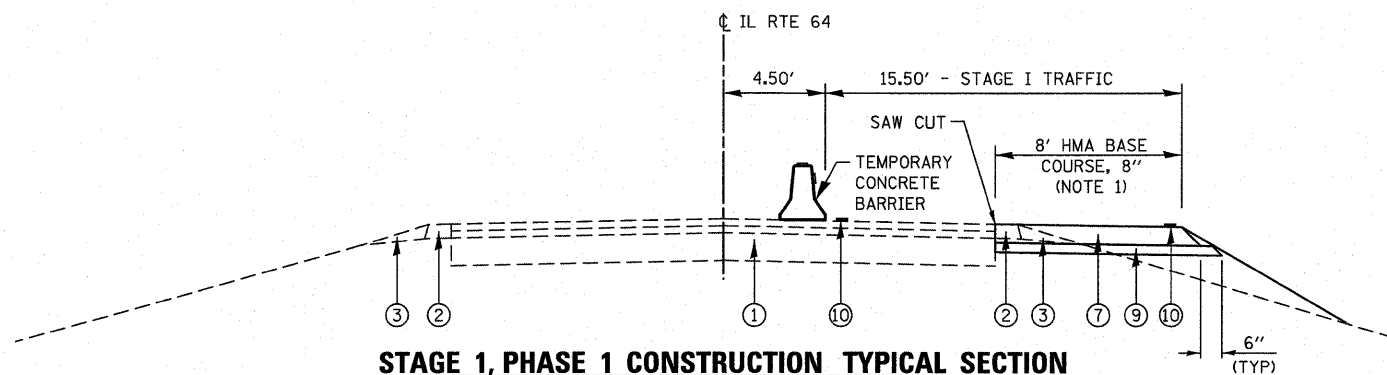

STAGE 1, PHASE 1 CONSTRUCTION TYPICAL SECTION
(WEST OF STRUCTURE, LOOKING EAST &
EAST OF STRUCTURE, LOOKING EAST)

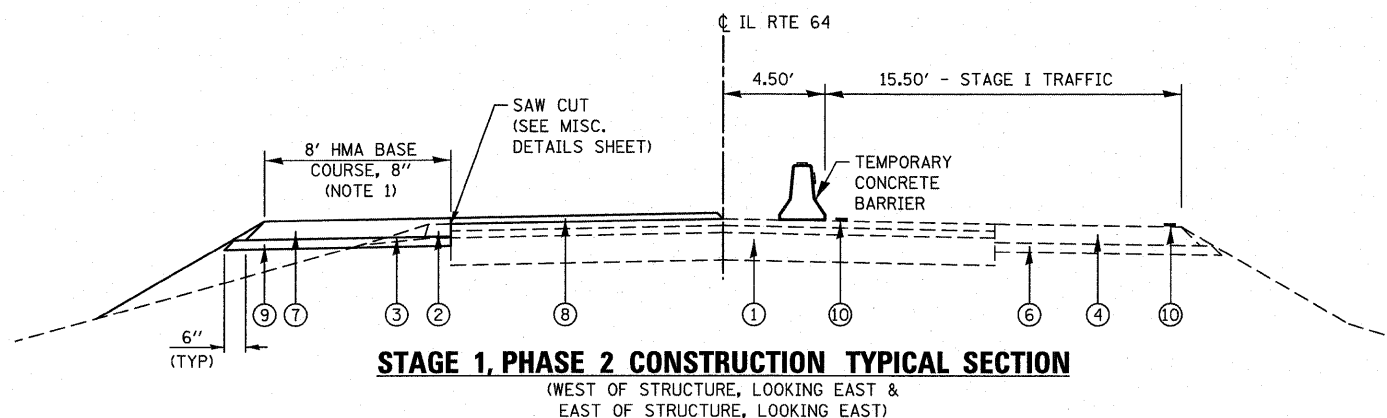

STAGE 1, PHASE 2 CONSTRUCTION TYPICAL SECTION
(WEST OF STRUCTURE, LOOKING EAST &
EAST OF STRUCTURE, LOOKING EAST)

LEGEND

- ① EXISTING PAVEMENT
- ② EXISTING PAVED SHOULDER
- ③ EXISTING AGGREGATE SHOULDER
- ④ EXISTING HMA BASE COURSE, 8"
- ⑤ EXISTING HMA BINDER COURSE / LEVELING BINDER, VARIABLE DEPTH
- ⑥ EXISTING SUBBASE GRANULAR MATERIAL, TYPE B 4"
- ⑦ PROPOSED HMA BASE COURSE, 8"
- ⑧ PROPOSED HMA BINDER COURSE / LEVELING BINDER, VARIABLE DEPTH
- ⑨ PROPOSED SUBBASE GRANULAR MATERIAL, TYPE B 4"
- ⑩ PROPOSED TEMPORARY PAVEMENT MARKING

NOTE 1: HMA BASE CSE SHALL BE BUILT WIDE ENOUGH TO SUPPORT THE FINAL WIDTH SHOWN ON THE TYPICAL SECTIONS (SHEET 5)

STAGE CONSTRUCTION GENERAL NOTES

1. ONE LANE OF TRAFFIC ON ILLINOIS ROUTE 64 SHALL BE MAINTAINED AT ALL TIMES.
2. EMERGENCY ACCESS SHALL BE PROVIDED AT ALL TIMES.

SUGGESTED STAGE CONSTRUCTION

SUGGESTED STAGE 1

PHASE 1

1. UTILIZING TRAFFIC CONTROL AND PROTECTION, STANDARD 701326, REMOVE EXISTING HOT-MIX ASPHALT SHOULDER AND CONSTRUCT THE HMA BASE COURSE, 8" ON THE RT SIDE OF THE ROADWAY FROM STA. 75+90 TO STA. 78+25 AND STA. 78+75 TO STA. 81+12. TRAFFIC CONTROL SURVEILLANCE SHALL BE PAID FOR THROUGHOUT THE DURATION THAT STANDARD 701326 IS UTILIZED.
2. INSTALL TEMPORARY TRAFFIC SIGNALS AT EACH END OF THE PROJECT AND THE COMMERCIAL ENTRANCE PRIOR TO CLOSING THE LT HALF OF ROADWAY.

PHASE 2

1. UTILIZING TRAFFIC CONTROL AND PROTECTION, STANDARD 701321, DIRECT TRAFFIC TO THE RT LANE OF FAP ROUTE 307.
2. CONSTRUCT TEMPORARY SHEET PILING AT WEST AND EAST SIDE OF EXISTING STRUCTURE AND REMOVE THE LT SIDE OF THE EXISTING STRUCTURE.
3. CONSTRUCT THE LT SIDE OF THE BRIDGE AND BRIDGE APPROACH PAVEMENT.
4. CONSTRUCT THE PROPOSED VARIABLE DEPTH HMA BINDER COURSE / LEVELING BINDER ON THE LT SIDE OF FAP ROUTE 307 FROM STA. 77+00 TO STA. 77+69 AND FROM STA. 79+33 TO STA. 80+00.
5. CONSTRUCT THE HMA BASE COURSE, 8" ON THE LT SIDE OF FAP ROUTE 307 FROM STA. 75+90 TO STA. 77+69 AND FROM STA. 79+33 TO STA. 81+94.
6. CONSTRUCT TEMPORARY RAMP AT STA. 77+69 AND STA. 79+33.
7. INSTALL GUARDRAIL AND SIDEWALKS ON LT SIDE OF FAP ROUTE 307.
8. INSTALL TEMPORARY PAVEMENT MARKING.

SUGGESTED STAGE 2

1. UTILIZING TRAFFIC CONTROL AND PROTECTION, STANDARD 701321, DIRECT TRAFFIC TO THE LT LANE OF FAP ROUTE 307.
2. REMOVE THE RT SIDE OF THE EXISTING STRUCTURE.
3. CONSTRUCT THE RT SIDE OF THE BRIDGE AND BRIDGE APPROACH PAVEMENT.
4. CONSTRUCT THE PROPOSED VARIABLE DEPTH HMA BINDER COURSE / LEVELING BINDER ON THE RT SIDE OF FAP ROUTE 307, INCLUDING THE SHOULDER, FROM STA. 77+00 TO STA. 77+69 AND FROM STA. 79+33 TO STA. 80+00.
5. CONSTRUCT TEMPORARY RAMP AT STA. 77+69 AND STA. 79+33.
6. INSTALL GUARDRAIL ON THE RT SIDE OF FAP ROUTE 307.

SUGGESTED STAGE 3

1. UTILIZING TRAFFIC CONTROL AND PROTECTION, STANDARD 701306, COMPLETE HMA SURFACE REMOVAL, VARIABLE DEPTH, FOR THE RT AND LT LANES OF FAP ROUTE 307 FROM STA. 74+49 TO STA. 75+95 AND STA. 81+00 TO STA. 82+73.
2. CONSTRUCT THE REMAINING PROPOSED VARIABLE DEPTH HMA BINDER COURSE / LEVELING BINDER FOR THE RT AND LT LANES AND SHOULDERS OF FAP ROUTE 307 FROM STA. 75+95 TO STA. 77+69 AND STA. 79+33 TO STA. 81+00.
3. CONSTRUCT THE PROPOSED 3/4" LEVELING BINDER FOR THE RT AND LT LANES OF FAP ROUTE 307 FROM STA. 74+49 TO STA. 77+69 AND STA. 79+33 TO STA. 82+73. THE 3/4" LEVELING BINDER SHALL ALSO BE PLACED ON THE SHOULDERS BETWEEN STA. 75+90 TO STA. 77+69 AND STA. 79+33 TO STA. 81+12 RT (81+94 LT).
4. CONSTRUCT THE PROPOSED HMA SURFACE COURSE FOR THE RT AND LT LANES OF FAP ROUTE 307 FROM STA. 74+49 TO STA. 77+69 AND STA. 79+33 TO STA. 82+73. THE HMA SURFACE COURSE SHALL ALSO BE PLACED ON THE SHOULDERS BETWEEN STA. 75+90 TO STA. 77+69 AND STA. 79+33 TO STA. 81+12 RT (81+94 LT).
5. CONSTRUCT 8' HMA SHOULDERS ON THE RT SIDE OF FAP ROUTE 307 FROM STA. 74+49 TO STA. 75+90 AND FROM STA. 81+12 TO STA. 82+73 AND ON THE LT SIDE OF FAP ROUTE 307 FROM STA. 74+49 TO STA. 75+90 AND FROM STA. 81+94 TO STA. 82+73.

FILE NAME = sheets02.dgn	USER NAME = randy	DESIGNED -	REVISED -	STATE OF ILLINOIS DEPARTMENT OF TRANSPORTATION	STAGE 1 TYPICAL SECTIONS & STAGING NOTES				F.A.P. RTE. 307	SECTION 126 (B-1)BR	COUNTY DEKALB	TOTAL SHEETS 62	SHEET NO. 11
PLOT SCALE = 20,0000' / IN.	CHECKED -	REVISED -	REVISED -		SCALE: NTS	SHEET NO. 1 OF 6 SHEETS	STA.	TO STA.	CONTRACT NO. 66987				
PLOT DATE = 8/17/2011	DATE -	REVISED -	REVISED -		FED. ROAD DIST. NO. ILLINOIS FED. AID PROJECT								