

**SECTION THRU INTEGRAL ABUTMENT**  
(Horiz. dim. @ Rt. L's)

\* Included in the cost of Pipe Underdrains for Structures.

**Note:**

All drainage system components shall extend to 2'-0" from the end of each wingwall except an outlet pipe shall extend until intersecting with the side slopes. The pipes shall drain into concrete headwalls. (See Article 601.05 of the Standard Specifications and Highway Standard 601001).

**INDEX OF SHEETS**

Sheet No.	Items:
1	General Plan & Elevation
2	Stage Construction Details
3	Temporary Concrete Barrier
4	Top of Slab Elevations
5	Top of Slab Elevations
6	Superstructure
7	Superstructure Details
8	Diaphragm Details
9	Structural Steel
10	North & South Abutments
11	Bar Splicer Assembly Details
12	Cantilever Forming Brackets
13	Bridge Approach Slab Details
14	Bridge Approach Slab Details
15	Boring Logs

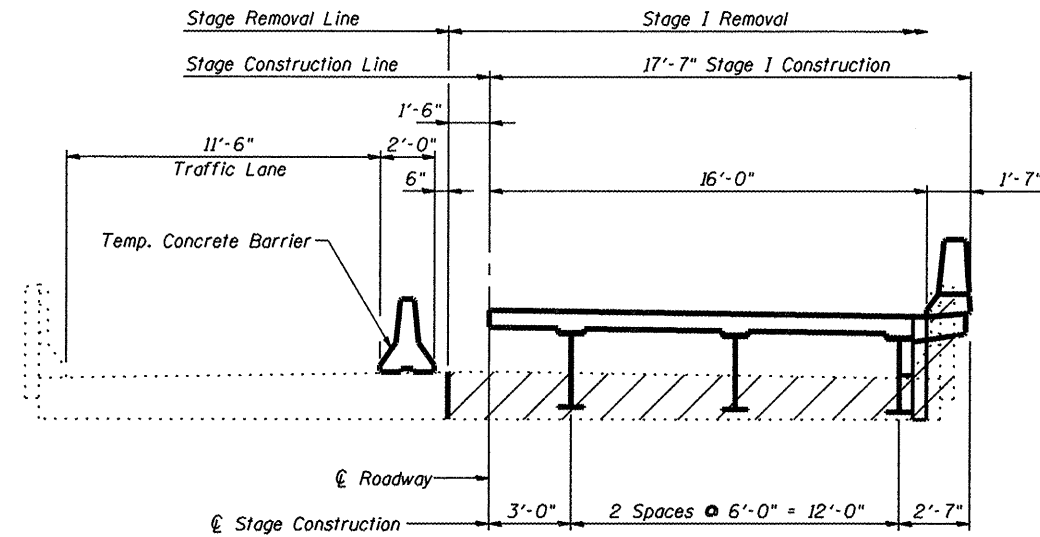

**STAGE I CONSTRUCTION & REMOVAL**  
(Looking South)

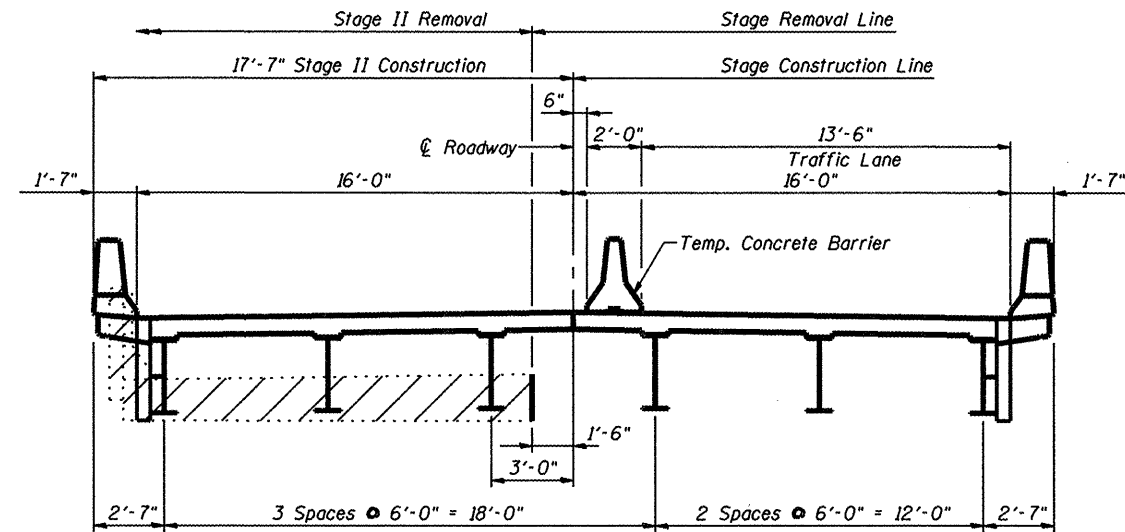

**STAGE II CONSTRUCTION & REMOVAL**  
(Looking South)

See Roadway Plans for quantity of Temporary Concrete Barrier.

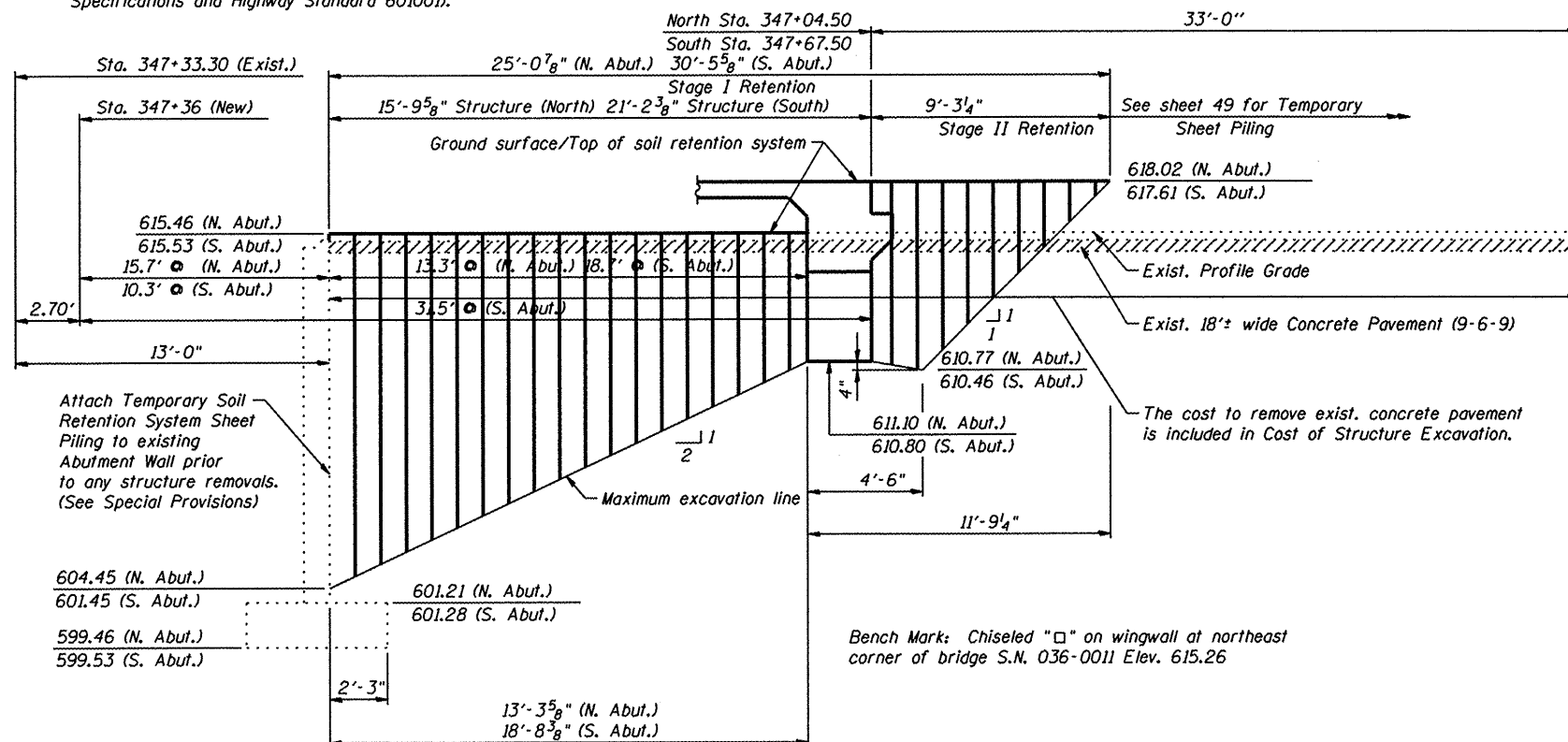

**TEMPORARY SOIL RETENTION SYSTEM**

A cantilevered sheet piling design does not appear feasible and additional members or other retention systems may be necessary. The Contractor shall submit a temporary soil retention system design including plan details and calculations for review and acceptance by the Engineer.



FILE NAME =	USER NAME = #USER#	DESIGNED -	REVISED -	<b>STATE OF ILLINOIS DEPARTMENT OF TRANSPORTATION</b>	<b>STAGE CONSTRUCTION DETAILS IL 94 OVER DIXON CREEK S.N. 036-0054</b>	F.A.P. RTE.	SECTION	COUNTY	TOTAL SHEETS	SHEET NO.	
#FILE#		DRAWN -	REVISED -			534	109B (BR2)	HENDERSON	88	42	
	PLOT SCALE = #SCALE#	CHECKED -	REVISED -			<b>CONTRACT NO. 68083</b>					
	DATE	DATE	REVISED -			SCALE:	SHEET NO. 2 OF 15 SHEETS	STA. 347+36	ILLINOIS FED. AID PROJECT		