

NORTH CURB LINE/NORTH FACE OF PARAPET

Location	Station	Offset	Theoretical Grade Elevations
W. End of Appr. Slab	348+11.76	-6.00	602.96
A	348+21.76	-6.00	602.91
B	348+31.80	-6.42	602.85
E. End of Appr. Slab	348+41.80	-6.42	602.81

NORTH EDGE OF PAVEMENT/P.G.L.

Location	Station	Offset	Theoretical Grade Elevations
W. End of Appr. Slab	348+11.16	0.00	603.08
A	348+21.16	0.00	603.03
B	348+31.16	0.00	602.98
E. End of Appr. Slab	348+41.16	0.00	602.94

☉ ROADWAY

Location	Station	Offset	Theoretical Grade Elevations
W. End of Appr. Slab	348+09.96	12.00	603.26
A	348+19.96	12.00	603.22
B	348+29.96	12.00	603.17
E. End of Appr. Slab	348+39.96	12.00	603.12

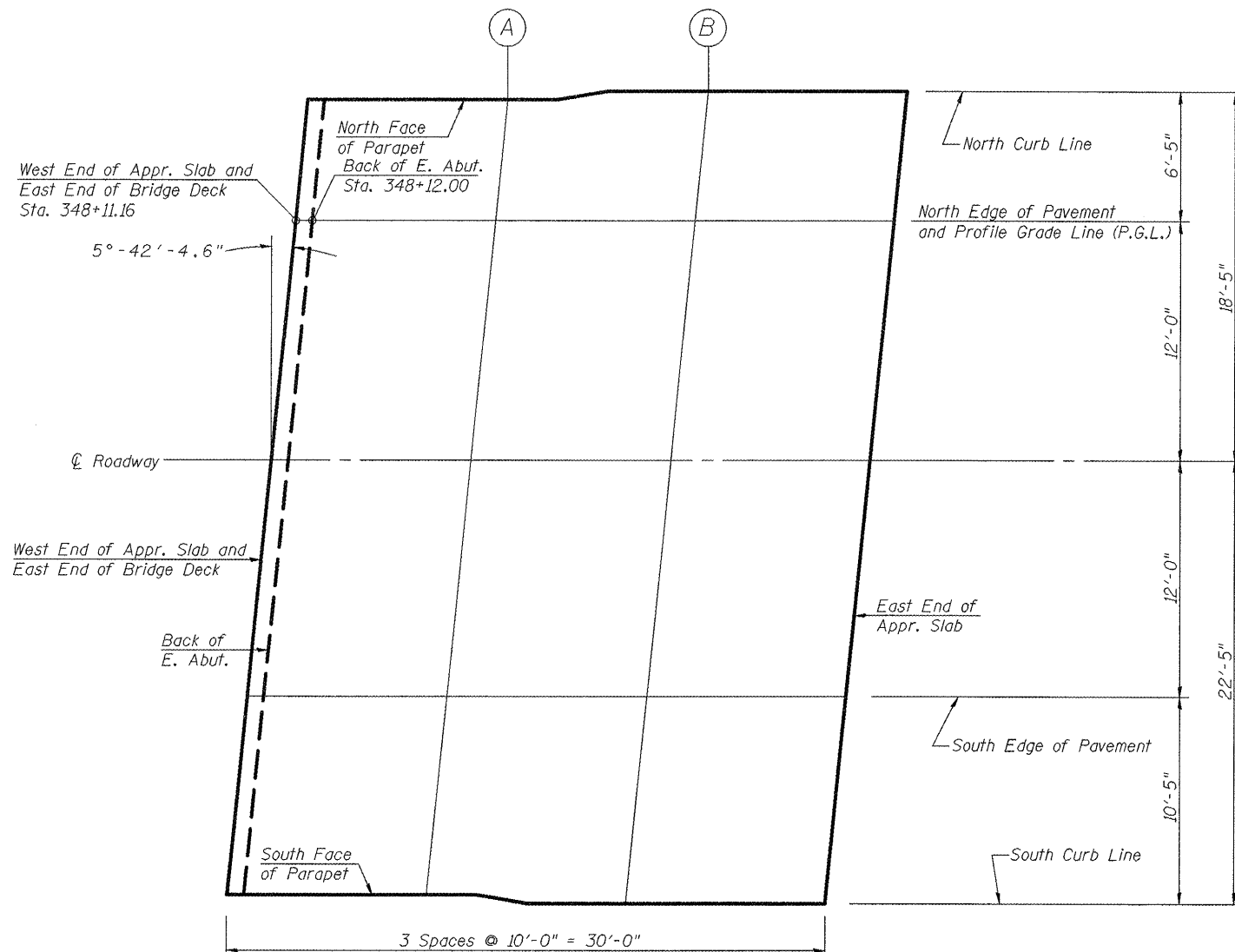

PLAN

SOUTH EDGE OF PAVEMENT

Location	Station	Offset	Theoretical Grade Elevations
W. End of Appr. Slab	348+08.76	24.00	603.09
A	348+18.76	24.00	603.04
B	348+28.76	24.00	603.00
E. End of Appr. Slab	348+38.76	24.00	602.95

SOUTH CURB LINE/SOUTH FACE OF PARAPET

Location	Station	Offset	Theoretical Grade Elevations
W. End of Appr. Slab	348+07.77	34.00	602.90
A	348+17.77	34.00	602.85
B	348+27.72	34.42	602.79
E. End of Appr. Slab	348+37.72	34.42	602.75

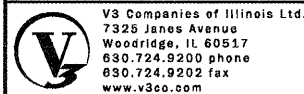

V3 Companies of Illinois Ltd.
7325 Janes Avenue
Woodridge, IL 60517
830.724.9200 phone
830.724.9202 fax
www.v3co.com

FILE NAME: 09 Top of E Approach Slab Elevations-Eastbound.dgn
DESIGNED: B. Vegrzyn
CHECKED: Coombe-Bloxdorf
PLOT SCALE: 1:1
PLOT DATE: July 1, 2011

REVISIONS:
REVISOR: -
REVISION: -
DRAWN: B. Vegrzyn
CHECKED: Coombe-Bloxdorf
REVISION: -

**STATE OF ILLINOIS
DEPARTMENT OF TRANSPORTATION**

**TOP OF E. APPROACH SLAB ELEVATIONS - EASTBOUND
STRUCTURE NO. 072-0001 & 072-0002**

SHEET NO. 9 OF 34 SHEETS

F.A.T. RTE.	SECTION	COUNTY	TOTAL SHEETS	SHEET NO.
74	72-6VB	PEORIA	133	52

CONTRACT NO. 68874

ILLINOIS FED. AID PROJECT