

- STAGE II NOTES:**
1. RELOCATE TRAFFIC CONTROL DEVICES AS NECESSARY FOR STAGE II TRAFFIC. SEE STANDARD 701321.
 2. WIDTH RESTRICTION SIGNING SHALL BE POSTED FOR MAXIMUM WIDTH OF 9'-6" PER SHEET 21 OF 29 PRIOR TO DIVERTING TRAFFIC.
 3. DIVERT TRAFFIC TO STAGE II TRAFFIC LANES
 4. REMOVE THE STAGE II PORTION OF THE EXISTING STRUCTURE, PAVEMENT, GUARDRAIL, AND SHOULDER.
 5. CONSTRUCT STAGE II PORTION OF THE PROPOSED STRUCTURE, NEW PAVEMENT, BASE COURSE (OPTION), NEW GUARDRAIL, NEW PIPE CULVERT, NEW STORM SEWER, PRIVATE ENTRANCE, AND EXCAVATION AND EMBANKMENT AS REQUIRED, BASE COURSE (OPTION) STA 69+03.00 TO STA 70+07.00 LT. THE NEWLY CONSTRUCTED PAVEMENT SHALL BUTT UP TO AND MATCH THE EXISTING PAVEMENT ELEVATION AT EACH END.

- POST-STAGE II NOTES:**
1. REMOVE ALL TRAFFIC DEVICES.
 2. COMPLETE ALL OTHER CONTRACT WORK AS REQUIRED UTILIZING APPLICABLE TRAFFIC CONTROL STANDARDS.
- GENERAL NOTES:**
1. BARRIER OFFSETS ARE FROM THE CENTER OF THE BARRIER.
 2. ALL SIGNS, TRAFFIC CONTROL EQUIPMENT, AND TEMPORARY PAVEMENT MARKINGS SHALL BE INCLUDED IN THE CONTRACT UNIT PRICE EACH FOR TRAFFIC CONTROL AND PROTECTION STANDARD 701321.
 3. ALL TEMPORARY BRIDGE TRAFFIC SIGNALS FOR CONSTRUCTION WILL BE MEASURED AS 1 (ONE) UNIT.
 4. PRIVATE ENTRANCE AT STA 70+66.91 LT TO REMAIN OPEN AT ALL TIMES.
 5. ALL TRAFFIC CONTROL ITEMS NOT SHOWN ON STAGE I & II PLAN VIEW SHALL BE PER REQUIREMENTS OF TRAFFIC CONTROL AND PROTECTION, STANDARD 701321.

LEGEND

- DRIVEWAY PAVEMENT REMOVAL AND NEW PCC DRIVEWAY PAVEMENT, 6 INCH
- PAVED SHOULDER REMOVAL (REPLACE WITH BASE COURSE (OPTION))
- BASE COURSE (OPTION)
- TEMPORARY IMPACT ATTENUATOR
- DRUM WITH STEADY BURNING LIGHT
- TEMPORARY TRAFFIC SIGNAL W/BACKPLATE DIRECTION AS INDICATED
- TYPE III BARRICADE (PLACE WHEN NO WORK IS BEING PERFORMED)
- TEMPORARY CONCRETE BARRIER
- TRAFFIC SIGNAL WITH SIGNAL DIRECTION ON BACK PLATE & MICROWAVE DETECTOR DIRECTION AS INDICATED

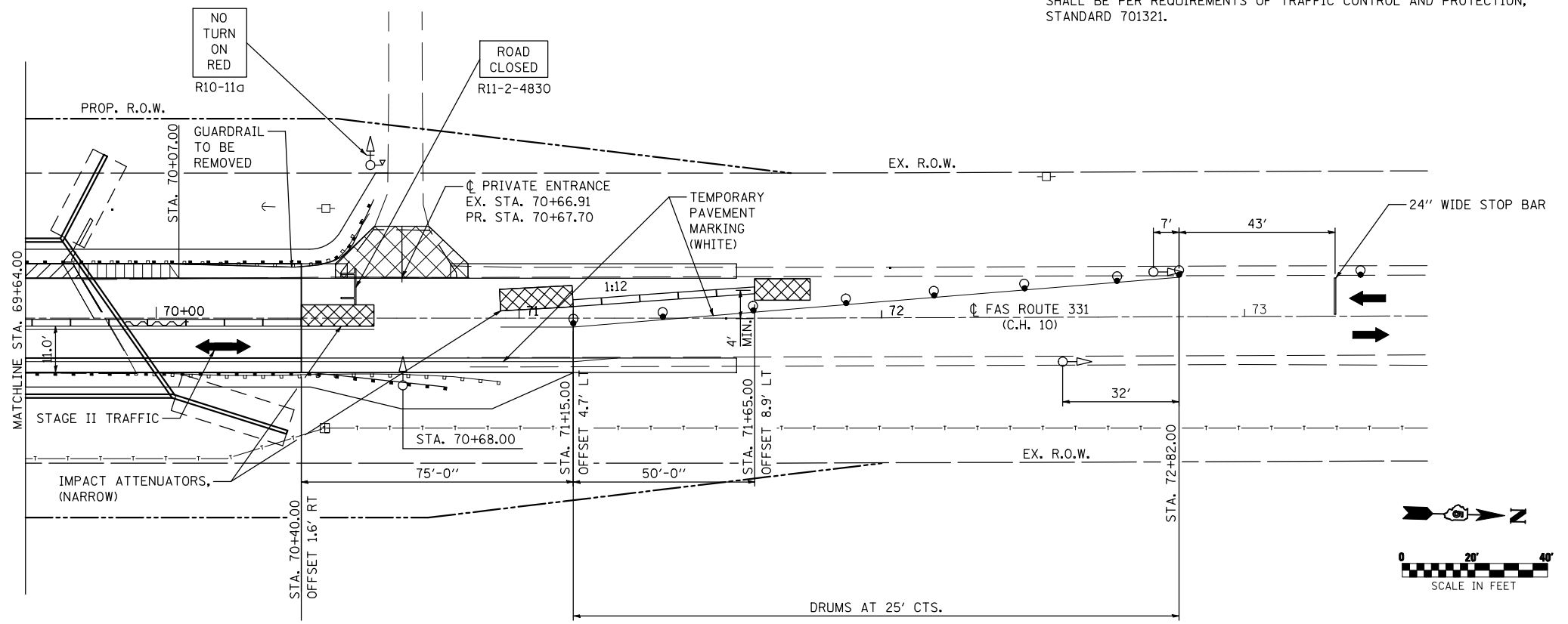

STAGE II PLAN VIEW

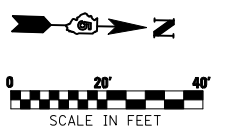

| | | | | | | | | | | | | |
|--------------------------------------|-----------------|----------------|-----------|---|---------------------------------|-------------------------|--------------------------------|--------------------|--------------------|------------------|-----------------|--------------|
| FILE NAME = D570434-010-STAGING2.dgn | USER NAME = RNH | DESIGNED - JMH | REVISED - | STATE OF ILLINOIS DEPARTMENT OF TRANSPORTATION | STAGE II TRAFFIC CONTROL | | | F.A.S. RTE. 331 | SECTION (79-102)BR | COUNTY VERMILION | TOTAL SHEETS 29 | SHEET NO. 10 |
| | | DRAWN - RNH | REVISED - | | SCALE: 1"=20' | SHEET NO. 2 OF 2 SHEETS | STA. 66+63.00 TO STA. 72+82.00 | CONTRACT NO. 70434 | | | | |
| | | CHECKED - TMM | REVISED - | | ILLINOIS FED. AID PROJECT | | | | | | | |
| | | DATE - | REVISED - | | | | | | | | | |

McDonough-Whitlow, P.C.
Consulting Engineers & Land Surveyors
 138 East Wood Street
 Hillsboro, IL 62049
 Phone: 217.532.9233
 Fax: 217.532.6300